

P:\AA - Projects\Project Folders\proj_1401-1500\PE_1455\D_RWBC Drawings\EL-12334\EL-12334.6-10.dwg, D-2

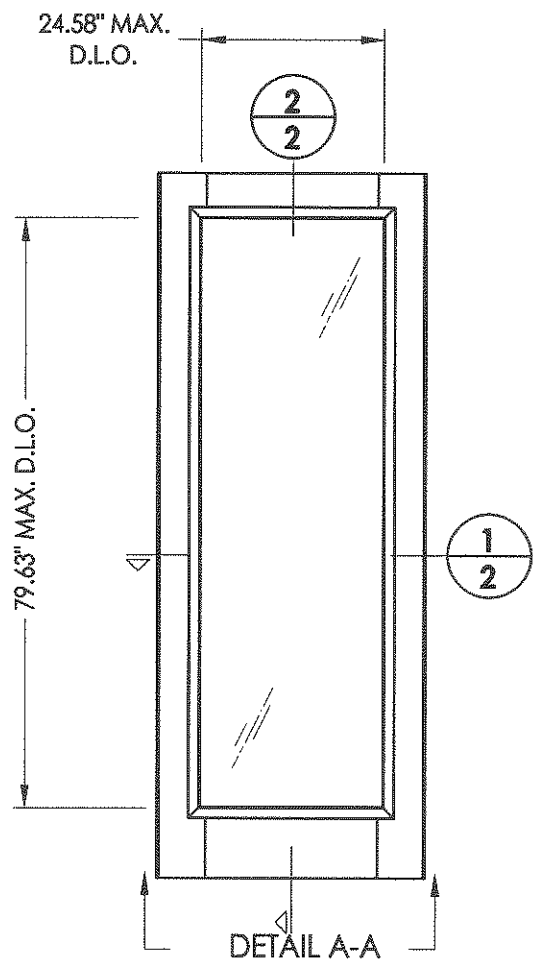

40 DOOR PANEL
Smooth Star

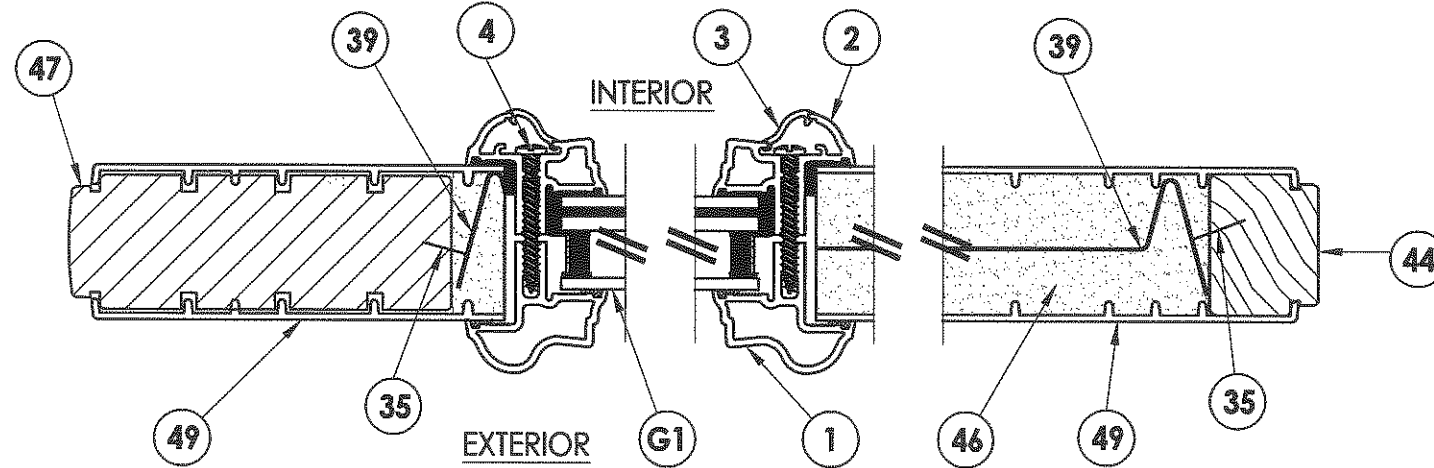

1
2 HORIZONTAL CROSS SECTION

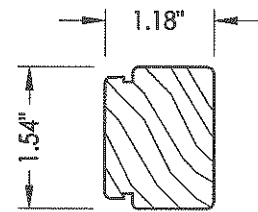

44 HINGE STILE

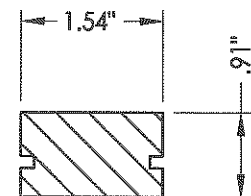

48 TOP RAIL

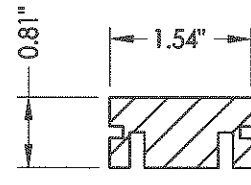

45 BOTTOM RAIL

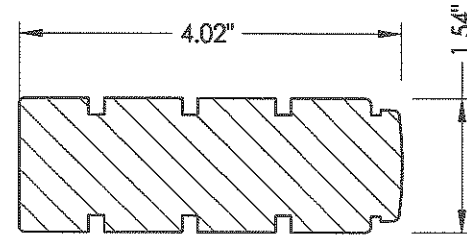

47 LOCK STILE

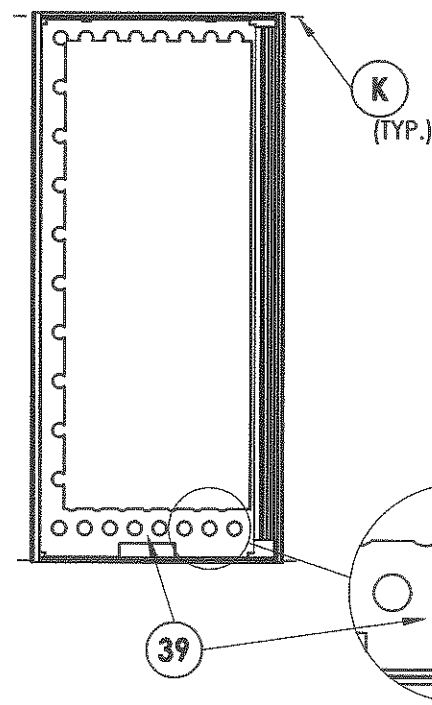

DETAIL A-A
Panel reinforcement

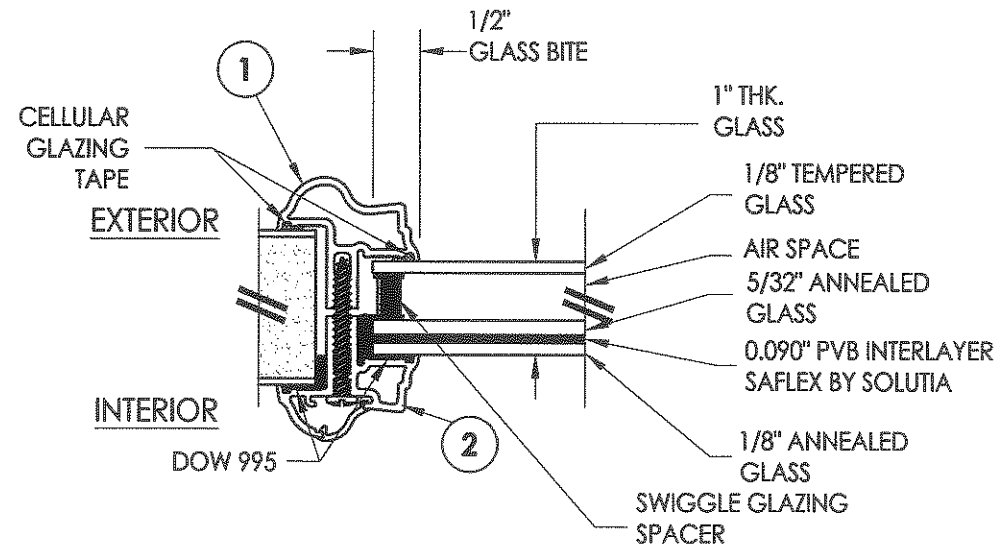

G1 GLAZING DETAIL

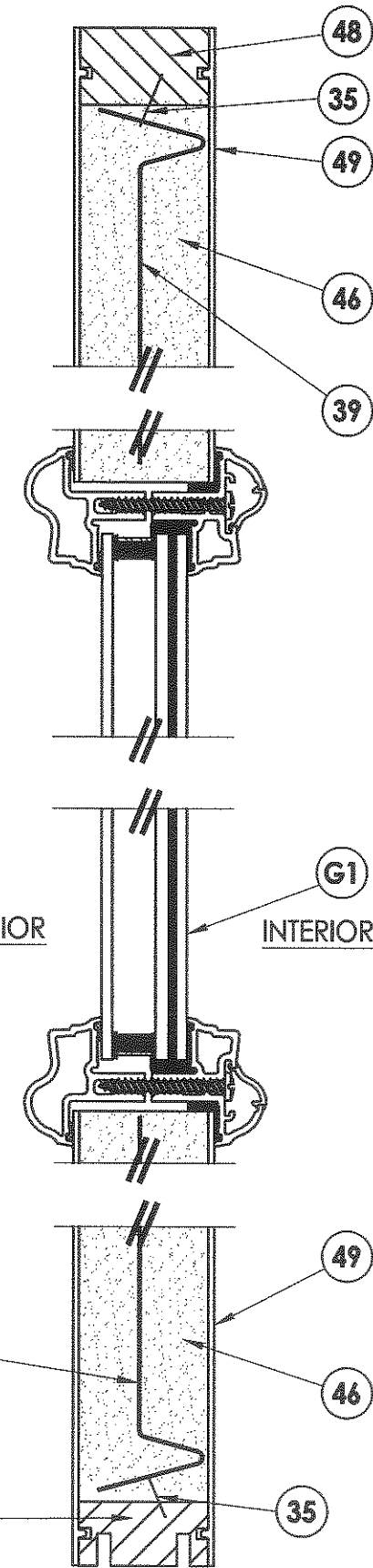

2
2 VERTICAL CROSS SECTION

Documents Prepared By:

RW BUILDING CONSULTANTS, INC.
P.O. Box 230 Valrico FL 33595
Phone No.: 813.659.9197
Florida Board of Professional Engineers
Certificate Of Authorization No. 9813
3.17.11
Lyndon F. Schmidt, P.E. No. 43409

PRODUCT:
THERMA TRU
FIBERGLASS GLAZED DOOR

PART OR ASSEMBLY:
DOOR PANEL DETAILS & GLAZING
DETAILS (SMOOTH STAR)

REVISIONS	
NO.	DATE
1	3/9/11
JK	BY
JK	BY

DATE: 2/26/09

SCALE: N.T.S.

DWG. BY: JK

CHK. BY: LFS

DRAWING NO.:

FL-12334.9

SHEET 2 OF 11

R:\A - Projects\Project Folders\pmj.1401-1500\PE 1455\D. RWBC Drawings\FL-12334\EL-12334.6-10.dwg, D-4

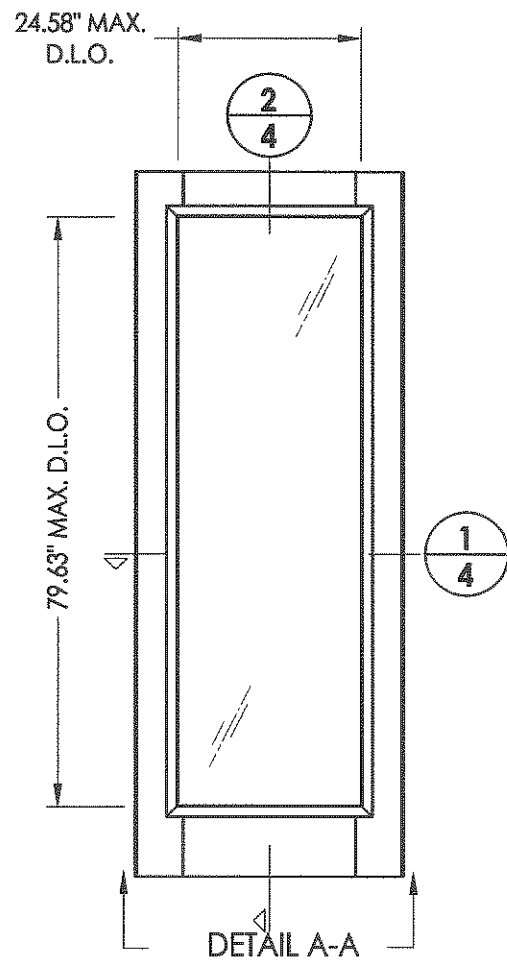

60 DOOR PANEL
Classic Craft

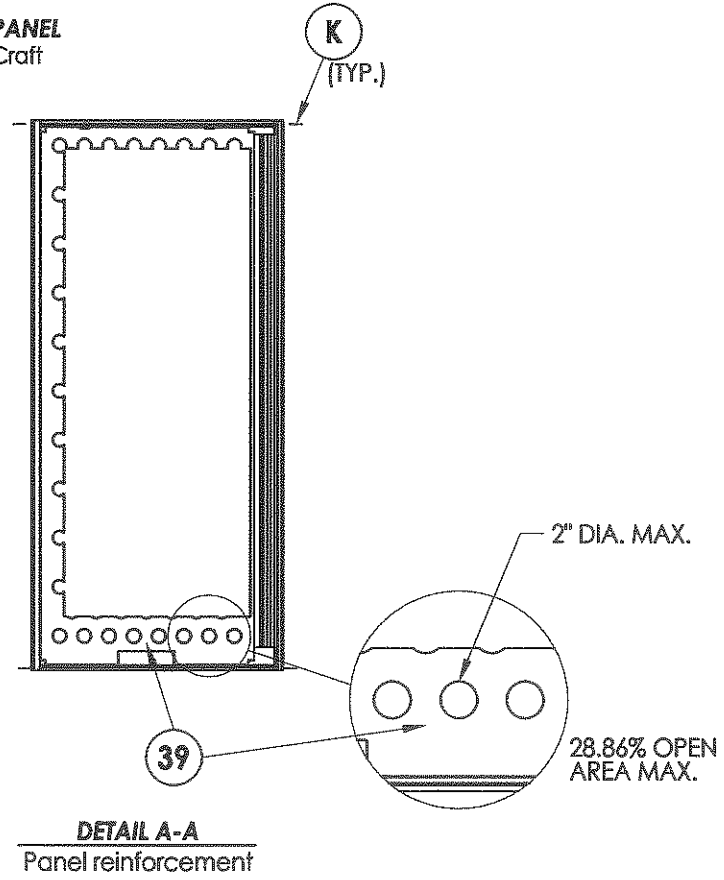

DETAIL A-A
Panel reinforcement

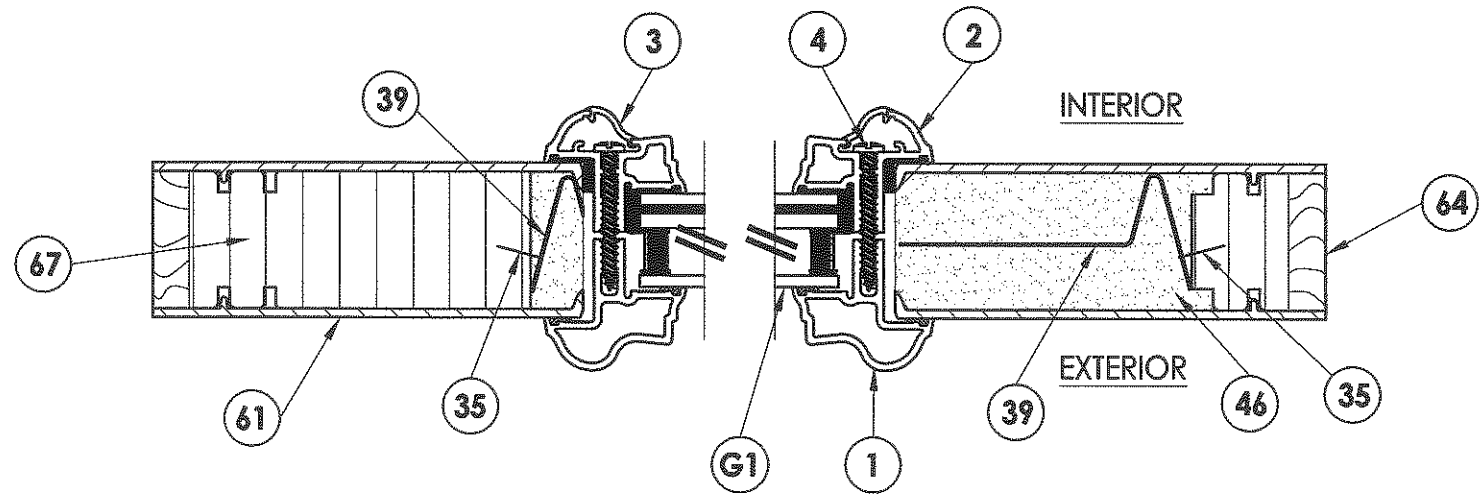

1
4 HORIZONTAL CROSS SECTION

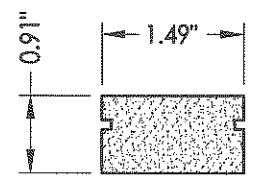

62 TOP RAIL

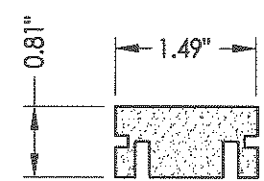

65 BOTTOM RAIL

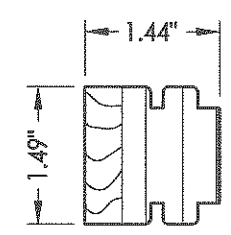

64 HINGE STILE

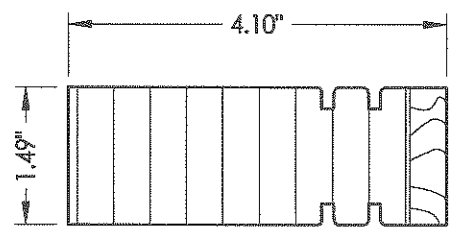

67 LOCK STILE

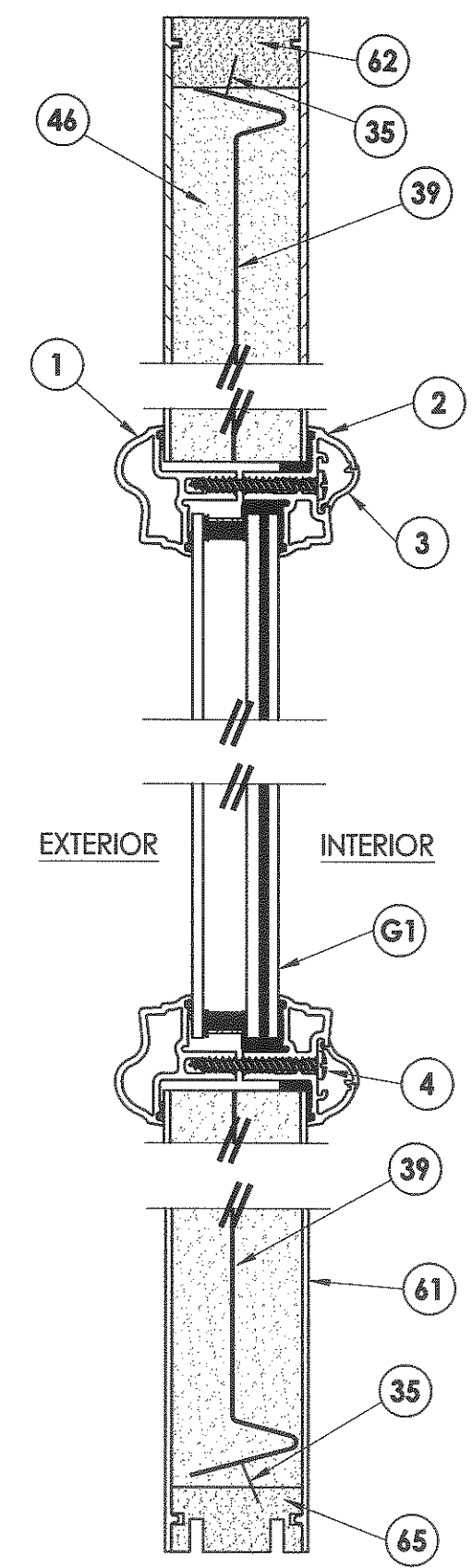

2
4 VERTICAL CROSS SECTION

Documents Prepared By:
RW BUILDING CONSULTANTS, INC.
 P.O. Box 230 Valrico FL 33595
 Phone No.: 813.659.9197
 Florida Board of Professional Engineers
 Certificate Of Authorization No. 9813
 Lyndon F. Schmidt, P.E. No. 43409

PRODUCT:	THERMA-TRU FIBERGLASS GLAZED DOOR
PART OR ASSEMBLY:	DOOR PANEL DETAILS (CLASSIC CRAFT)
NO.	1
DATE	3/9/11
REVISIONS	REVISE CLASSIC CRAFT DOOR
BY	JK

DATE: 2/26/09
 SCALE: N.T.S.
 DWG. BY: JK
 CHK. BY: LFS
 DRAWING NO.: FL-12334.9
 SHEET 4 OF 11

© 2009 R.W. BUILDING CONSULTANTS INC.

R:\A - Projects\Project_Folders\proj_1401-1500\PE_1455\D_R\WBC_Drawings\EL-12334\EL-12334-6-10.dwg_D-5

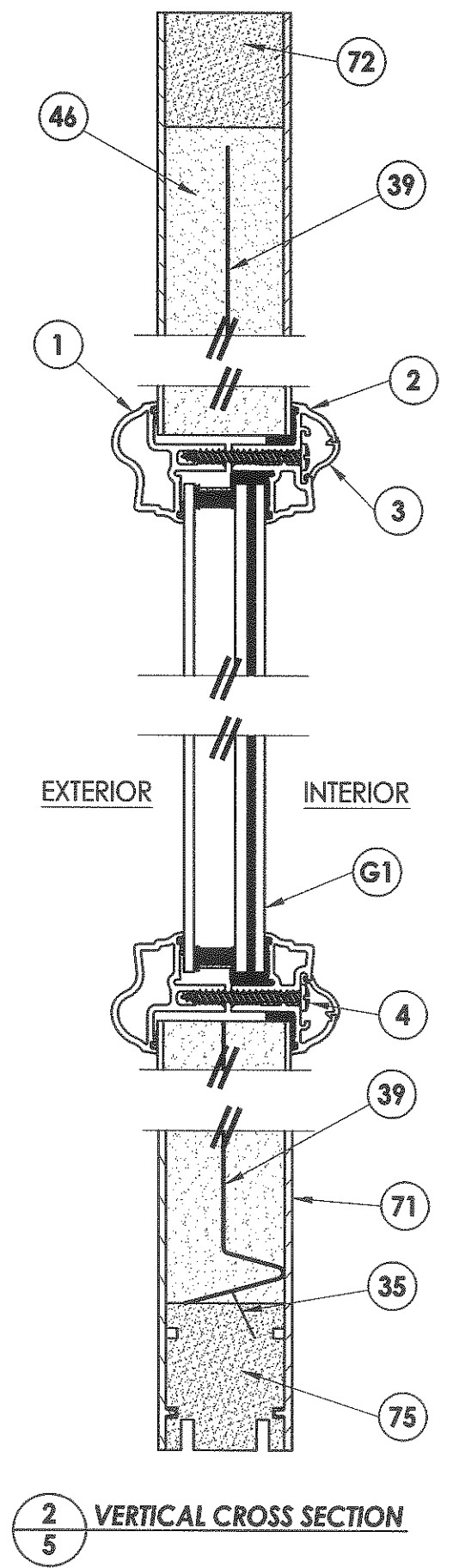
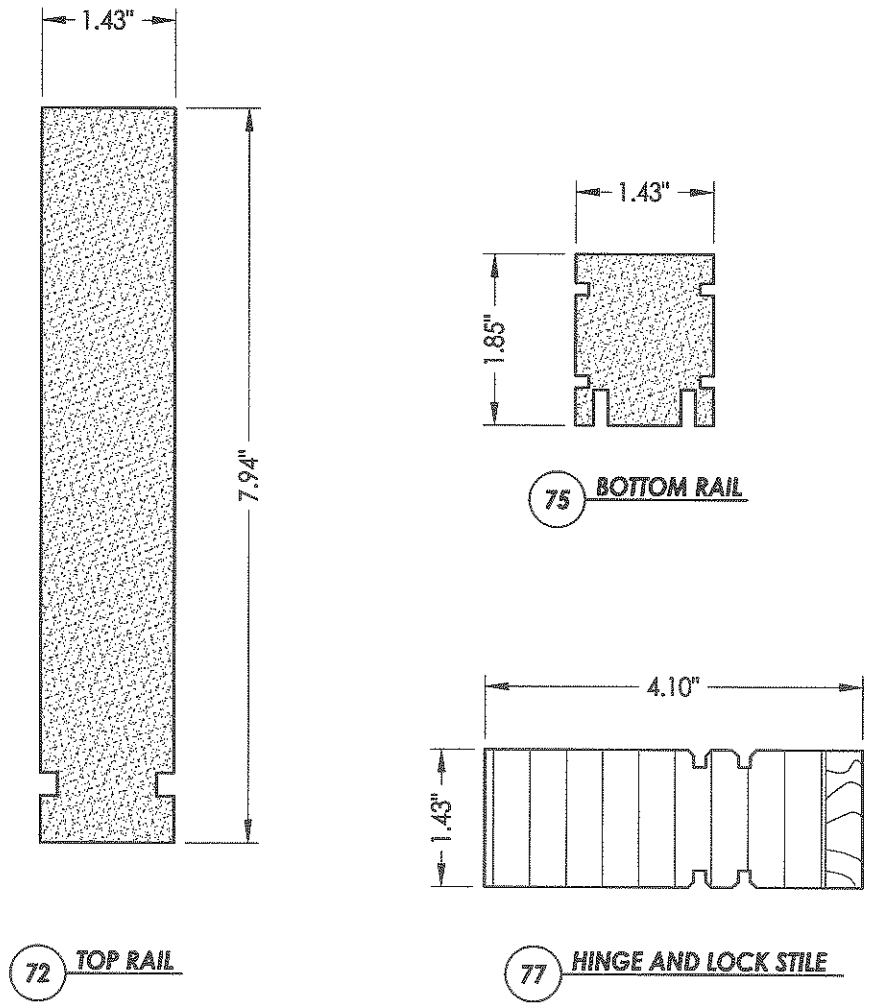
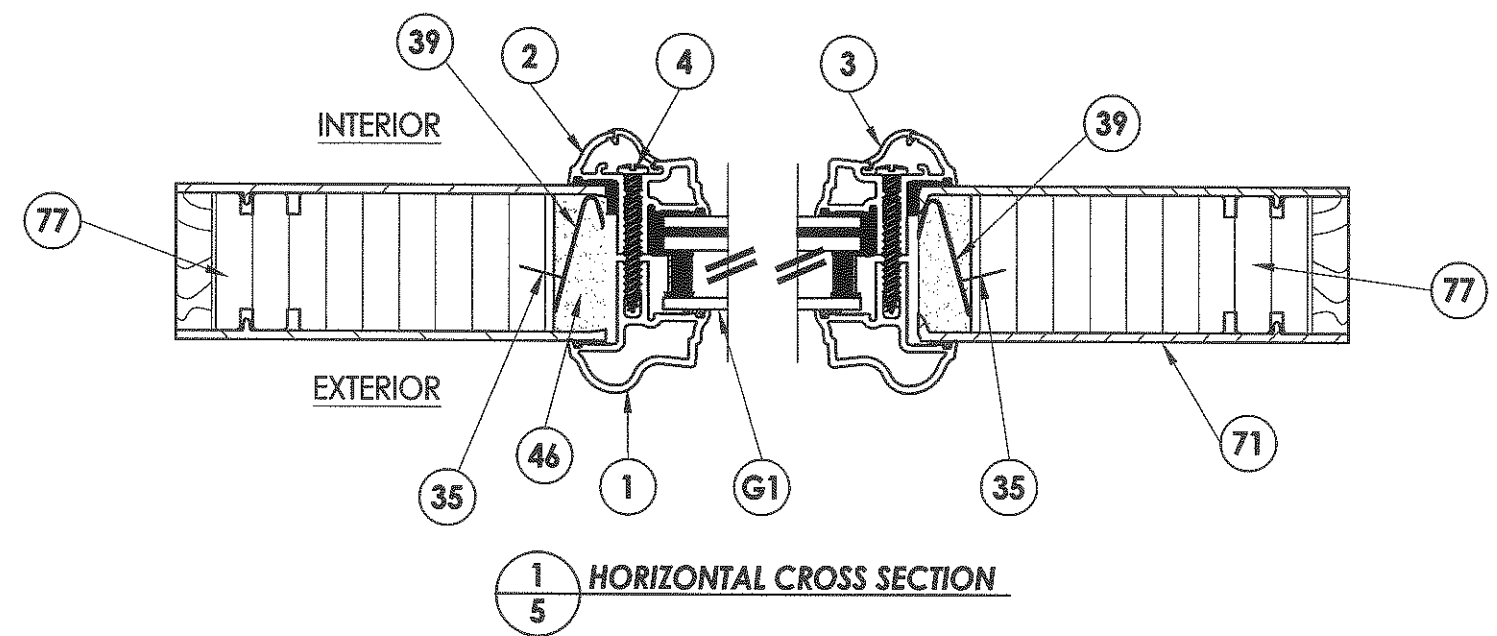
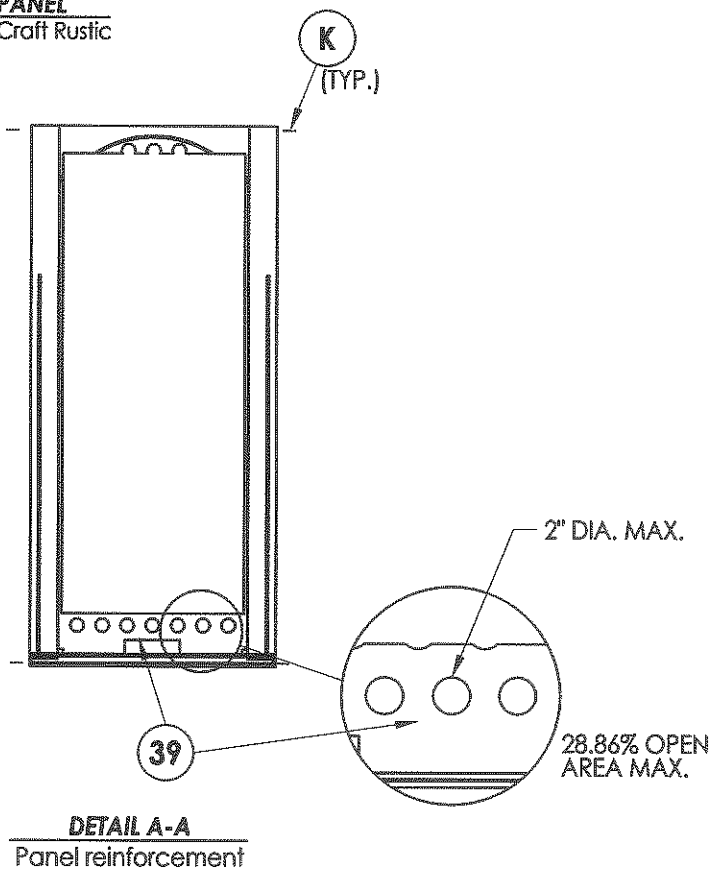
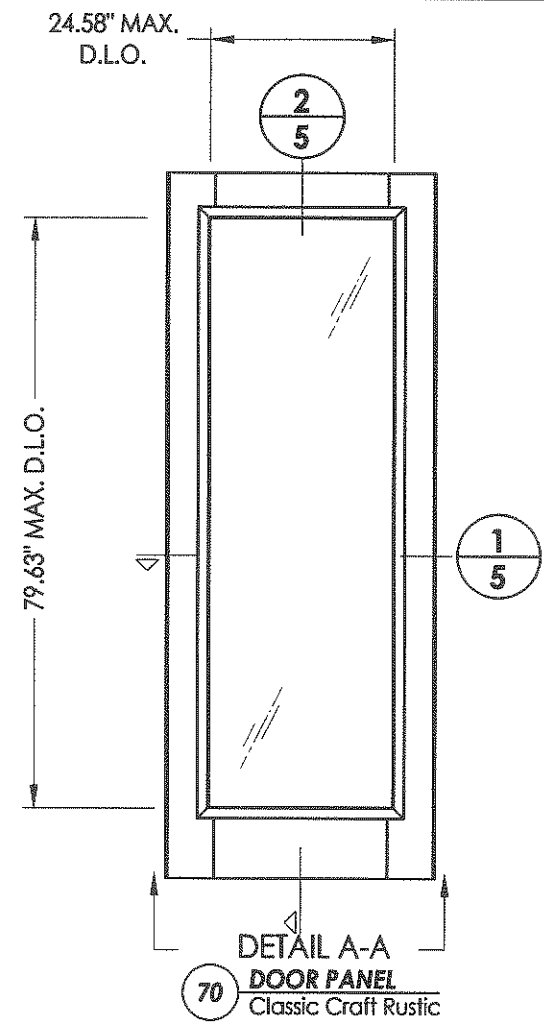

Documents Prepared By:		BUILDING CONSULTANTS, INC. P.O. Box 230 Valrico FL 33595 Phone No.: 813.659.9197 Florida Board of Professional Engineers Certificate Of Authorization No. 9813 Lyndon F. Schmidt, P.E. No. 43409	
PRODUCT:	THERMA-TRU FIBERGLASS GLAZED DOOR		
PART OR ASSEMBLY:	DOOR PANEL DETAILS (CLASSIC CRAFT RUSTIC)		
		JK	BY
		1	3/9/11
		NO.	DATE
		REVISIONS	
DATE:	2/26/09		
SCALE:	N.T.S.		
DWG. BY:	JK		
CHK. BY:	LFS		
DRAWING NO.:	FL-12334.9		
SHEET	5	OF 11	

R:\A - Projects\Project_Eolders\proj_1401-1500\PE_1455\ID_RWBC_Drawings\FL-12334\FL-12334-6-10.dwg_D-6

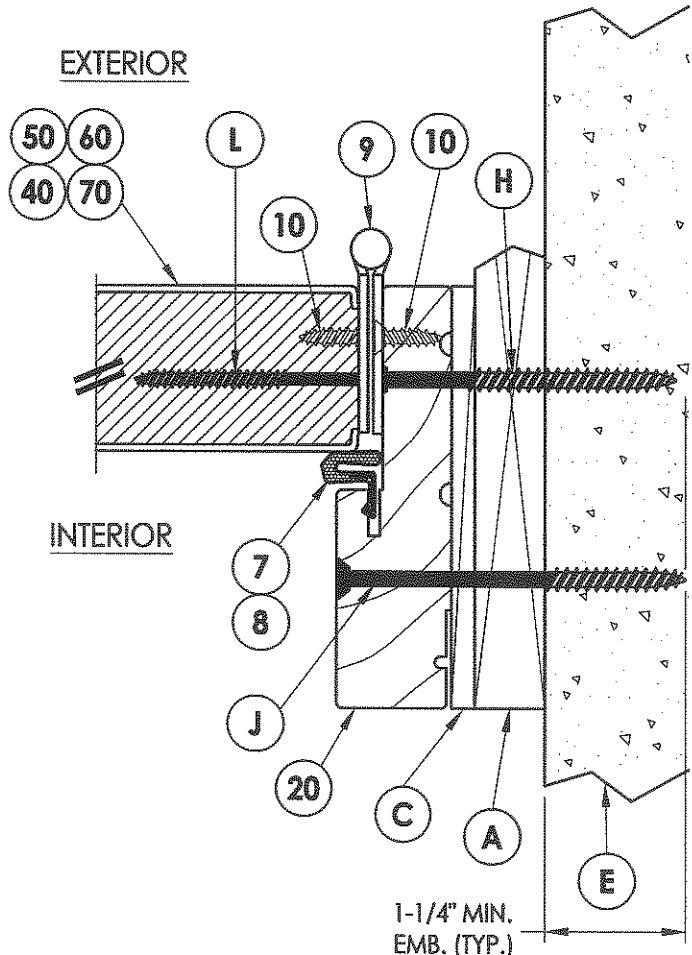
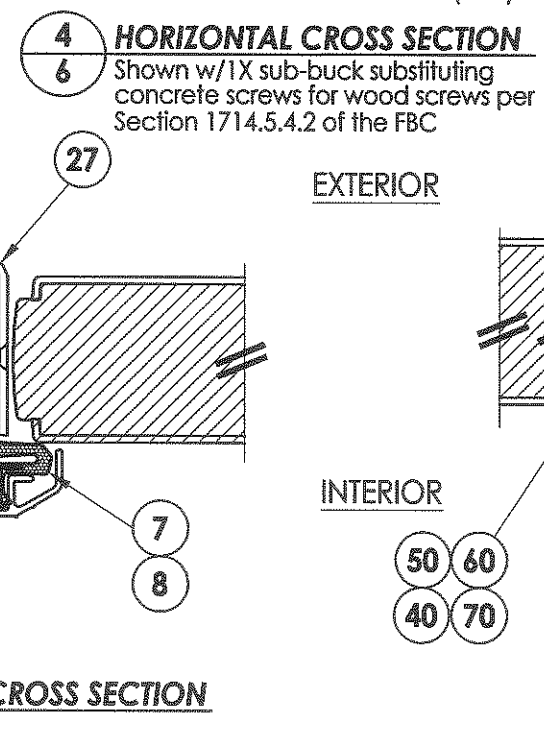
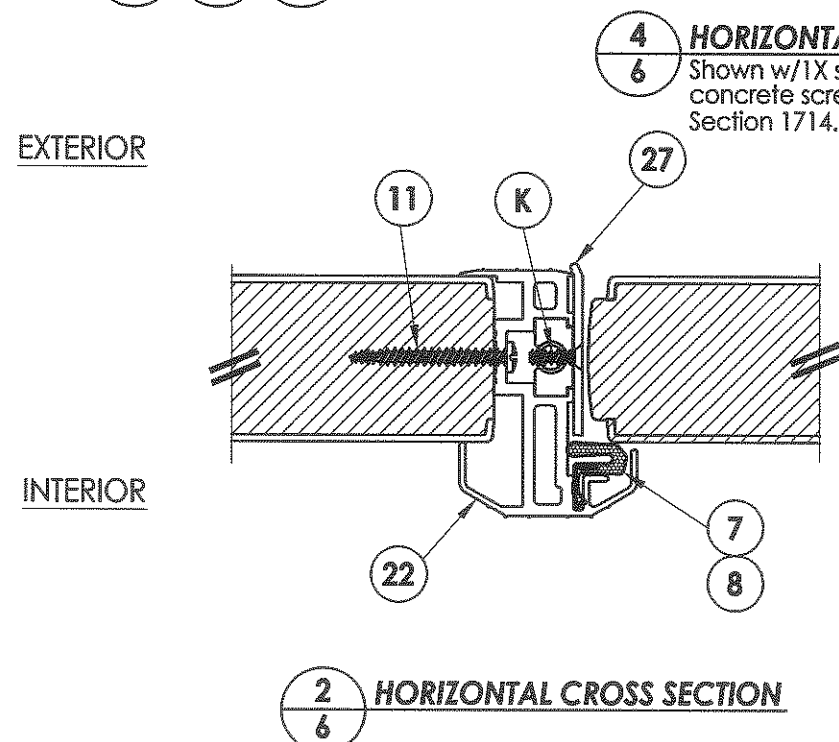
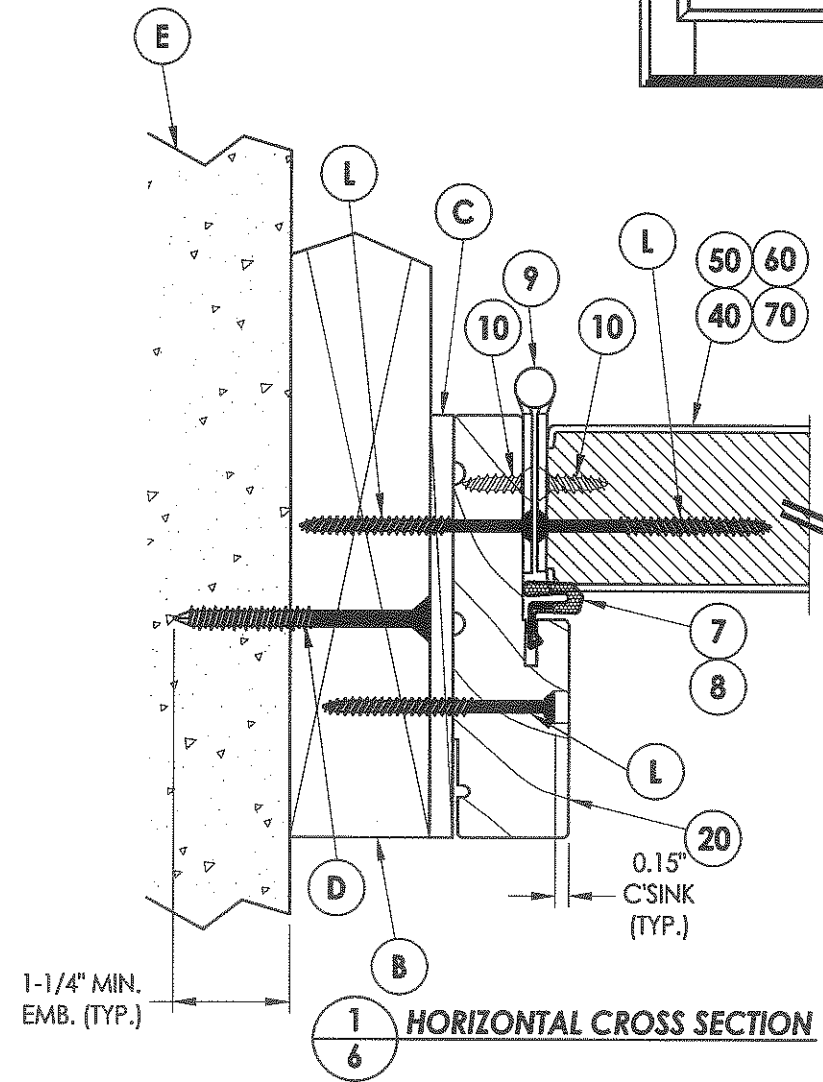

Shown w/1X sub-buck substituting concrete screws for wood screws per Section 1714.5.4.2 of the FBC

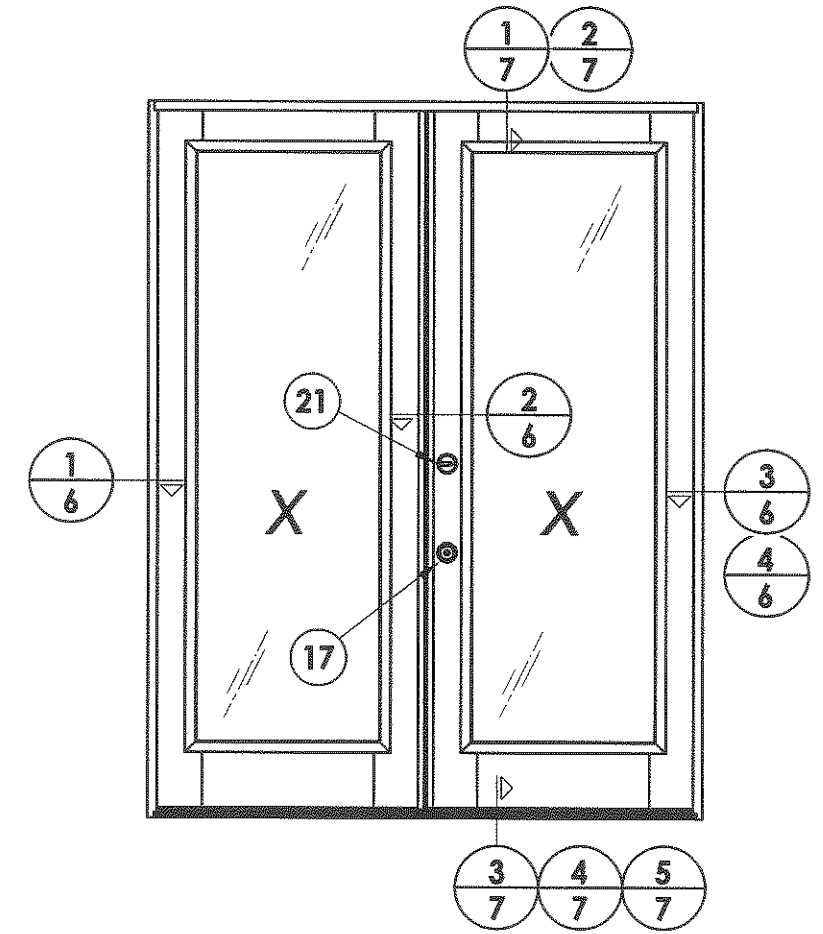

Documents Prepared By:		R.W. BUILDING CONSULTANTS, INC. P.O. Box 230 Valrico FL 33595 Phone No.: 813.659.9197	
PRODUCT:		THERMA TRU FIBERGLASS GLAZED DOOR	
PART OR ASSEMBLY:		HORIZONTAL CROSS SECTIONS	
NO. DATE		JK BY	
1 3/9/11		REVISE CLASSIC CRAFT DOOR	
DATE		2/26/09	
SCALE:		N.T.S.	
DWG. BY:		JK	
CHK. BY:		LFS	
DRAWING NO.:		FL-12334.9	
SHEET		6 OF 11	

Florida Board of Professional Engineers
Certificate of Authorization No. 9813
3.17.11
Lyndon F. Schmidt, P.E. No. 43409

R:\A - Projects\Project_Folders\proj_1401-1500\PE_1455\D_RWB\Drawings\FL-12334\FL-12334.6-10.dwg_D-7

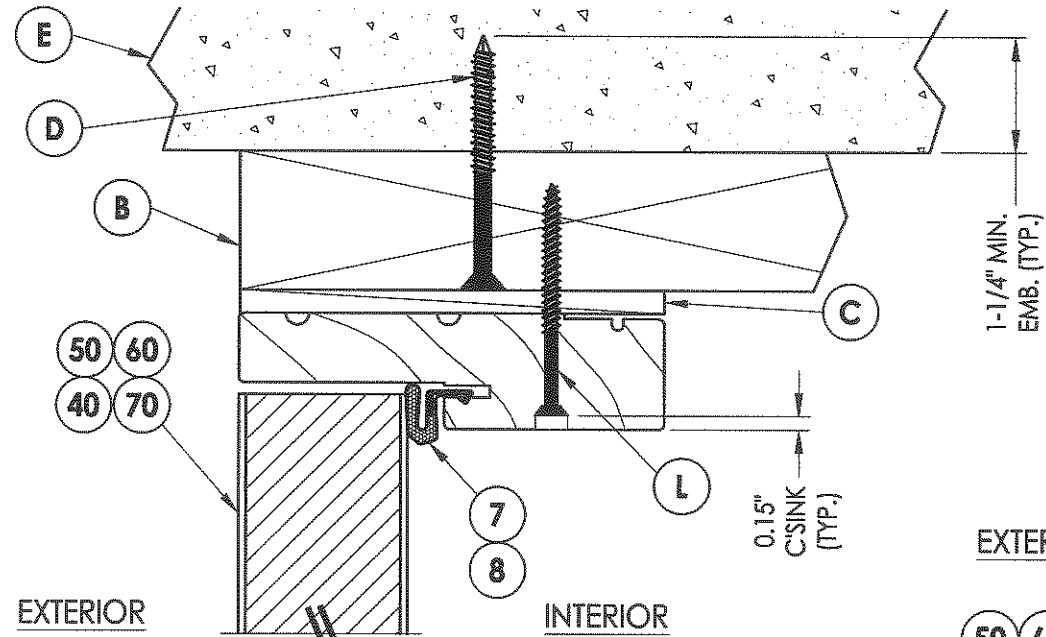

1
7 VERTICAL CROSS SECTION

EXTERIOR INTERIOR

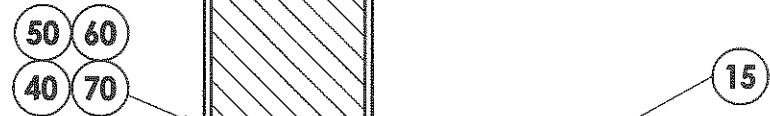

2
7 VERTICAL CROSS SECTION
Shown w/1X sub-buck substituting concrete screws for wood screws per Section 1714.5.4.2 of the FBC

EXTERIOR INTERIOR

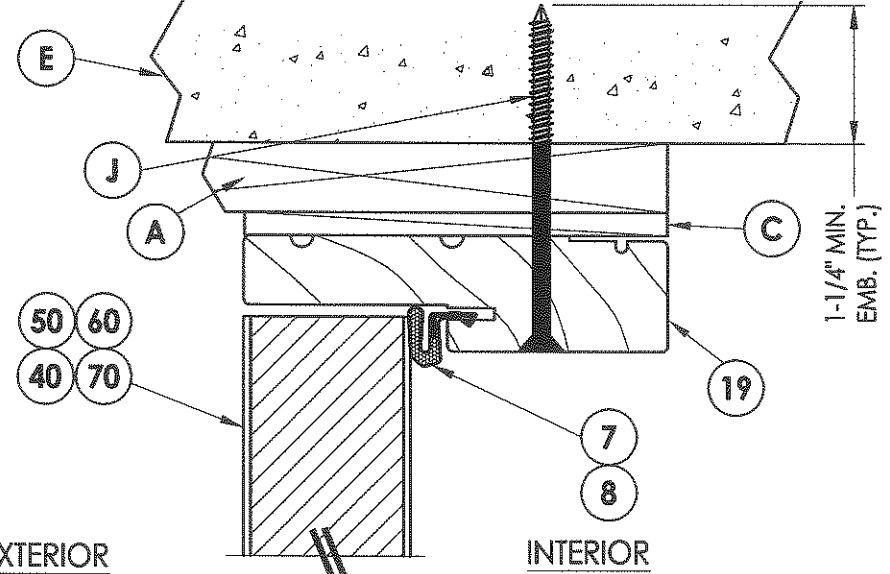

3
7 VERTICAL CROSS SECTION
Outswing configuration see general notes, sheet 1 for "HVHZ" water infiltration requirements

EXTERIOR INTERIOR

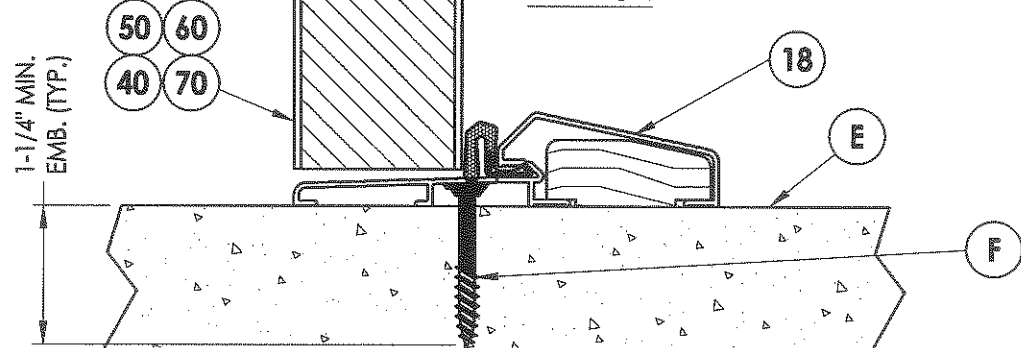

5
7 VERTICAL CROSS SECTION
Outswing configuration see general notes, sheet 1 for "HVHZ" water infiltration requirements

EXTERIOR INTERIOR

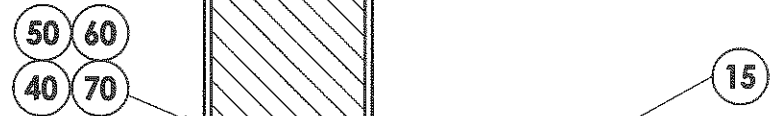

4
7 VERTICAL CROSS SECTION
Outswing configuration see general notes, sheet 1 for "HVHZ" water infiltration requirements

EXTERIOR INTERIOR

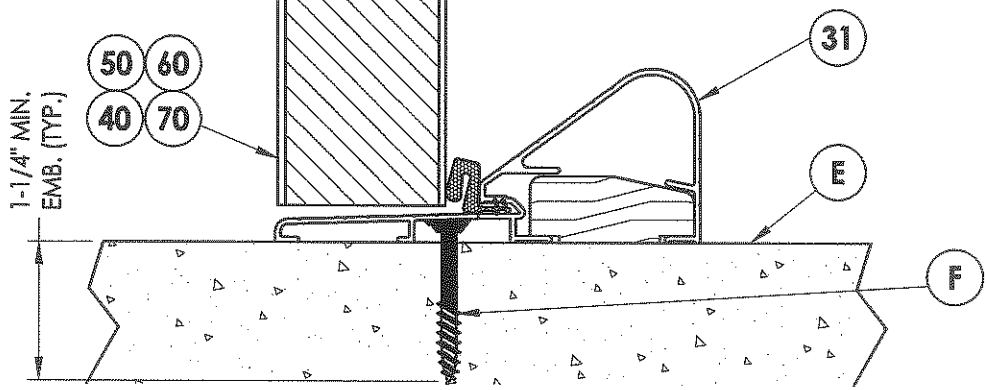

Documents Prepared By:
RW BUILDING CONSULTANTS, INC.
 P.O. Box 230 Valrico FL, 33595
 Phone No.: 813.659.9197
 Florida Board of Professional Engineers
 Certificate Of Authorization No. 9813
 Lyndon F. Schmidt, P.E. No. 43409

PRODUCT: THERMA TRU FIBERGLASS GLAZED DOOR
 PART OR ASSEMBLY: VERTICAL CROSS SECTIONS

NO.	DATE	BY	REVISIONS
1	3/9/11	JK	REVISE CLASSIC CRAFT DOOR

DATE: 2/26/09
 SCALE: N.T.S.
 DWG. BY: JK
 CHK. BY: LFS
 DRAWING NO.: FL-12334.9
 SHEET 7 OF 11

R:\A-Projects\Project_Folders\proj_1401-1500\PE_1455\ID_RWFC_Drawings\FL-12334\FL-12334-6-10.dwg_D-8

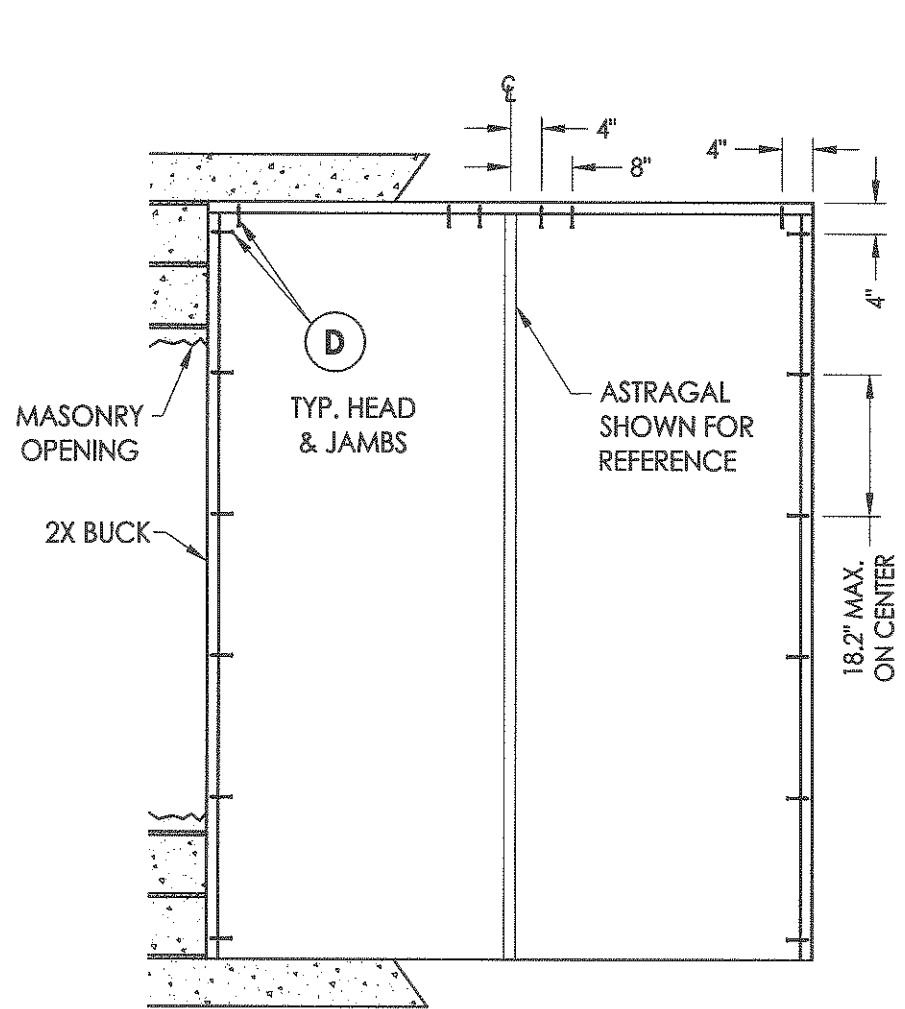

BUCK ANCHORING

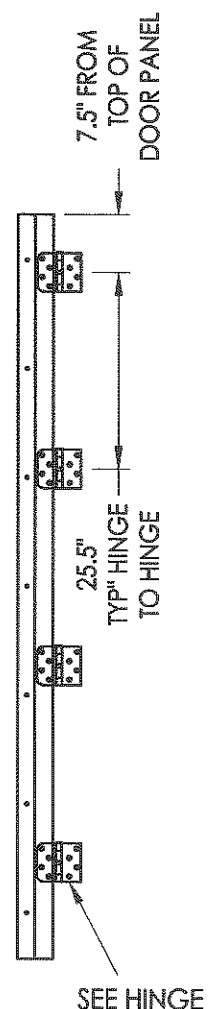

HINGE JAMB

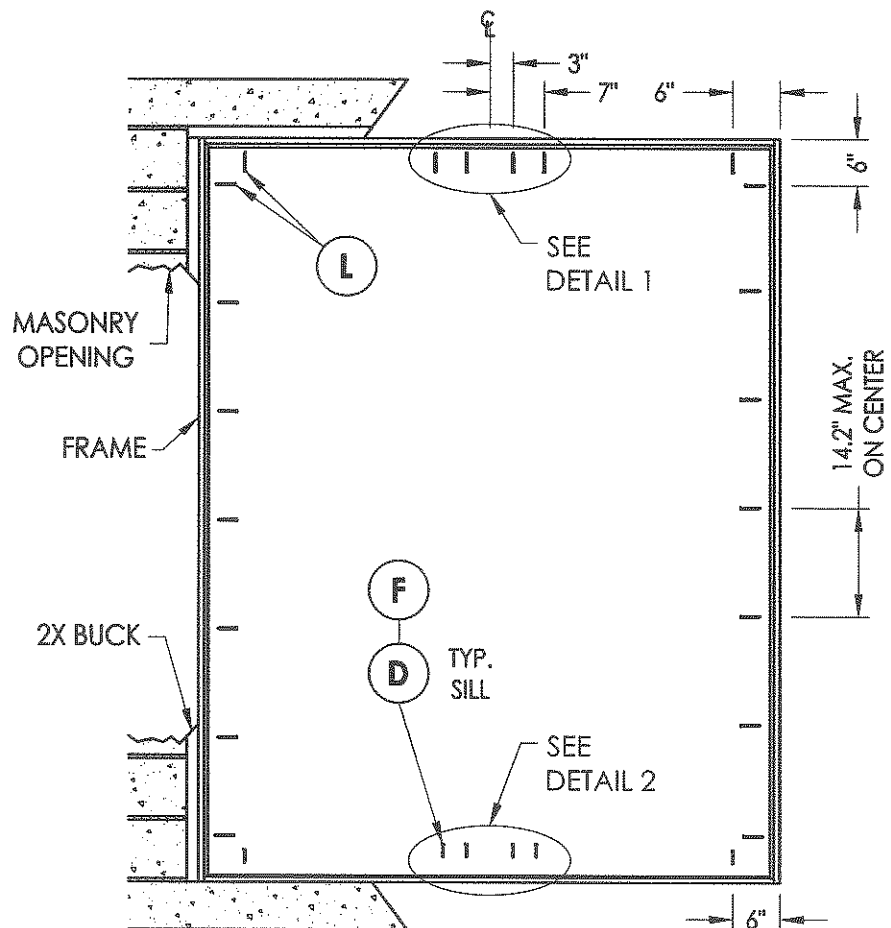

FRAME ANCHORING
Masonry 2X buck construction

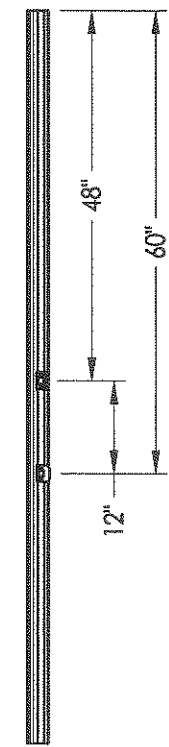

ASTRAGAL STRIKE JAMB

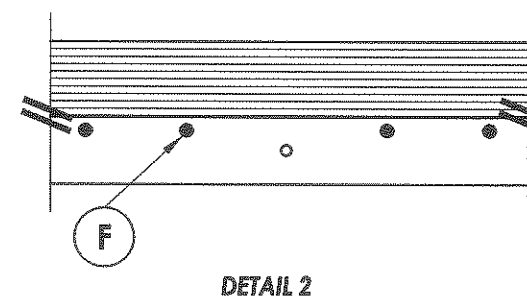
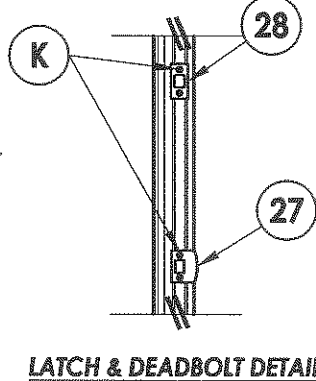
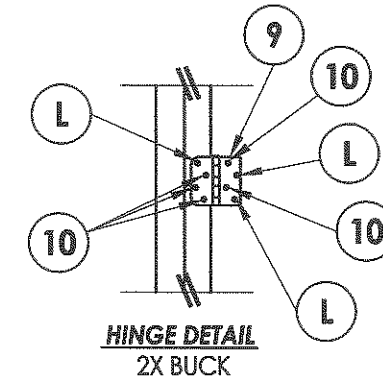

DETAIL 2

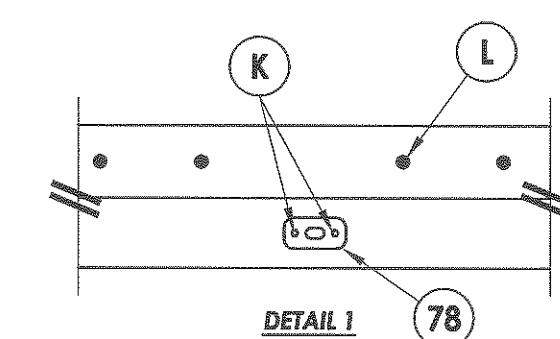

DETAIL 1

CONCRETE ANCHOR NOTES:

1. Substitution of equal concrete anchors from a different supplier may have different edge distance and center distance requirements.
2. Concrete anchor locations at the corners may be adjusted to maintain the min. edge distance to mortar joints. Concrete anchor locations noted as "MAX. ON CENTER" must be adjusted to maintain the min. edge distance to mortar joints, additional concrete anchors may be required to ensure the "MAX. ON CENTER" dimension are not exceeded.
3. Concrete anchor table:

ANCHOR TYPE	ANCHOR SIZE	MIN. EMBEDMENT	MIN. CLEARANCE TO MASONRY EDGE	MIN. CLEARANCE TO ADJACENT ANCHOR
ITW	1/4"	1-1/4"	2-1/2"	3"
ELCO	1/4"	1-1/4"	1"	4"
ITW	3/16"	1-1/4"	2-5/8"	2-1/4"

Documents Prepared By:

RW BUILDING CONSULTANTS, INC.
P.O. Box 230 Valrico FL 33595
Phone No.: 813.659.9197
Florida Board of Professional Engineers
Certificate Of Authorization No. 9813
Lyndon F. Schmidt, P.E. No. 43409

PRODUCT: THERMA TRU FIBERGLASS GLAZED DOOR
PART OR ASSEMBLY: BUCK & FRAME ANCHORING 2X BUCK MASONRY CONSTRUCTION

NO.	DATE	REVISIONS
1	3/9/11	REVISE CLASSIC CRAFT DOOR
JK		
BY		

DATE: 2/26/09
SCALE: N.T.S.
DWG. BY: JK
CHK. BY: LFS
DRAWING NO.: FL-12334.9
SHEET 8 of 11

R:\A - Projects\Project Folders\proj_1401-1500\PE 1455\D_R\WBC Drawings\FL-12334\FL-12334.6-10.dwg_D-9

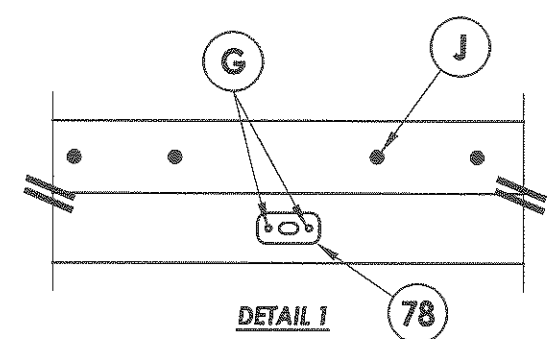
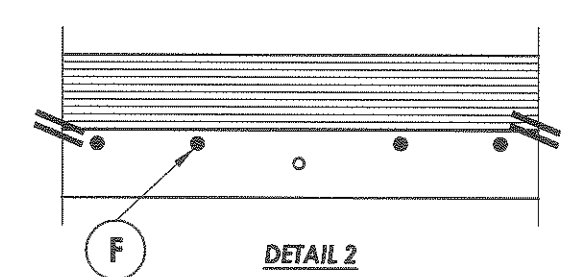
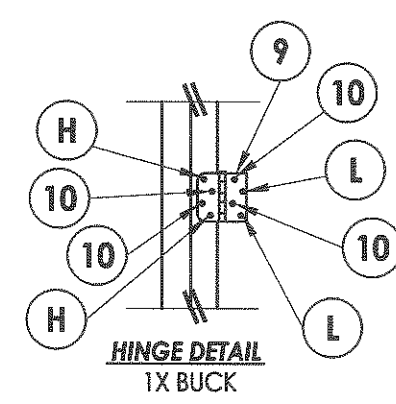
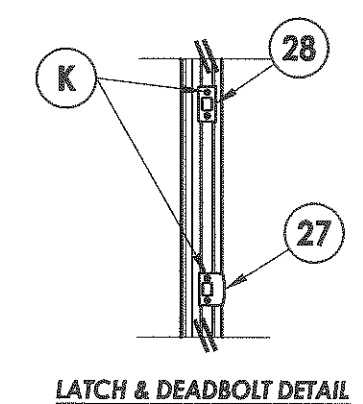
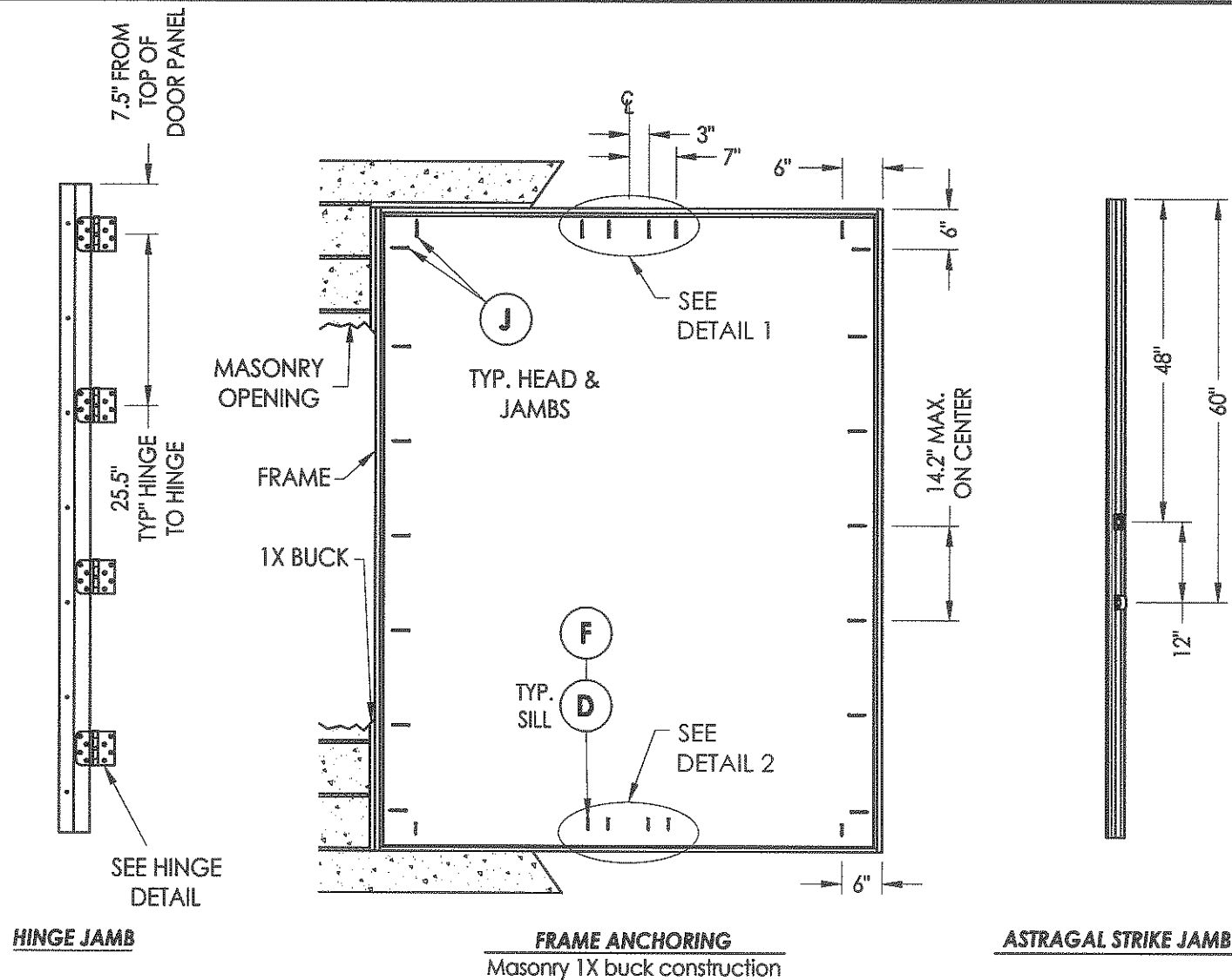

- CONCRETE ANCHOR NOTES:**
1. Substitution of equal concrete anchors from a different supplier may have different edge distance and center distance requirements.
 2. Concrete anchor locations at the corners may be adjusted to maintain the min. edge distance to mortar joints. Concrete anchor locations noted as "MAX. ON CENTER" must be adjusted to maintain the min. edge distance to mortar joints, additional concrete anchors may be required to ensure the "MAX. ON CENTER" dimension are not exceeded.
 3. Concrete anchor table:

ANCHOR TYPE	ANCHOR SIZE	MIN. EMBEDMENT	MIN. CLEARANCE TO MASONRY EDGE	MIN. CLEARANCE TO ADJACENT ANCHOR
ITW	1/4"	1-1/4"	2-1/2"	3"
ELCO	1/4"	1-1/4"	1"	4"
ITW	3/16"	1-1/4"	2-5/8"	2-1/4"

Documents Prepared By:
RW BUILDING CONSULTANTS, INC.
 P.O. Box 230 Valrico FL 33595
 Phone No.: 813.659.9197
 Florida Board of Professional Engineers
 Certificate Of Authorization No. 9813
LF
 Lyndon F. Schmidt, P.E. No. 43409

PRODUCT: THERMA TRU FIBERGLASS GLAZED DOOR

PART OR ASSEMBLY: FRAME ANCHORING 1X BUCK MASONRY CONSTRUCTION

NO.	DATE	REVISIONS
1	3/9/11	REVISE CLASSIC CRAFT DOOR
		JK
		BY

DATE: 2/26/09
 SCALE: N.T.S.
 DWG. BY: JK
 CHK. BY: LFS
 DRAWING NO.: FL-12334.9
 SHEET 9 OF 11

© 2009 R.W. BUILDING CONSULTANTS INC.

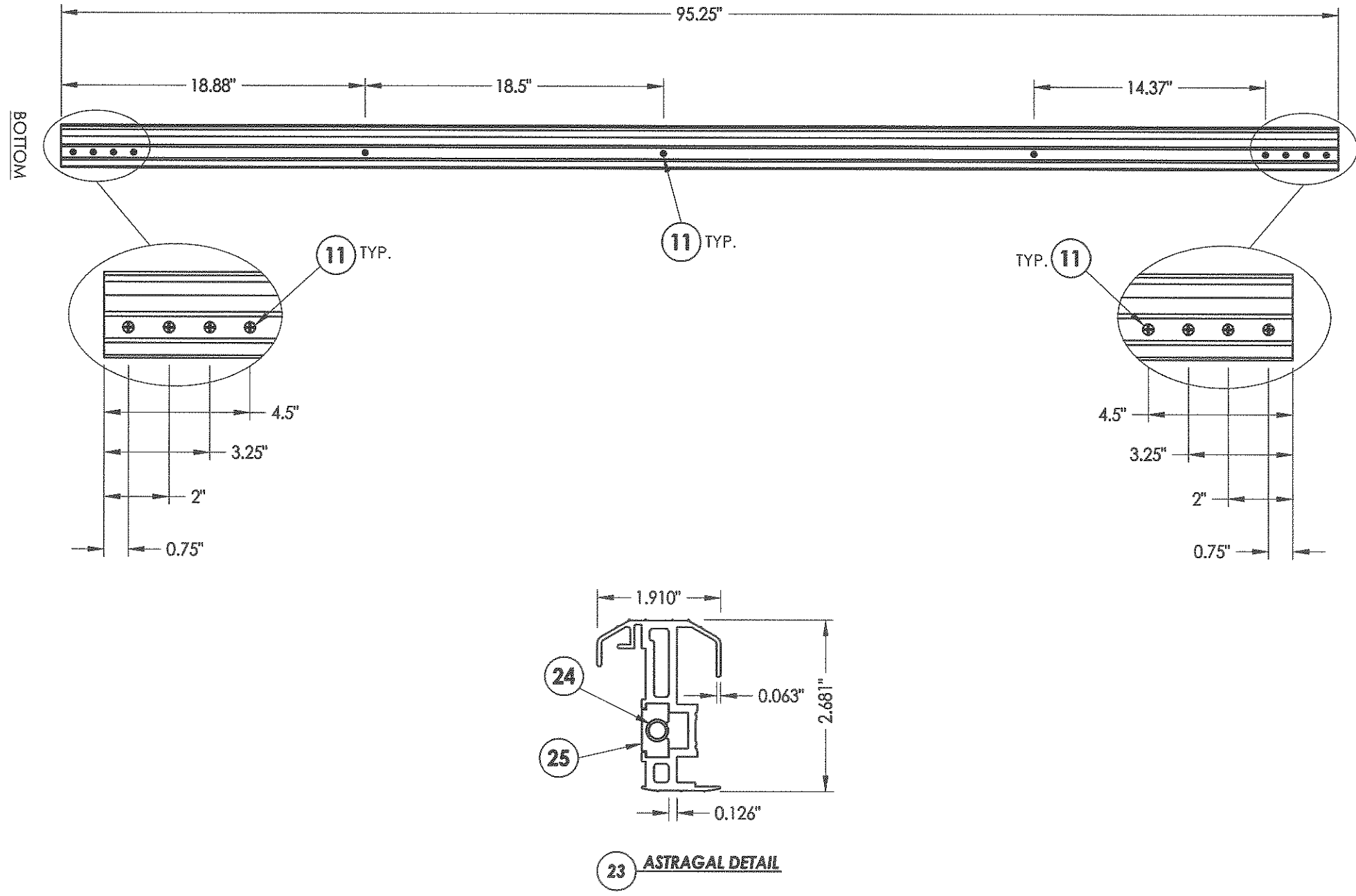

DATE: 2/26/09
 SCALE: N.T.S.
 DWG. BY: JK
 CHK. BY: LFS
 DRAWING NO.: FL-12334.9
 SHEET 10 OF 11

PRODUCT:	THERMA TRU FIBERGLASS GLAZED DOOR				
PART OR ASSEMBLY:	COMPONENTS				
NO.	DATE	REVISE	CLASSIC CRAFT DOOR	JK	BY
1	3/9/11				

Documents Prepared By:
RW BUILDING CONSULTANTS, INC.
 P.O. Box 230 Valrico FL 33595
 Phone No.: 813.659.9197
 Florida Board of Professional Engineers
 Certificate Of Authorization No. 9813
 Lyndon F. Schmidt, P.E. No. 43409

R:\A - Projects\Project Folders\proj_1401-1500\PE 1455\D_R\WBC Drawings\FL-12334\EL-12334-6-10.dwg_D-11

BILL OF MATERIALS		
ITEM	DESCRIPTION	MATERIAL
A	1X BUCK SG >= 0.55	WOOD
B	2X BUCK SG >= 0.55	WOOD
C	MAX. 1/4" SHIM SPACE	-
D	1/4" X 2-3/4" PFH ELCO OR ITW CONCRETE SCREW	STEEL
E	MASONRY - 3,192 PSI MIN. CONCRETE CONFORMING TO ACI 301 OR HOLLOW BLOCK CONFORMING TO ASTM C90	CONCRETE
F	1/4" X 1-3/4" PFH ITW CONCRETE SCREW	STEEL
G	3/16" X 3-1/4" PFH ITW CONCRETE SCREW	STEEL
H	1/4" X 3-1/4" PFH ITW CONCRETE SCREW	STEEL
J	1/4" X 3-3/4" PFH ELCO OR ITW CONCRETE SCREW	STEEL
K	#8 X 2-1/2" PFH WOOD SCREW	STEEL
L	#10 X 2-1/2" PFH WOOD SCREW	STEEL
1	EXTERIOR LITE FRAME	ALUM.
2	INTERIOR LITE FRAME	ALUM.
3	LITE FRAME TRIM	PVC
4	#10 X 1-1/2" PFH SM SCREW	STEEL
7	MEDIUM REACH COMPRESSION WEATHER-STRIP	FOAM
8	LONG REACH COMPRESSION WEATHER-STRIP	FOAM
9	4" X 4" HINGE .097" THK.	STEEL
10	#10 X 3/4" PFH WOOD SCREW (HINGE TO FRAME)	STEEL
11	#10 X 1-1/2" PFH SMS	STEEL
12	#10 X 2" PFH WOOD SCREW	STEEL
15	THRESHOLD OUTSWING - 5-3/4" COMPOSITE SILL, FULL SUBSTRATE	ALUM./COMP.
17	PASSAGE LOCK - KWIKSET MODEL 200T - GRADE 2	STEEL
18	THRESHOLD OUTSWING 5-3/4" THERMAL BREAK SILL	ALUM./COMP.
19	HEADER JAMB SG >= 0.42	WOOD
20	SIDE JAMB SG >= 0.42	WOOD
21	KWIKSET DEADBOLT -SERIES 800- GRADE 1	STEEL
23	ASTRAGAL	ALUMINUM
24	ASTRAGAL FLUSH BOLT	STEEL
25	ASTRAGAL FLUSH BOLT RETAINER	ALUMINUM
27	LATCH STRIKE PLATE	STEEL
28	DEADBOLT STRIKE PLATE	STEEL
31	COASTAL OUTSWING THRESHOLD	ALUM./COMP.
32	DOOR BOTTOM SWEEP	PVC
35	7/16" X 1/2" STAPLE	STEEL
37	THRESHOLD OUTSWING	ALUM./COMP.
39	PANEL REINFORCEMENT 0.023" THK.	STEEL
40	FIBERGLASS DOOR PANEL W/STEEL REINFORCEMENT(SMOOTH STAR)	FIBERGLASS
44	HINGE STILE	COMP.
45	BOTTOM RAIL	COMP.
46	INSULATING FOAM CORE	POLYURETHANE
47	LOCK STILE	LVL/WOOD
48	TOP RAIL	COMP.
49	SMOOTHSTAR DOOR SKIN .065" MINIMUM THK. FIBERGLASS	FIBERGLASS

BILL OF MATERIALS		
ITEM	DESCRIPTION	MATERIAL
50	FIBERGLASS DOOR PANEL W/STEEL REINFORCEMENT (FIBER CLASSIC)	FIBERGLASS
51	FIBER CLASSIC DOOR SKIN .110" MINIMUM THK. FIBERGLASS	FIBERGLASS
52	TOP RAIL	COMP.
54	HINGE STILE	LVL/WOOD
55	BOTTOM RAIL	COMP.
57	LOCK STILE	LVL/WOOD
60	FIBERGLASS DOOR PANEL W/STEEL REINFORCEMENT (CLASSIC CRAFT)	FIBERGLASS
61	CLASSIC CRAFT DOOR SKIN .125" MINIMUM THK. FIBERGLASS	FIBERGLASS
62	TOP RAIL	COMP.
64	HINGE STILE	WOOD
65	BOTTOM RAIL	COMP.
67	LOCK STILE	LVL/WOOD
70	FIBERGLASS DOOR PANEL W/STEEL REINFORCEMENT (CLASSIC CRAFT RUSTIC)	FIBERGLASS
71	CLASSIC CRAFT RUSTIC DOOR SKIN .125" MINIMUM THK. FIBERGLASS	FIBERGLASS
72	TOP RAIL	COMP.
75	BOTTOM RAIL	COMP.
77	HINGE AND LOCK STILE	WOOD
78	ASTRAGAL STRIKE PLATE	STEEL

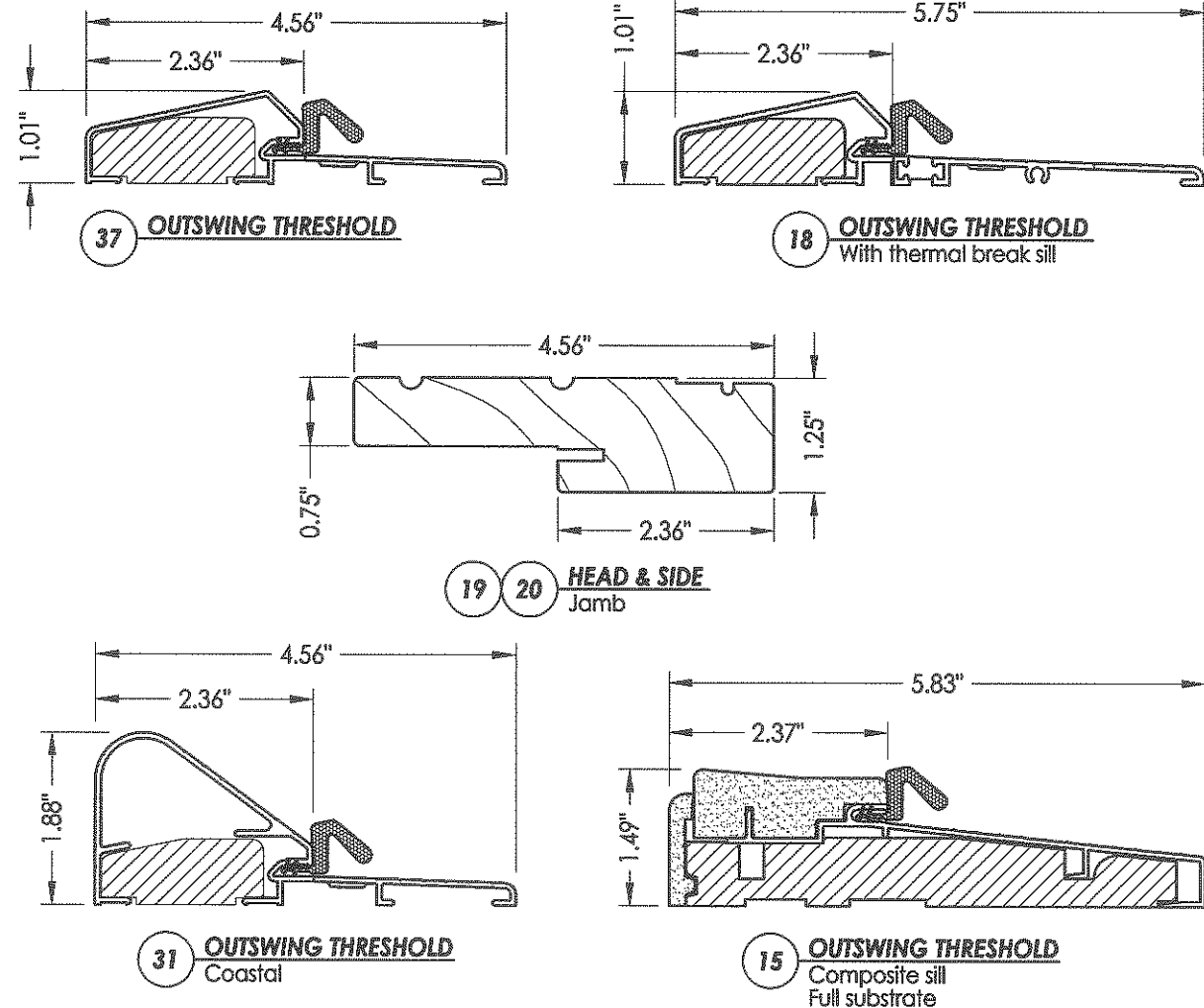

Documents Prepared By: **RW** BUILDING CONSULTANTS, INC.
P.O. Box 230 Valrico FL 33595
Phone No.: 813.659.9197
Florida Board of Professional Engineers
Certificate Of Authorization No. 9813
LFS
Lyndon F. Schmidt, P.E. No. 43409

PRODUCT: THERMA TRU FIBERGLASS GLAZED DOOR
PART OR ASSEMBLY: BILL OF MATERIALS

NO.	DATE	REVISIONS
1	3/9/11	REVISE CLASSIC CRAFT DOOR

DATE: 2/26/09
SCALE: N.T.S.
DWG. BY: JK
CHK. BY: LFS
DRAWING NO.: FL-12334.9
SHEET 11 OF 11