

R:\A - Projects\Project Folders\proj_1401-1500\PE_1455\DWG_RWBC Drawings\EL-12334\EL-12334-16-20.dwg_D-2

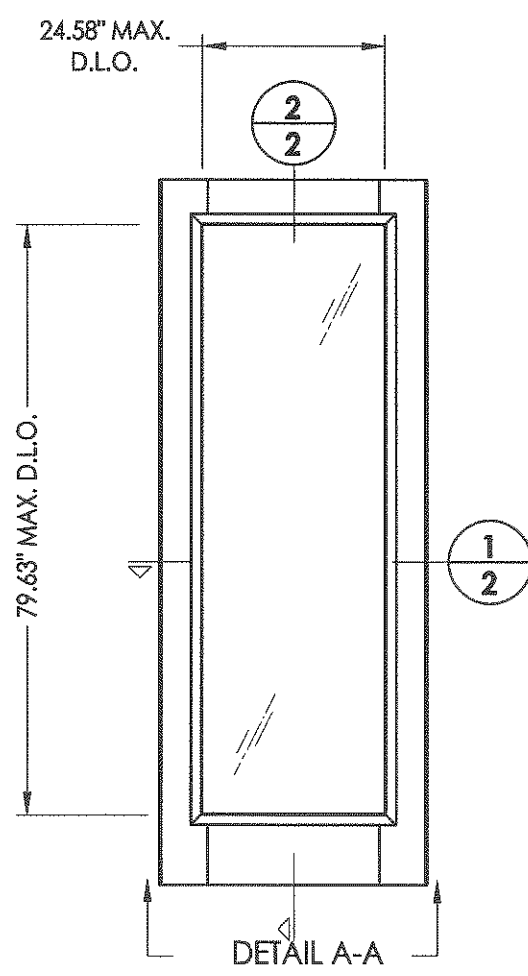

40 DOOR PANEL
Smooth Star

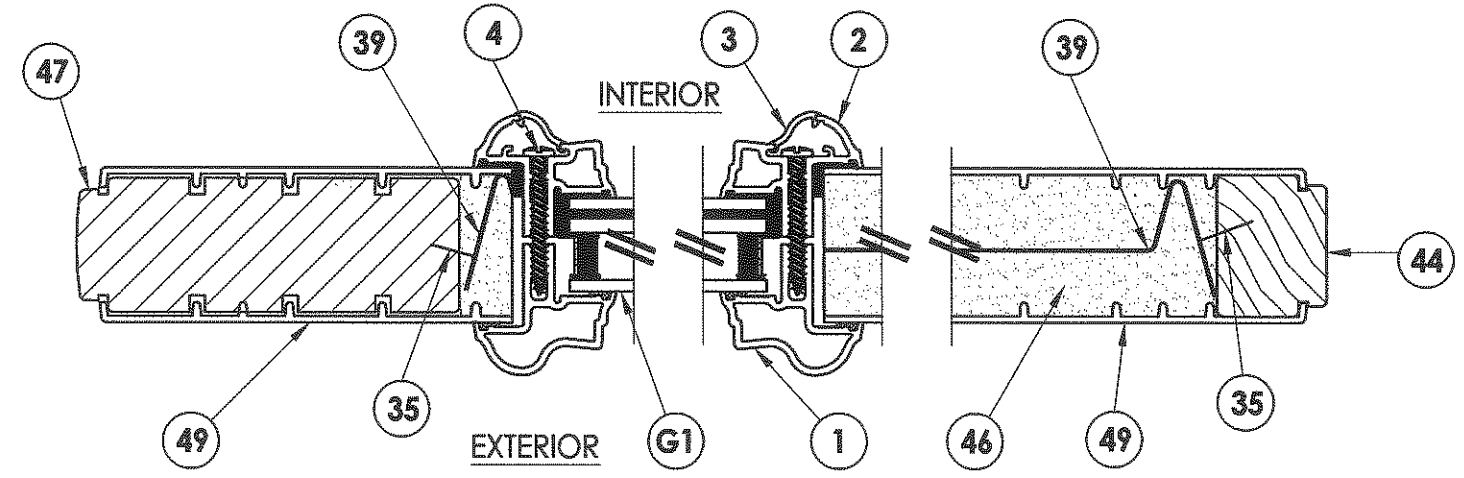

1
2
HORIZONTAL CROSS SECTION

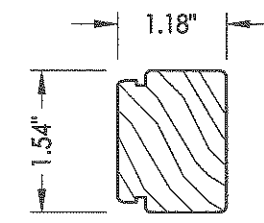

44 HINGE STILE

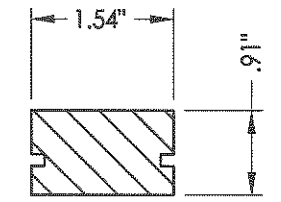

48 TOP RAIL

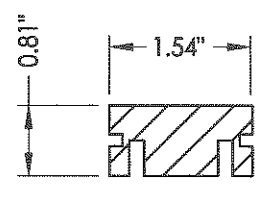

45 BOTTOM RAIL

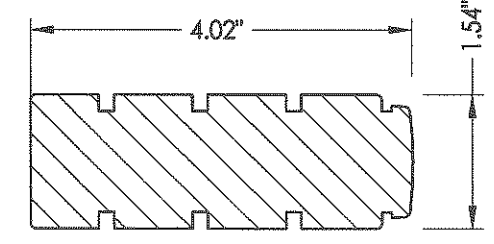

47 LOCK STILE

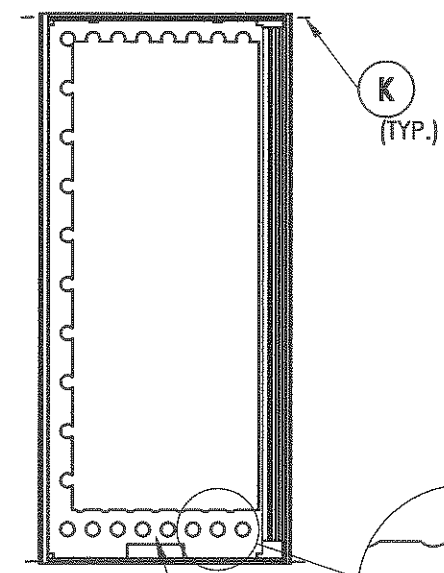

DETAIL A-A
Panel reinforcement

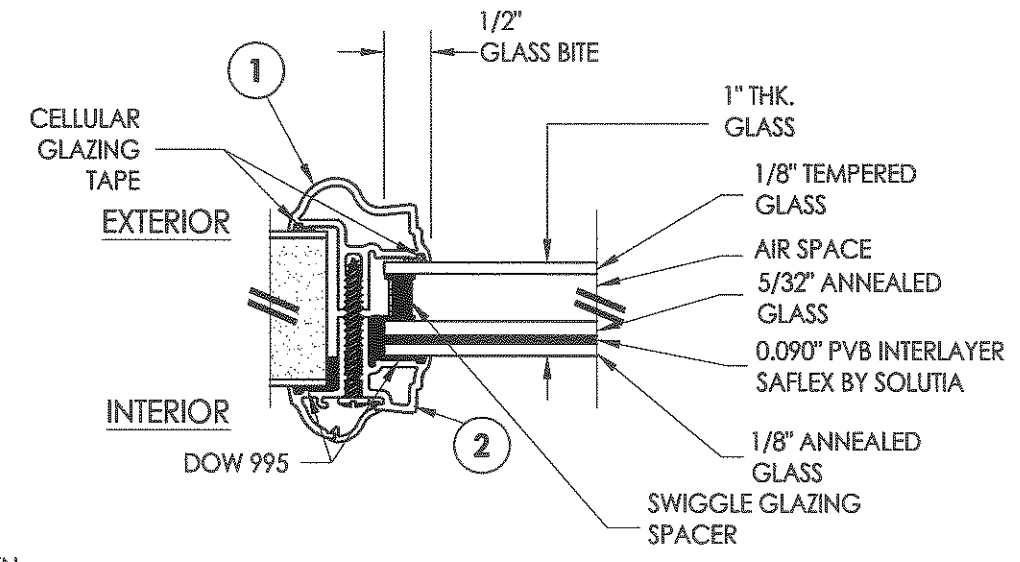

G1 GLAZING DETAIL

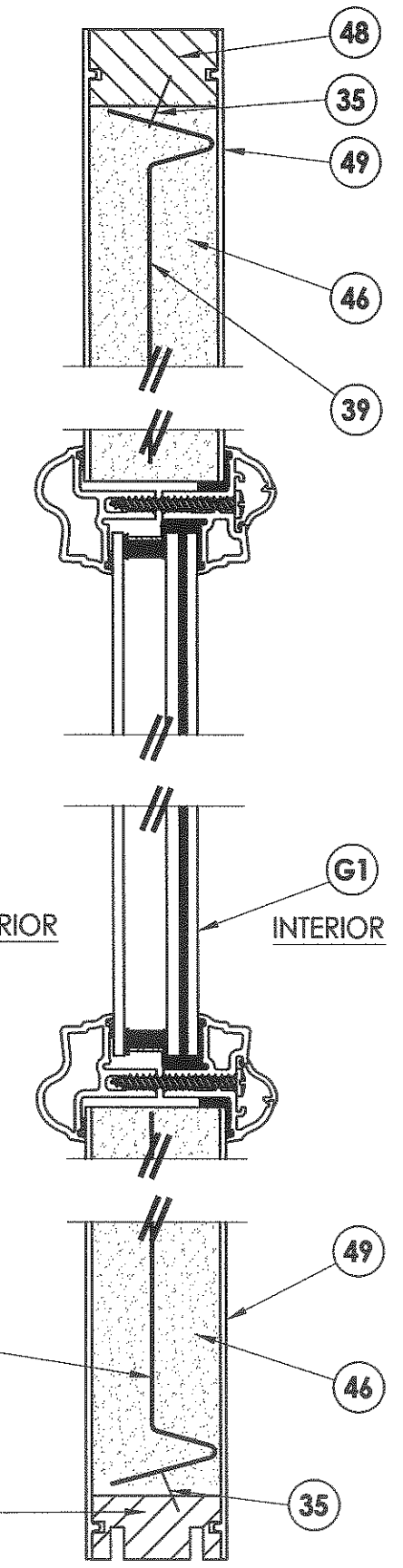

2
2
VERTICAL CROSS SECTION

PRODUCT:
THERMA TRU
FIBERGLASS GLAZED DOOR

PART OR ASSEMBLY:
DOOR PANEL DETAILS & GLAZING
DETAILS (SMOOTH STAR)

| REVISIONS | |
|-----------|-----------|
| NO. | DATE |
| 1 | 3/9/11 |
| JK | BY |
| JK | REVISIONS |

DATE: 3/17/09
SCALE: N.T.S.
DWG. BY: JK
CHK. BY: LFS
DRAWING NO.: FL-12334.19
SHEET 2 OF 11

Documents Prepared By:

RW
BUILDING CONSULTANTS, INC.
P.O. Box 230 Valrico FL 33595
Phone No.: 813.659.9197
Florida Board of Professional Engineers
Certificate Of Authorization No. 9813
Lyndon F. Schmidt, P.E. No. 43409

R:\A - Projects\Project Folders\proj_1401-1500\PE_1455\D_RWBC Drawings\EL-12334\EL-12334-16-20.dwg_D-3

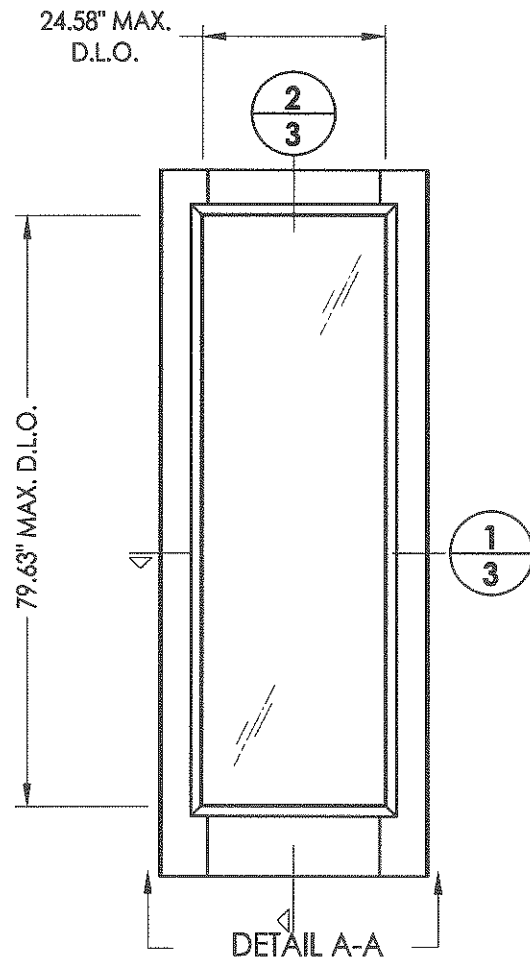

50 DOOR PANEL
Fiber Classic

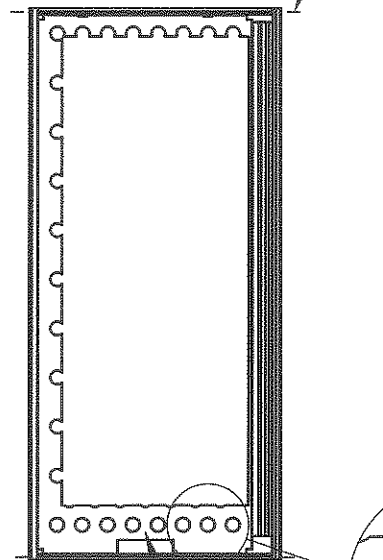

DETAIL A-A
Panel reinforcement

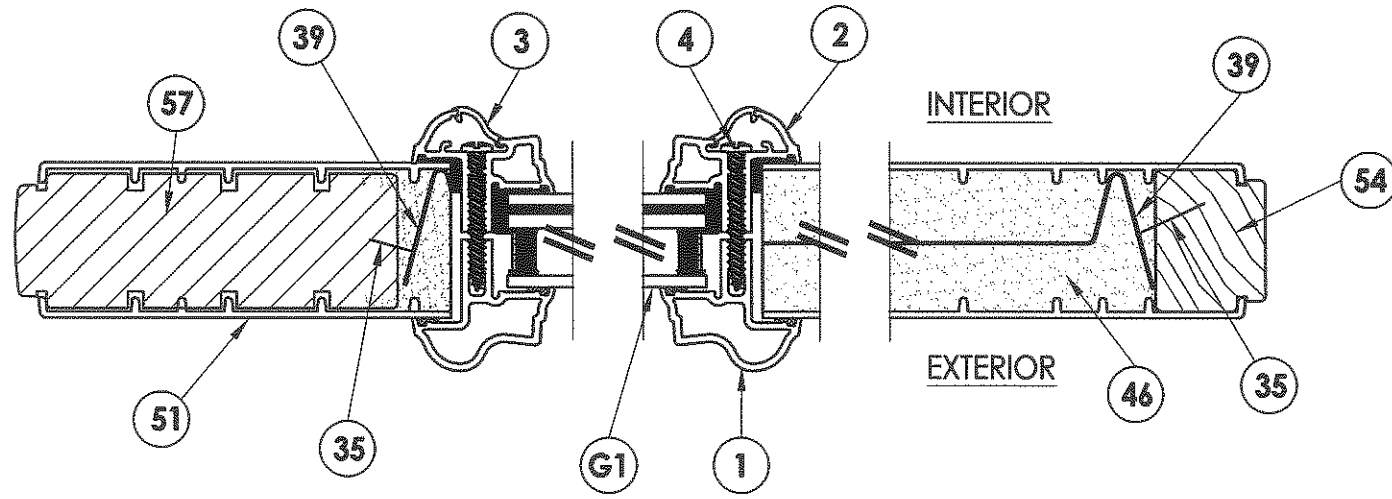

1
3 HORIZONTAL CROSS SECTION

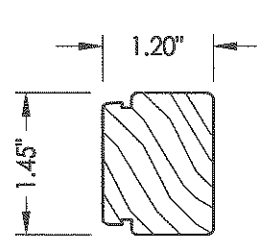

54 HINGE STILE

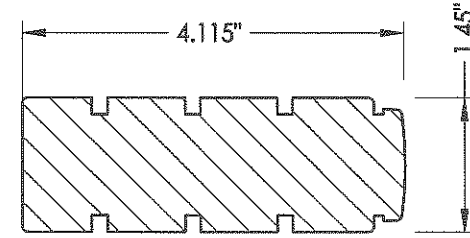

57 LOCK STILE

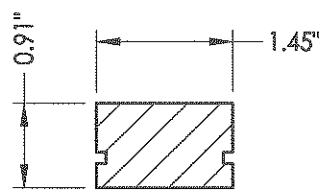

52 TOP RAIL

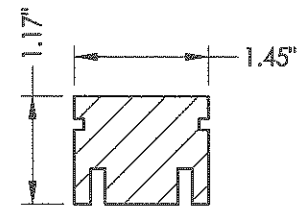

55 BOTTOM RAIL

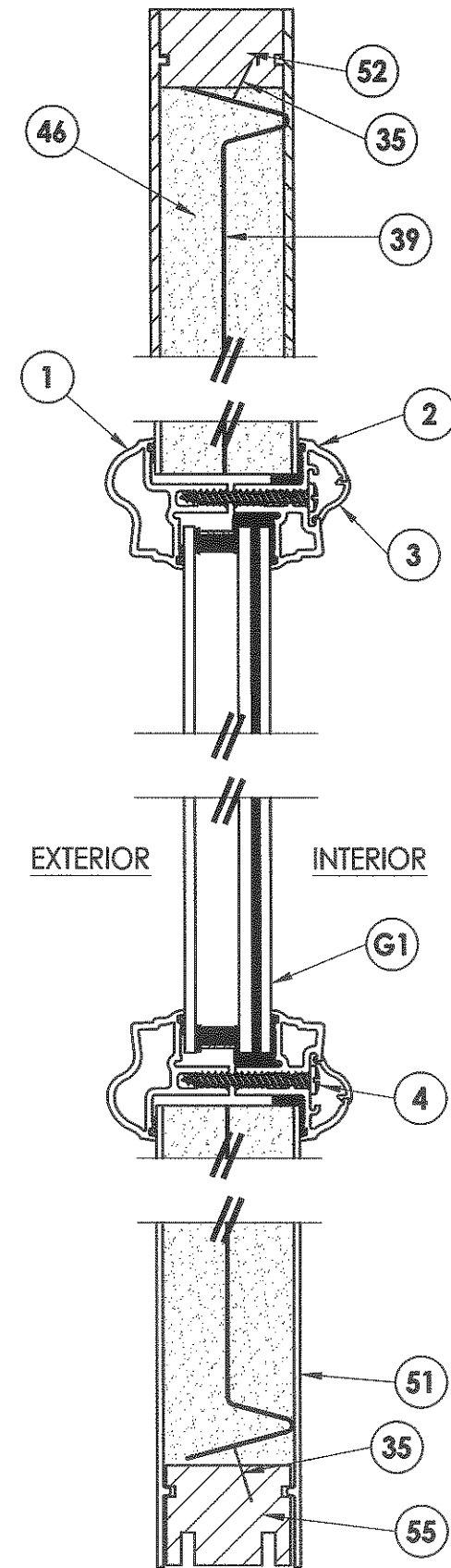

2
3 VERTICAL CROSS SECTION

Documents Prepared By:

RW BUILDING CONSULTANTS, INC.
P.O. Box 230 Valrico FL 33595
Phone No.: 813.659.9197
Florida Board of Professional Engineers
Certificate Of Authorization No. 9813
3/17/09
Lyndon F. Schmidt, P.E. No. 43409

PRODUCT:
THERMA-TRU
FIBERGLASS GLAZED DOOR

PART OR ASSEMBLY:
DOOR PANEL DETAILS
(FIBER CLASSIC)

| NO. | DATE | BY | REVISIONS |
|-----|--------|----|---------------------------|
| 1 | 3/9/11 | JK | REVISE CLASSIC CRAFT DOOR |

DATE: 3/17/09

SCALE: N.T.S.

DWG. BY: JK

CHK. BY: LFS

DRAWING NO.:

FL-12334.19

SHEET 3 OF 11

R:\A - Projects\Project Folders\proj 1401-1500\PF 1455\D. RWBC Drawings\FL-12334\FL-12334-16-20.dwg, D-4

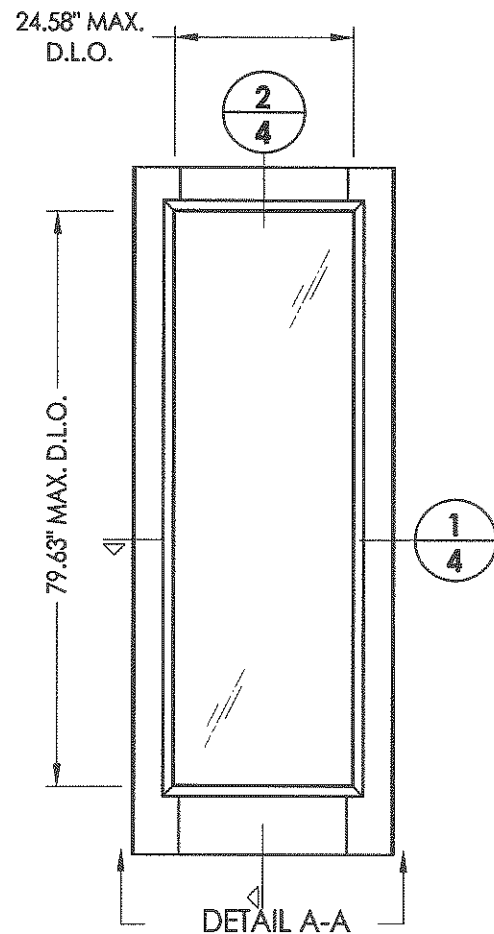

60 DOOR PANEL
Classic Craft

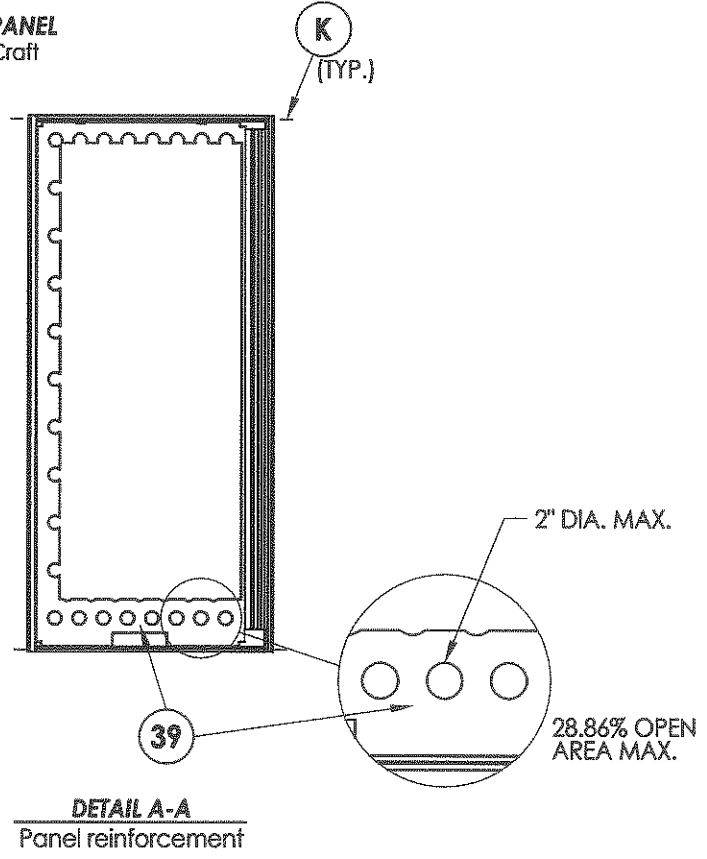

DETAIL A-A
Panel reinforcement

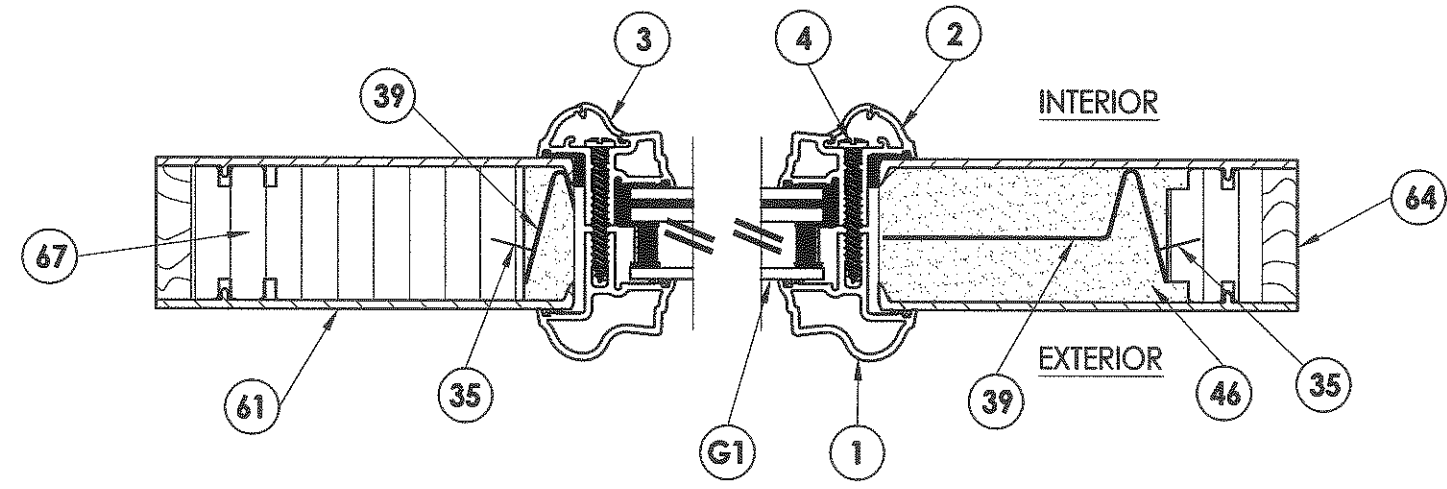

1 HORIZONTAL CROSS SECTION

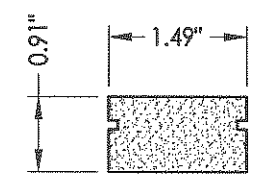

62 TOP RAIL

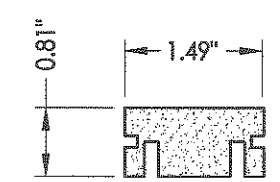

65 BOTTOM RAIL

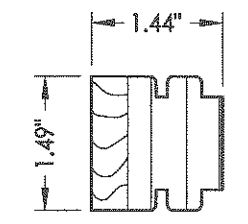

64 HINGE STILE

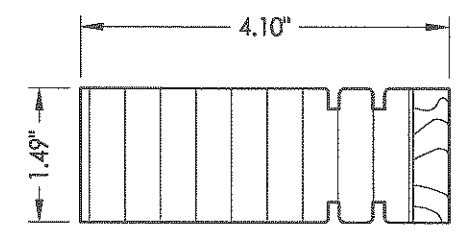

67 LOCK STILE

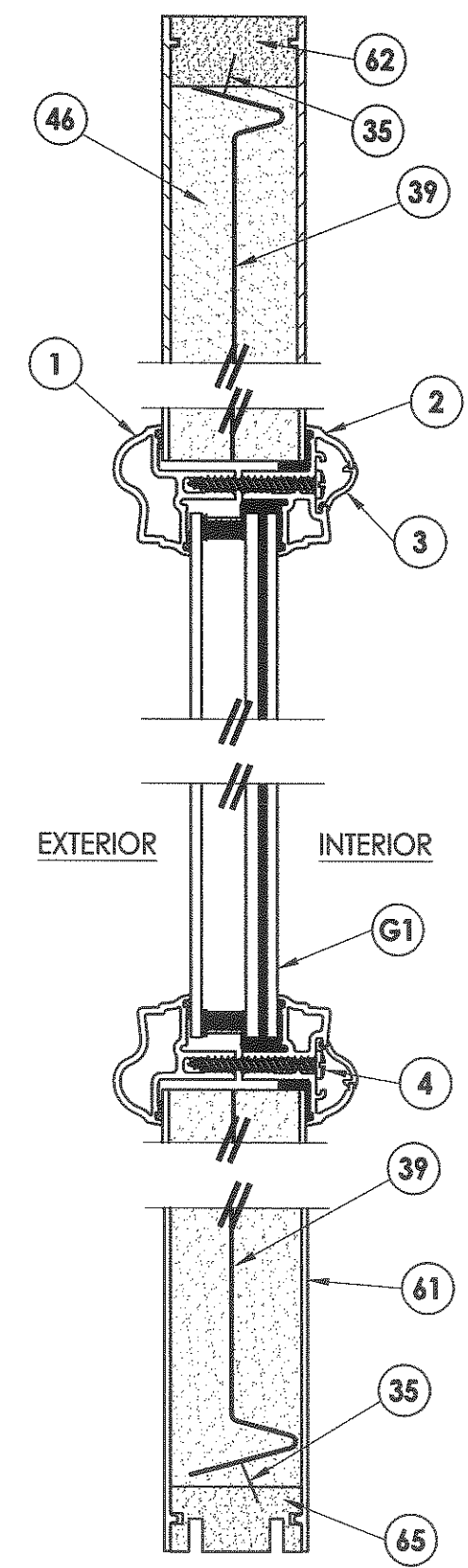

2 VERTICAL CROSS SECTION

Documents Prepared By:
RW BUILDING CONSULTANTS, INC.
 P.O. Box 230 Valrico FL 33595
 Phone No.: 813.659.9197
 Florida Board of Professional Engineers
 Certificate of Authorization No. 9813
LF 2-17-11
 Lyndon F. Schmidt, P.E. No. 43409

PRODUCT: THERMA-TRU
 FIBERGLASS GLAZED DOOR
 PART OR ASSEMBLY:
 DOOR PANEL DETAILS
 (CLASSIC CRAFT)

| NO. | DATE | REVISIONS |
|-----|--------|---------------------------|
| 1 | 3/9/11 | REVISE CLASSIC CRAFT DOOR |
| | | JK BY |

DATE: 2/26/09
 SCALE: N.T.S.
 DWG. BY: JK
 CHK. BY: LFS
 DRAWING NO.: FL-12334.19
 SHEET 4 OF 11

R:\A - Projects\Project Folders\proj_1401-1500\PE 1455\D - RWBC Drawings\EL-12334\EL-12334-16-20.dwg_D-5

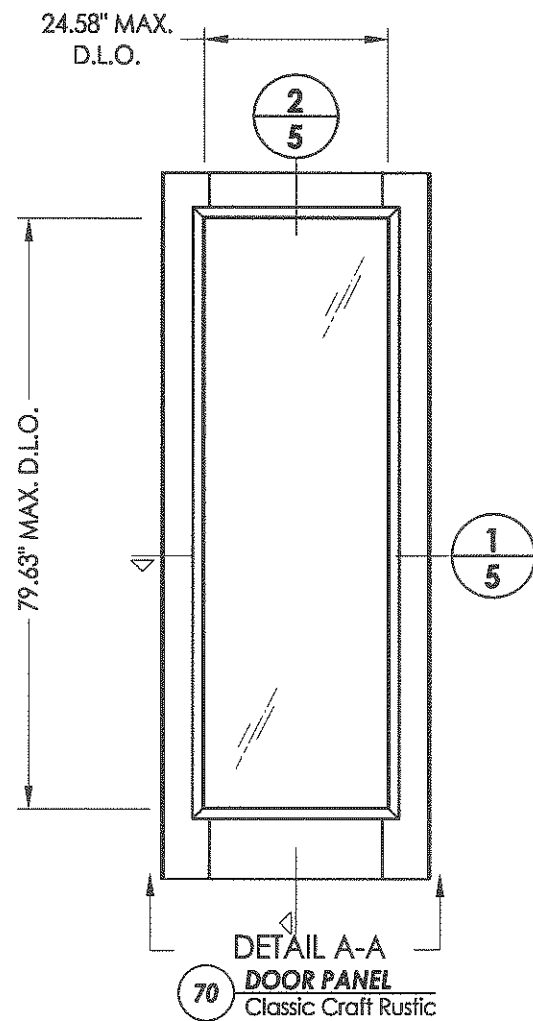

70
DETAIL A-A
DOOR PANEL
Classic Craft Rustic

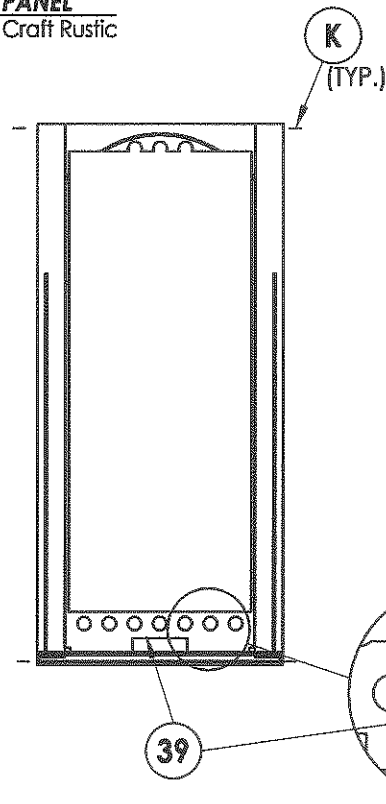

DETAIL A-A
Panel reinforcement

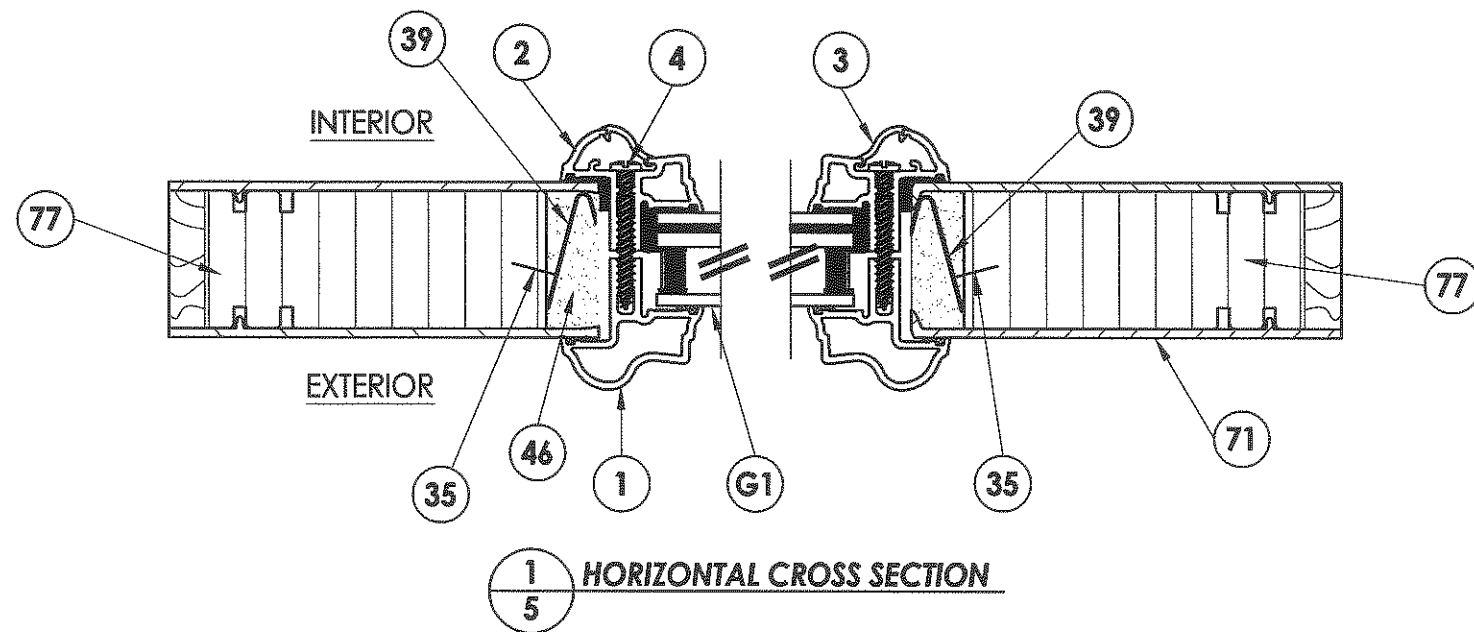

1
5
HORIZONTAL CROSS SECTION

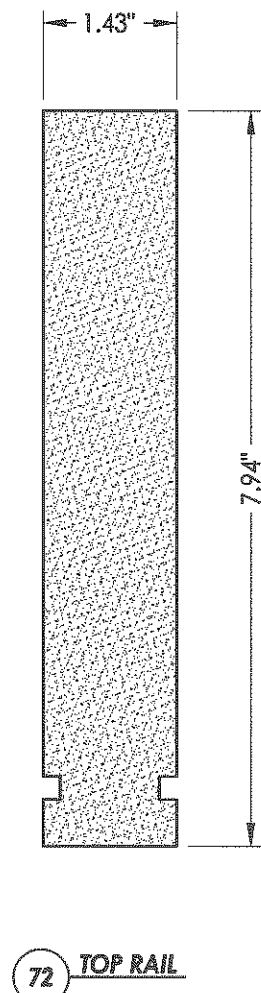

72
TOP RAIL

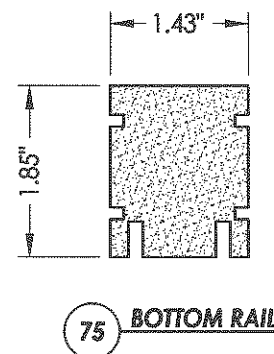

75
BOTTOM RAIL

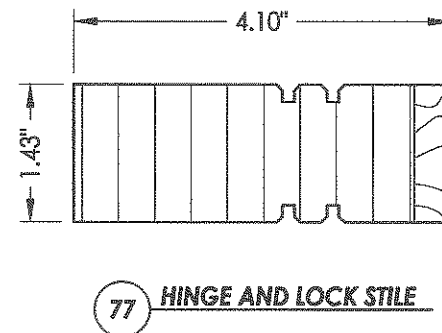

77
HINGE AND LOCK STILE

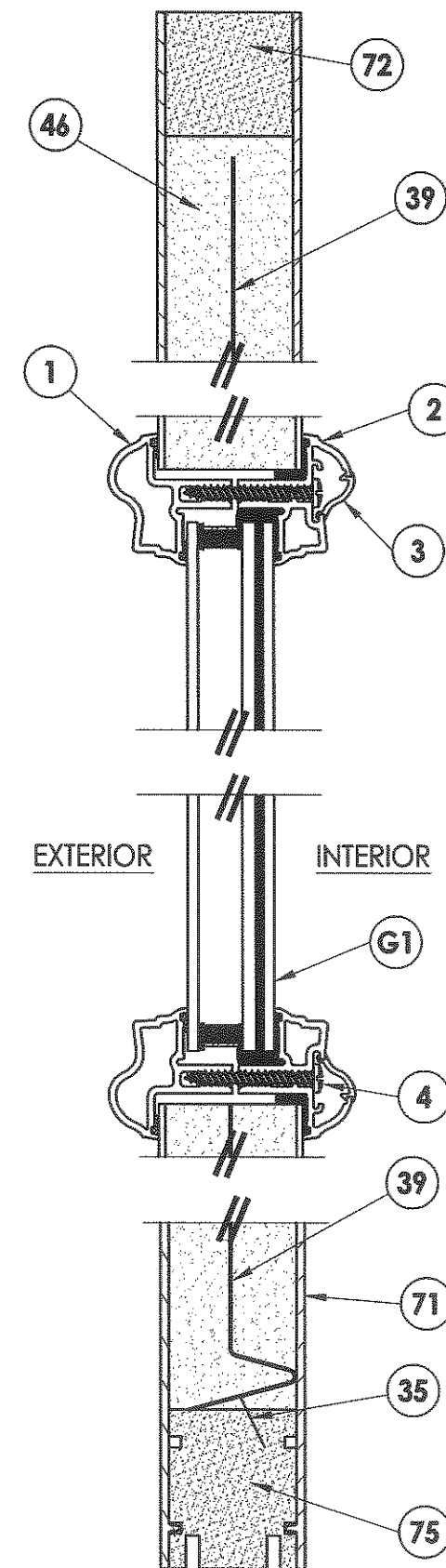

2
5
VERTICAL CROSS SECTION

Documents Prepared By:

RW BUILDING CONSULTANTS, INC.
P.O. Box 230 Valrico FL 33595
Phone No.: 813.659.9197
Florida Board of Professional Engineers
Certificate Of Authorization No. 9813
3/17/09
Lyndon F. Schmidt, P.E. No. 43409

PRODUCT:
THERMA-TRU
FIBERGLASS GLAZED DOOR

PART OR ASSEMBLY:
DOOR PANEL DETAILS
(CLASSIC CRAFT RUSTIC)

| NO. | DATE | BY | REVISIONS |
|-----|------|----|-----------|
| | | | |
| | | | |
| | | | |
| | | | |

DATE: 3/17/09
SCALE: N.T.S.
DWG. BY: JK
CHK. BY: LFS
DRAWING NO.: FL-12334.19
SHEET 5 OF 11

R:\A - Projects\Project Enclaves\Proj. 1401-1500\PE 1455\DWG Drawings\EL-12334\EL-12334.16-20.dwg_D-6

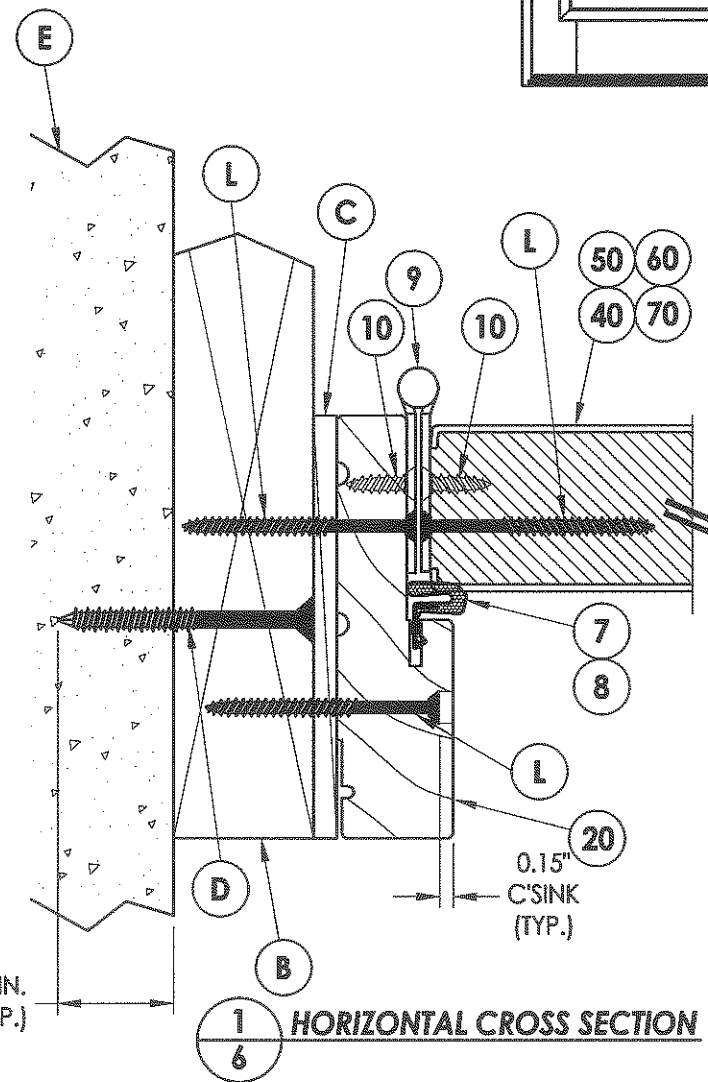

1 HORIZONTAL CROSS SECTION

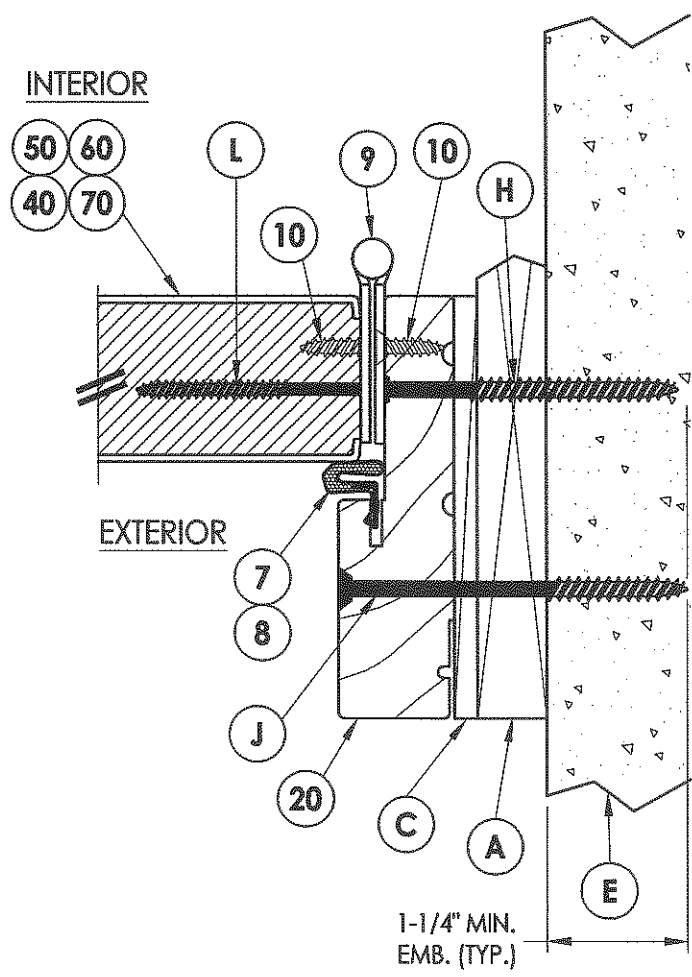
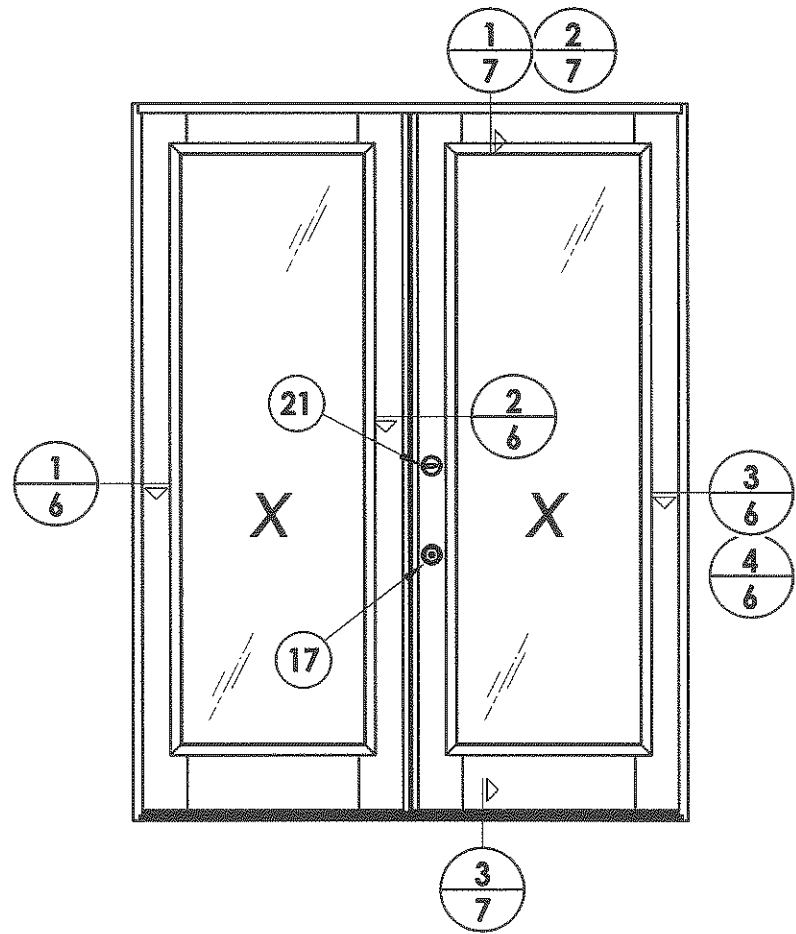

4 HORIZONTAL CROSS SECTION
 Shown w/1X sub-buck substituting concrete screws for wood screws per Section 1714.5.4.2 of the FBC

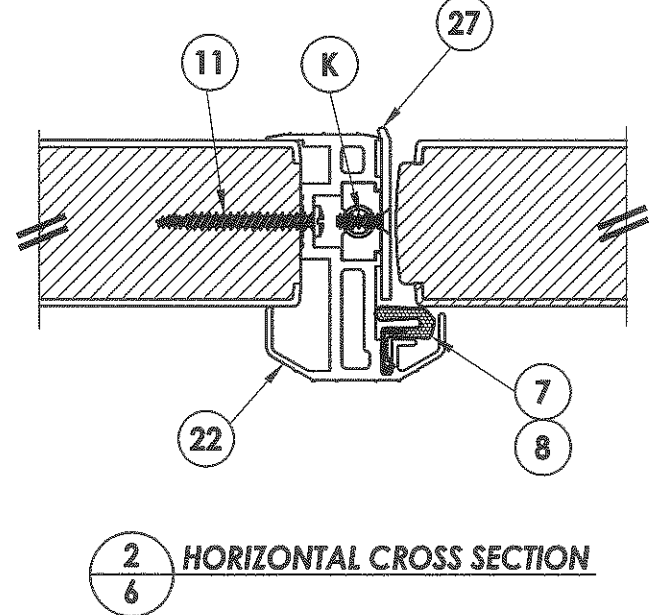

2 HORIZONTAL CROSS SECTION

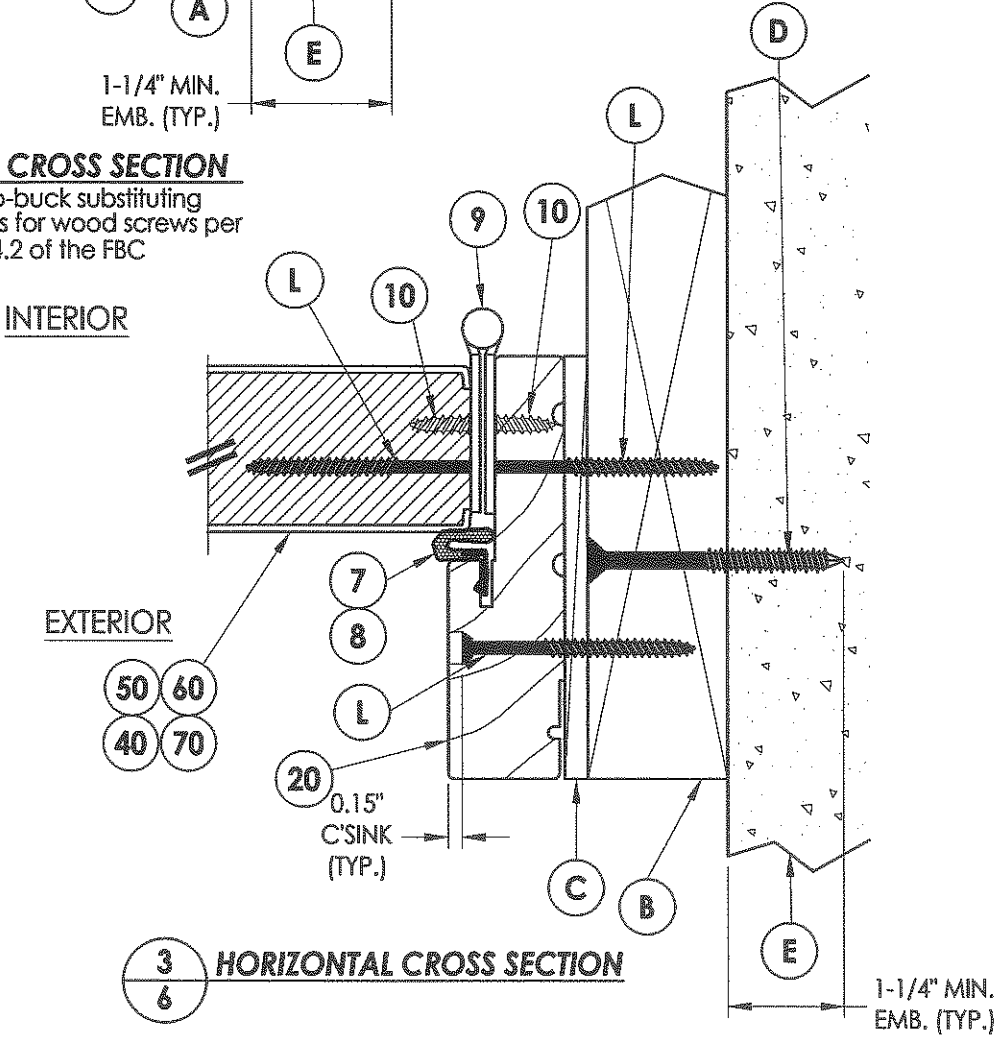

3 HORIZONTAL CROSS SECTION

| | | | |
|------------------------|--------------------------------------|---|---------------------------|
| Documents Prepared By: | | RW BUILDING CONSULTANTS, INC. P.O. Box 230 Valrico FL 33595 Phone No.: 813.659.9197 Florida Board of Professional Engineers Certificate of Authorization No. 9813 <i>RWS</i> Lyndon F. Schmidt, P.E. No. 43409 | |
| PRODUCT: | THERMA TRU FIBERGLASS GLAZED DOOR | | |
| PART OR ASSEMBLY: | HORIZONTAL CROSS SECTIONS | | |
| | | JK | BY |
| | | 3/9/11 | REVISE CLASSIC CRAFT DOOR |
| | | NO. DATE | |
| | | | REVISIONS |
| DATE: | 3/17/09 | | |
| SCALE: | N.T.S. | | |
| DWG. BY: | JK | | |
| CHK. BY: | LFS | | |
| DRAWING NO.: | FL-12334.19 | | |
| SHEET | 6 | OF 11 | |

© 2009 R.W. BUILDING CONSULTANTS INC.

R:\A - Projects\Project Folders\proj_1401-1500\PE_1455\D_RWBC_Drawings\FL-12334\FI-12334_16-20.dwg_D-7

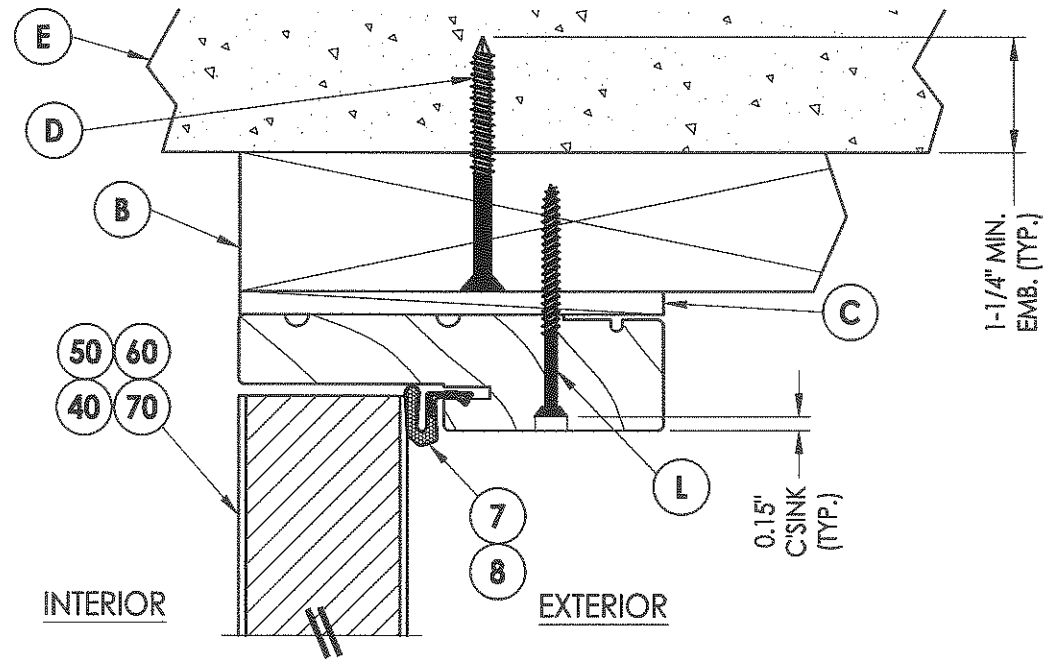

1
7 VERTICAL CROSS SECTION

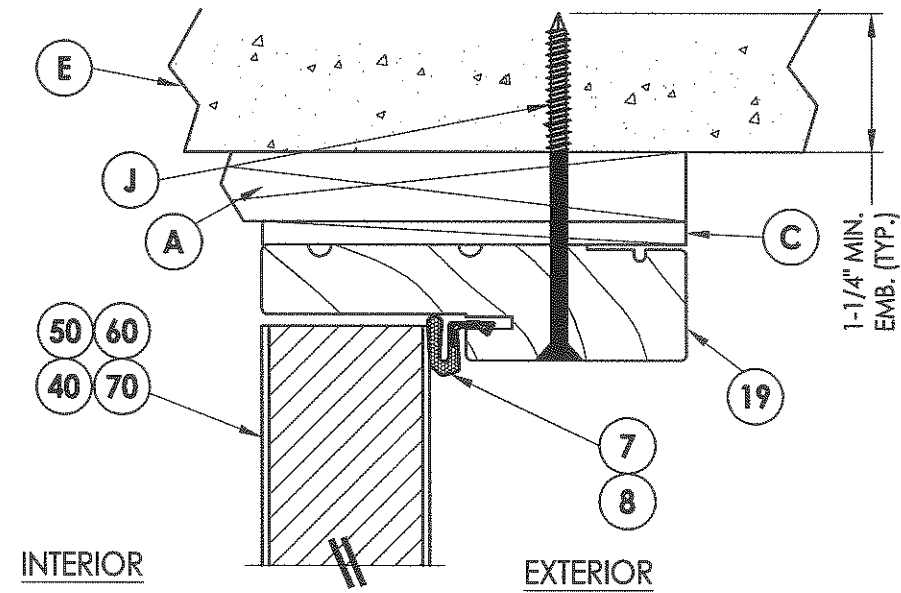

2
7 VERTICAL CROSS SECTION
Shown w/1X sub-buck substituting
concrete screws for wood screws per
Section 1714.5.4.2 of the FBC

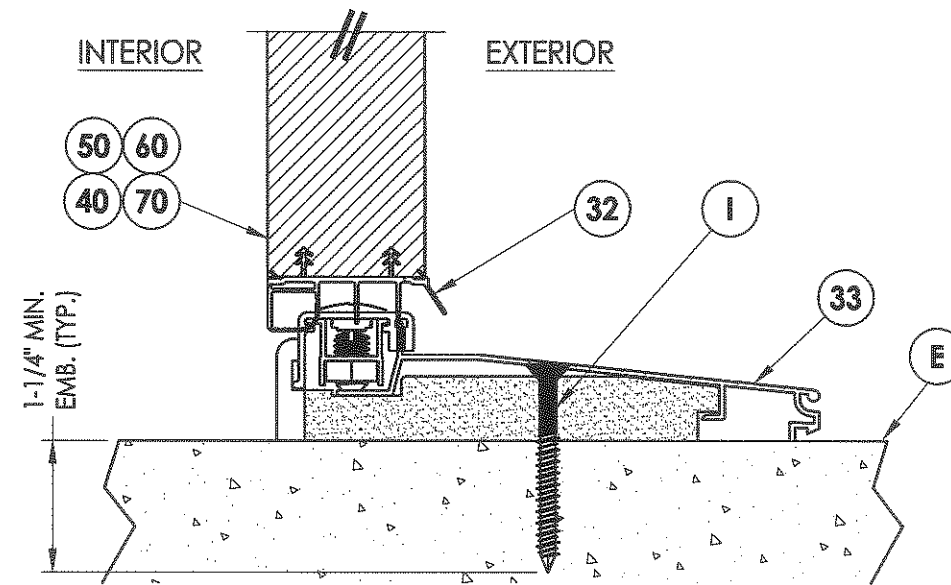

3
7 VERTICAL CROSS SECTION
Inswing configuration
see general notes, sheet 1
for "HVHZ" water infiltration
requirements

Documents Prepared By:

RW BUILDING CONSULTANTS, INC.
P.O. Box 230 Valrico FL 33595
Phone No.: 813.659.9197
Florida Board of Professional Engineers
Certificate Of Authorization No. 9813

Lyndon F. Schmidt, P.E. No. 43409

PRODUCT:
THERMA TRU
FIBERGLASS GLAZED DOOR

PART OR ASSEMBLY:
VERTICAL
CROSS SECTIONS

| NO | DATE | REVISIONS |
|----|--------|---------------------------|
| 1 | 3/9/11 | REVISE CLASSIC CRAFT DOOR |
| | | JK BY |

DATE: 3/17/09

SCALE: N.T.S.

DWG. BY: JK

CHK. BY: LFS

DRAWING NO.:
FL-12334.19

SHEET 7 OF 11

R:\A - Projects\Project_Folders\proj_1401-1500\PE_1455\D_RWBC Drawings\EL-12334\EL-12334-16-20.dwg_D-8

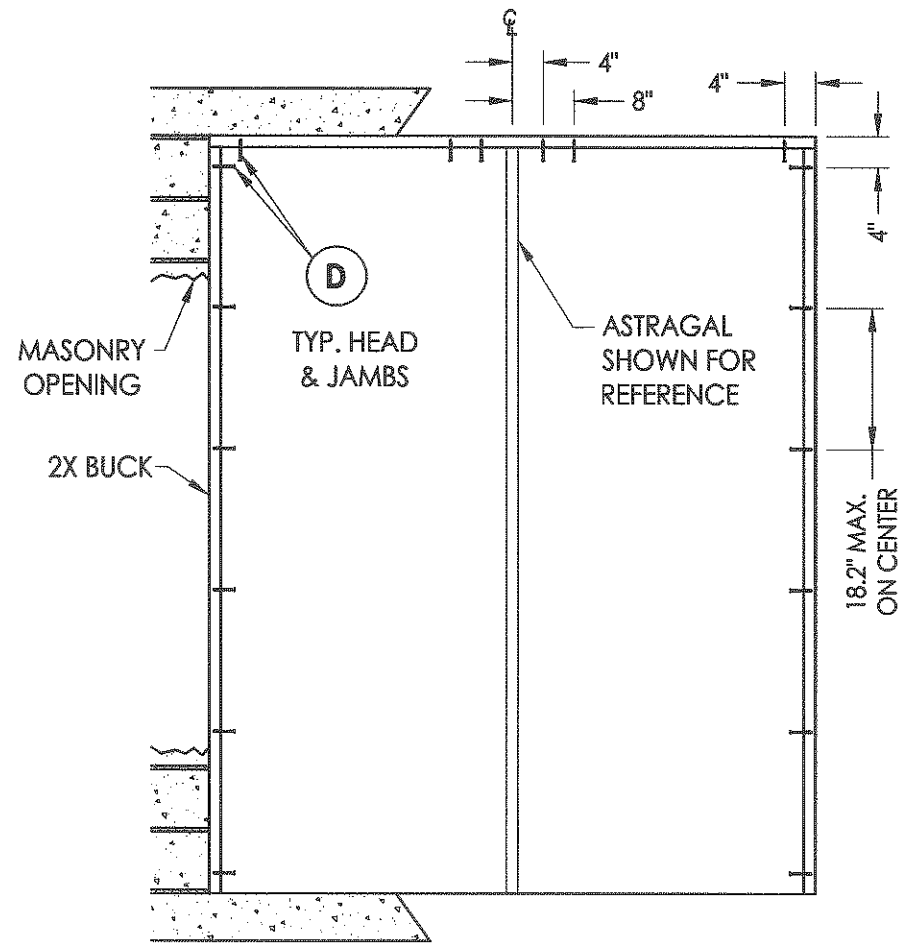

BUCK ANCHORING

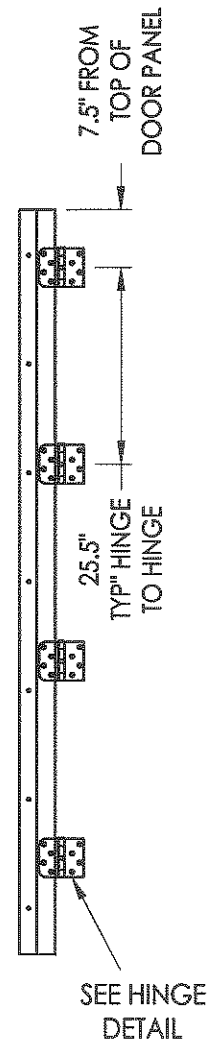

HINGE JAMB

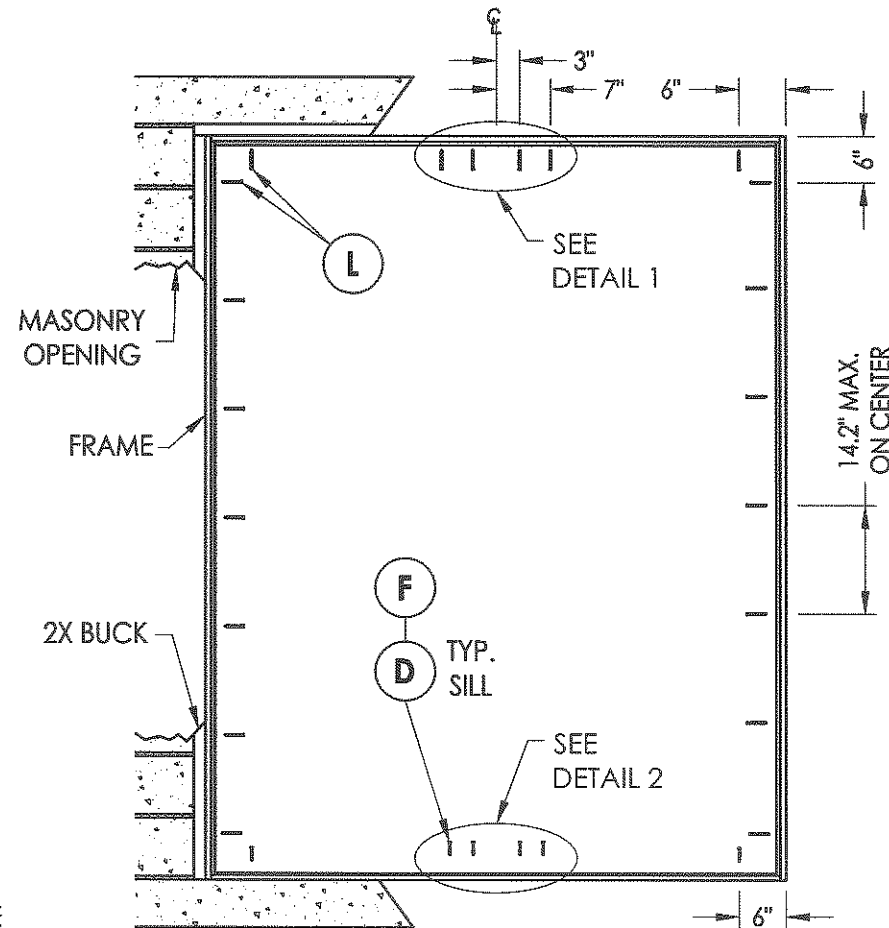

FRAME ANCHORING
Masonry 2X buck construction

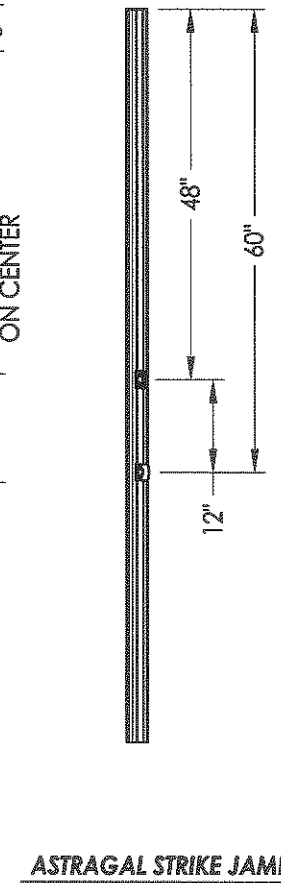

ASTRAGAL STRIKE JAMB

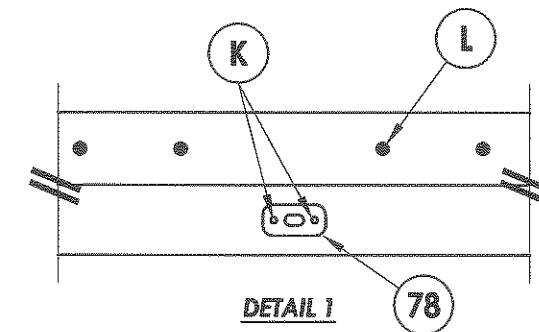
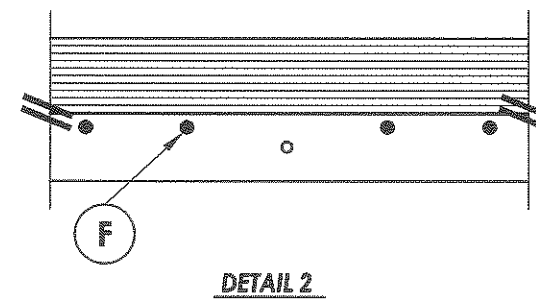
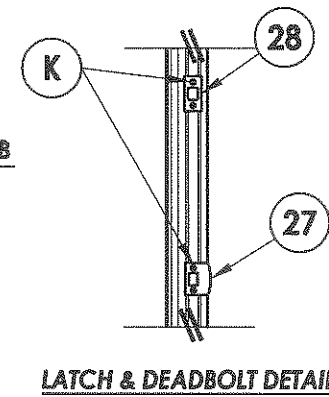
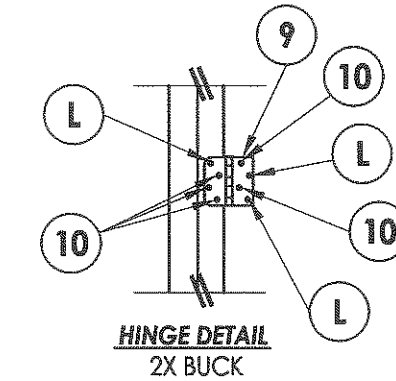

CONCRETE ANCHOR NOTES:

1. Substitution of equal concrete anchors from a different supplier may have different edge distance and center distance requirements.
2. Concrete anchor locations at the corners may be adjusted to maintain the min. edge distance to mortar joints. Concrete anchor locations noted as "MAX. ON CENTER" must be adjusted to maintain the min. edge distance to mortar joints, additional concrete anchors may be required to ensure the "MAX. ON CENTER" dimension are not exceeded.
3. Concrete anchor table:

| ANCHOR TYPE | ANCHOR SIZE | MIN. EMBEDMENT | MIN. CLEARANCE TO MASONRY EDGE | MIN. CLEARANCE TO ADJACENT ANCHOR |
|-------------|-------------|----------------|--------------------------------|-----------------------------------|
| ITW | 1/4" | 1-1/4" | 2-1/2" | 3" |
| ELCO | 1/4" | 1-1/4" | 1" | 4" |
| ITW | 3/16" | 1-1/4" | 2-5/8" | 2-1/4" |

Documents Prepared By:

RW BUILDING CONSULTANTS, INC.
P.O. Box 230 Valrico FL 33595
Phone No.: 813.659.9197
Florida Board of Professional Engineers
Certificate Of Authorization No. 9813
Lyndon F. Schmidt, P.E. No. 43409

PRODUCT: THERMA TRU FIBERGLASS GLAZED DOOR
PART OR ASSEMBLY: BUCK & FRAME ANCHORING 2X BUCK MASONRY CONSTRUCTION

| NO. | DATE | REVISIONS | JK | BY |
|-----|--------|---------------------------|----|----|
| 1 | 3/9/11 | REVISE CLASSIC CRAFT DOOR | | |

DATE: 3/17/09
SCALE: N.T.S.
DWG. BY: JK
CHK. BY: LFS
DRAWING NO.: FL-12334.19
SHEET 8 OF 11

R:\A - Projects\Project_Folders\proj_1401-1500\1PE_1455\DWG_RWRC_Drawings\FL-12334\FL-12334-16-20.dwg_D-9

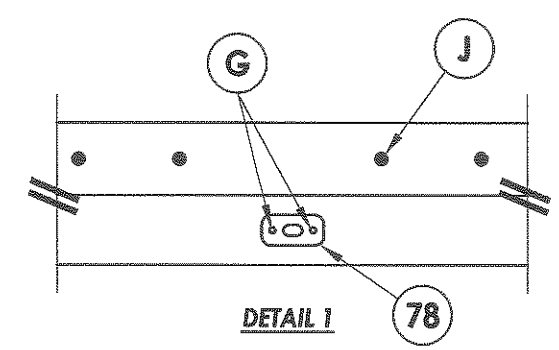
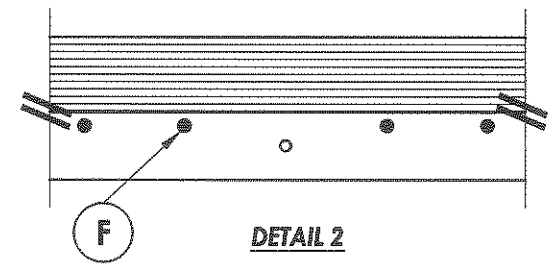
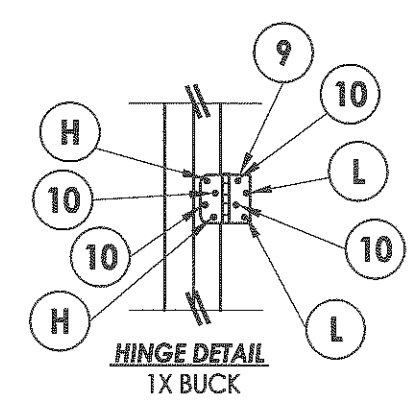
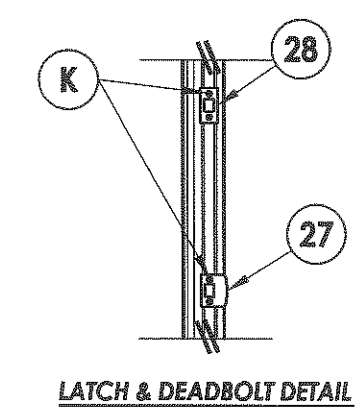
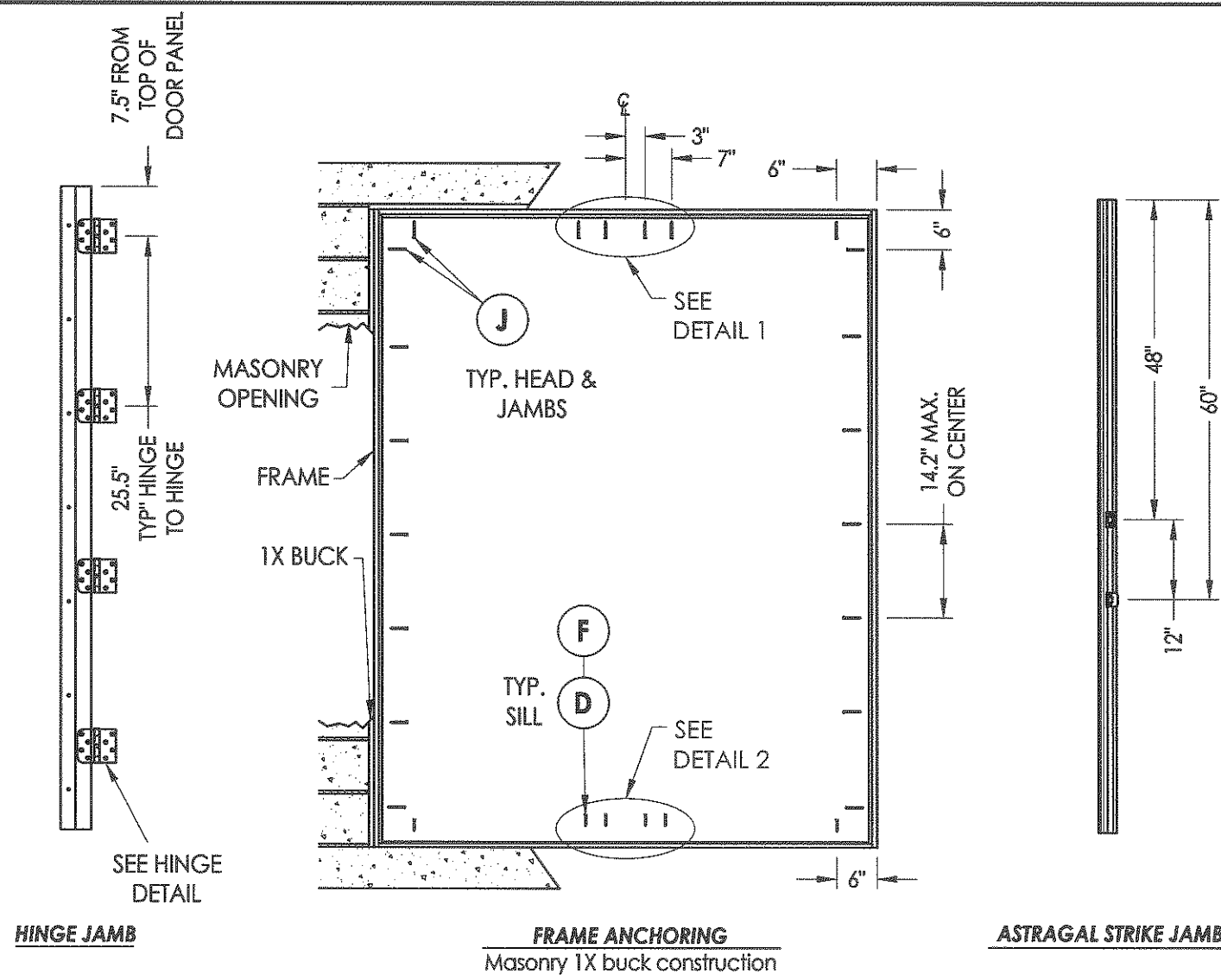

CONCRETE ANCHOR NOTES:

1. Substitution of equal concrete anchors from a different supplier may have different edge distance and center distance requirements.
2. Concrete anchor locations at the corners may be adjusted to maintain the min. edge distance to mortar joints. Concrete anchor locations noted as "MAX. ON CENTER" must be adjusted to maintain the min. edge distance to mortar joints, additional concrete anchors may be required to ensure the "MAX. ON CENTER" dimension are not exceeded.
3. Concrete anchor table:

| ANCHOR TYPE | ANCHOR SIZE | MIN. EMBEDMENT | MIN. CLEARANCE TO MASONRY EDGE | MIN. CLEARANCE TO ADJACENT ANCHOR |
|-------------|-------------|----------------|--------------------------------|-----------------------------------|
| ITW | 1/4" | 1-1/4" | 2-1/2" | 3" |
| ELCO | 1/4" | 1-1/4" | 1" | 4" |
| ITW | 3/16" | 1-1/4" | 2-5/8" | 2-1/4" |

Documents Prepared By: **RW** BUILDING CONSULTANTS, INC.
P.O. Box 230 Valrico FL 33595
Phone No.: 813.659.9197
Florida Board of Professional Engineers
Certificate Of Authorization No. 9813
Lyndon F. Schmidt, P.E. No. 43409

PRODUCT: THERMA TRU FIBERGLASS GLAZED DOOR
PART OR ASSEMBLY: FRAME ANCHORING 1X BUCK MASONRY CONSTRUCTION

| NO. | DATE | REVISIONS |
|-----|--------|---------------------------|
| 1 | 3/9/11 | REVISE CLASSIC CRAFT DOOR |
| | | BY JK |

DATE: 3/17/09
SCALE: N.T.S.
DWG. BY: JK
CHK. BY: LFS
DRAWING NO.: FL-12334.19
SHEET 9 OF 11

© 2009 R.W. BUILDING CONSULTANTS INC.

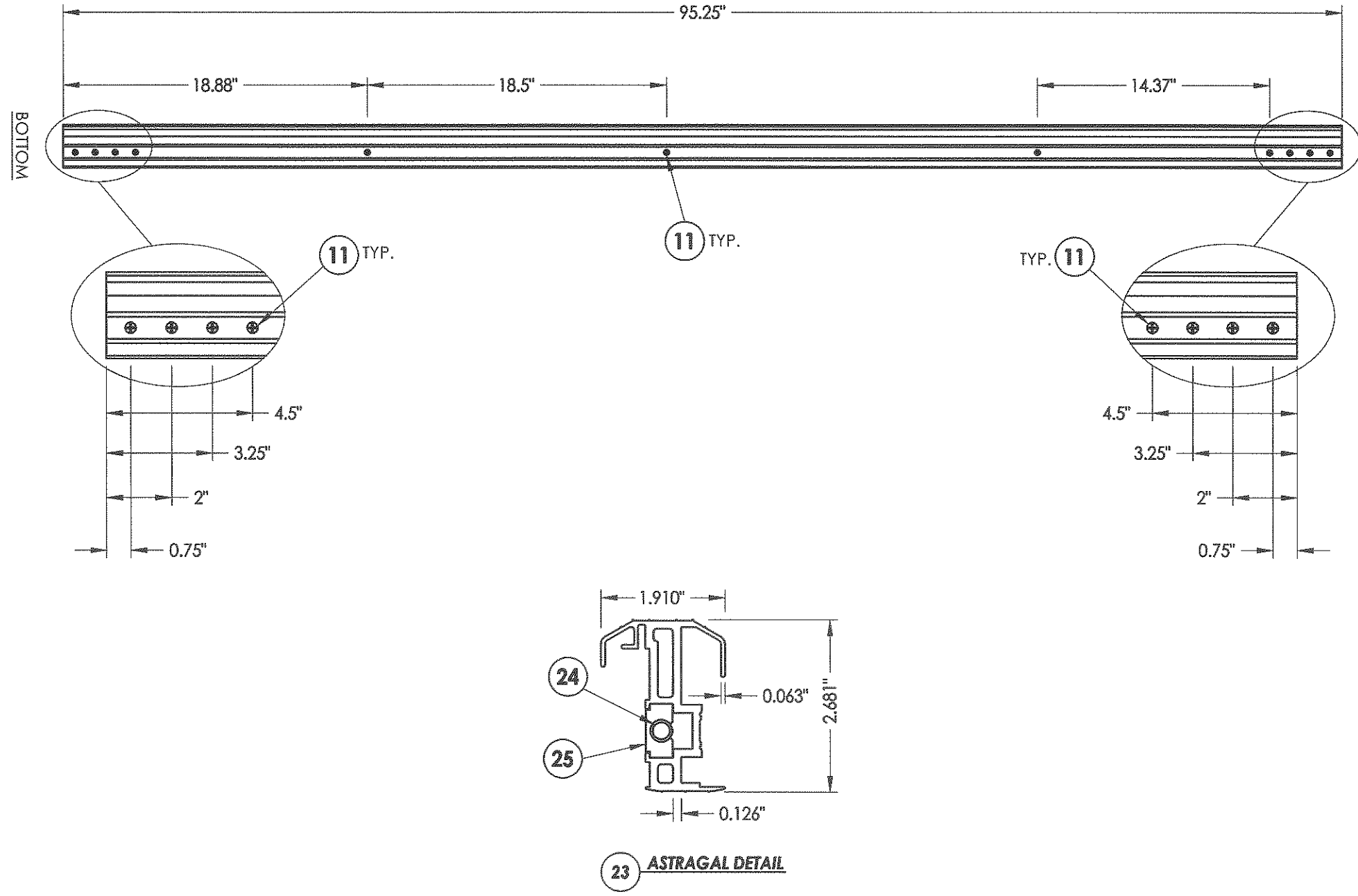

| | |
|--------------|-------------|
| DATE: | 3/17/09 |
| SCALE: | N.T.S. |
| DWG. BY: | JK |
| CHK. BY: | LFS |
| DRAWING NO.: | FL-12334.19 |
| SHEET | 10 of 11 |

| NO. | DATE | REVISIONS |
|-----|--------|---------------------------|
| 1 | 3/9/11 | REVISE CLASSIC CRAFT DOOR |
| JK | | |
| BY | | |

| | |
|-------------------|--------------------------------------|
| PRODUCT: | THERMA TRU FIBERGLASS GLAZED DOOR |
| PART OR ASSEMBLY: | COMPONENTS |

Documents Prepared By:
RW BUILDING CONSULTANTS, INC.
 P.O. Box 230 Vairco FL 33595
 Phone No.: 813.659.9197
 Florida Board of Professional Engineers
 Certificate Of Authorization No. 9813
LFS 3.17.09
 Lyndon F. Schmidt, P.E. No. 43409

R:\A - Projects\Project Folders\proj_1401-1500\PE_1455\D_RWBC Drawings\FL-12334\FL-12334-16-20.dwg_D-11

| BILL OF MATERIALS | | |
|-------------------|--|--------------|
| ITEM | DESCRIPTION | MATERIAL |
| A | 1X BUCK SG >= 0.55 | WOOD |
| B | 2X BUCK SG >= 0.55 | WOOD |
| C | MAX. 1/4" SHIM SPACE | - |
| D | 1/4" X 2-3/4" PFH ELCO OR ITW CONCRETE SCREW | STEEL |
| E | MASONRY - 3,192 PSI MIN. CONCRETE CONFORMING TO ACI 301 OR HOLLOW BLOCK CONFORMING TO ASTM C90 | CONCRETE |
| G | 3/16" X 2-3/4" PFH ITW CONCRETE SCREW | STEEL |
| H | 1/4" x 3-1/4" PFH ITW CONCRETE SCREW | STEEL |
| I | 1/4" x 2-1/4" PFH ITW CONCRETE SCREW | STEEL |
| J | 1/4" X 3-3/4" PFH ELCO OR ITW CONCRETE SCREW | STEEL |
| K | #8 X 2-1/2" PFH WOOD SCREW | STEEL |
| L | #10 X 2-1/2" PFH WOOD SCREW | STEEL |
| 1 | EXTERIOR LITE FRAME | ALUM. |
| 2 | INTERIOR LITE FRAME | ALUM. |
| 3 | LITE FRAME TRIM | PVC |
| 4 | #10 X 1-1/2" PFH SM SCREW | STEEL |
| 7 | MEDIUM REACH COMPRESSION WEATHER-STRIP | FOAM |
| 8 | LONG REACH COMPRESSION WEATHER-STRIP | FOAM |
| 9 | 4" X 4" HINGE .097" THK. | STEEL |
| 10 | #10 X 3/4" PFH WOOD SCREW (HINGE TO FRAME) | STEEL |
| 11 | #10 X 1-1/2" PFH SMS | STEEL |
| 12 | #10 X 2" PFH WOOD SCREW | STEEL |
| 17 | PASSAGE LOCK - KWIKSET MODEL 200T - GRADE 2 | STEEL |
| 19 | HEADER JAMB SG >= 0.42 | WOOD |
| 20 | SIDE JAMB SG >= 0.42 | WOOD |
| 21 | KWIKSET DEADBOLT -SERIES 800- GRADE 1 | STEEL |
| 23 | ASTRAGAL | ALUMINUM |
| 24 | ASTRAGAL FLUSH BOLT | STEEL |
| 25 | ASTRAGAL FLUSH BOLT RETAINER | ALUMINUM |
| 27 | LATCH STRIKE PLATE | STEEL |
| 28 | MULTI-POINT STRIKE PLATE | STEEL |
| 32 | DOOR BOTTOM SWEEP | PVC |
| 33 | INSWING THRESHOLD | ALUM.COMP. |
| 35 | 7/16" X 1/2" STAPLE | STEEL |
| 39 | PANEL REINFORCEMENT 0.023" THK. | STEEL |
| 40 | FIBERGLASS DOOR PANEL W/STEEL REINFORCEMENT(SMOOTH STAR) | FIBERGLASS |
| 44 | HINGE STILE | COMP. |
| 45 | BOTTOM RAIL | COMP. |
| 46 | INSULATING FOAM CORE | POLYURETHANE |
| 47 | LOCK STILE | LVL/WOOD |
| 48 | TOP RAIL | COMP. |
| 49 | SMOOTHSTAR DOOR SKIN .065" MINIMUM THK. FIBERGLASS | FIBERGLASS |

| BILL OF MATERIALS | | |
|-------------------|--|------------|
| ITEM | DESCRIPTION | MATERIAL |
| 50 | FIBERGLASS DOOR PANEL W/STEEL REINFORCEMENT (FIBER CLASSIC) | FIBERGLASS |
| 51 | FIBER CLASSIC DOOR SKIN .110" MINIMUM THK. FIBERGLASS | FIBERGLASS |
| 52 | TOP RAIL | COMP. |
| 54 | HINGE STILE | LVL/WOOD |
| 55 | BOTTOM RAIL | COMP. |
| 57 | LOCK STILE | LVL/WOOD |
| 60 | FIBERGLASS DOOR PANEL W/STEEL REINFORCEMENT (CLASSIC CRAFT) | FIBERGLASS |
| 61 | CLASSIC CRAFT DOOR SKIN .125" MINIMUM THK. FIBERGLASS | FIBERGLASS |
| 62 | TOP RAIL | COMP. |
| 64 | HINGE STILE | WOOD |
| 65 | BOTTOM RAIL | COMP. |
| 67 | LOCK STILE | LVL/WOOD |
| 70 | FIBERGLASS DOOR PANEL W/STEEL REINFORCEMENT (CLASSIC CRAFT RUSTIC) | FIBERGLASS |
| 71 | CLASSIC CRAFT RUSTIC DOOR SKIN .125" MINIMUM THK. FIBERGLASS | FIBERGLASS |
| 72 | TOP RAIL | COMP. |
| 75 | BOTTOM RAIL | COMP. |
| 77 | HINGE AND LOCK STILE | WOOD |
| 78 | ASTRAGAL AND SHOOTBOLT STRIKE PLATE | STEEL |

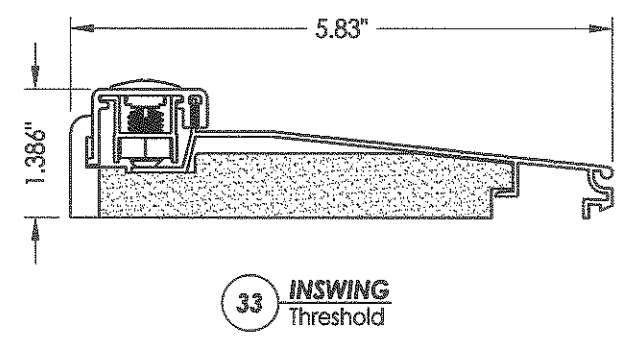
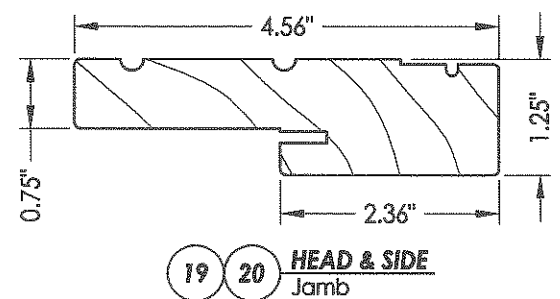

Documents Prepared By: **RW** BUILDING CONSULTANTS, INC.
P.O. Box 230 Vairico FL 33595
Phone No.: 813.659.9197
Florida Board of Professional Engineers
Certificate of Authorization No. 9813
3-17-11
Lyndon F. Schmidt, P.E. No. 43409

PRODUCT: THERMA TRU FIBERGLASS GLAZED DOOR
PART OR ASSEMBLY: BILL OF MATERIALS

| NO. | DATE | REVISIONS | JK | BY |
|-----|--------|---------------------------|----|----|
| 1 | 3/9/11 | REVISE CLASSIC CRAFT DOOR | JK | BY |

DATE: 3/17/09
SCALE: N.T.S.
DWG. BY: JK
CHK. BY: LFS
DRAWING NO.: FL-12334.19
SHEET 11 OF 11

© 2009 R.W. BUILDING CONSULTANTS INC.