

THERMA TRU®

THERMA TRU DOORS

118 INDUSTRIAL DR., EDGERTON, OH 43517

"SMOOTH STAR", "FIBER CLASSIC", "CLASSIC CRAFT" & "CLASSIC CRAFT RUSTIC"

FIBERGLASS GLAZED DOOR IN SWING / OUT SWING "IMPACT"

GENERAL NOTES

1. This product has been evaluated and is in compliance with the 2007 Florida Building Code (FBC) structural requirements including the "High Velocity Hurricane Zone" (HVHZ).
2. Product anchors shall be as listed and spaced as shown on details. Anchor embedment to base material shall be beyond wall dressing or stucco.
3. When used in the "HVHZ" this product complies with section 1626 of the Florida Building Code and does not require an impact resistant covering.
4. When used in areas outside of the "HVHZ" requiring wind borne debris protection this product complies with Section 1609.1.2 of the 2007 FBC and does not require an impact resistant covering. This product meets missile level "D" and includes Wind Zone 4 as defined in ASTM E1996.
5. For 2x stud framing construction, anchoring of these units shall be the same as that shown for 2x buck masonry construction.
6. Site conditions that deviate from the details of this drawing require further engineering analysis by a licensed engineer or registered architect.
7. Outswing configurations using coastal outswing item #31 meet water infiltration requirements for "HVHZ".
8. Inswing configurations and outswing configurations using item #18,#14,#15,#16,#34 and item #37 do not meet the water infiltration requirements for the "HVHZ" and shall be installed only in non-habitable areas or at habitable locations protected by an overhang or canopy such that the angle between the edge of canopy or overhang to sill is less than 45 degrees."

TABLE OF CONTENTS

SHEET #	DESCRIPTION	SHEET #	DESCRIPTION
1	Typical elevations, design pressures & general notes	7	Vertical cross sections
2	Door panel details & glazing details (Smooth Star)	8	Buck and frame anchoring 2X buck masonry construction
3	Door panel details (Fiber Classic)	9	Frame anchoring 1X buck masonry construction
4	Door panel details (Classic Craft)	10	Components
5	Door panel details (Classic Craft Rustic)	11	Bill of materials
6	Horizontal cross sections		

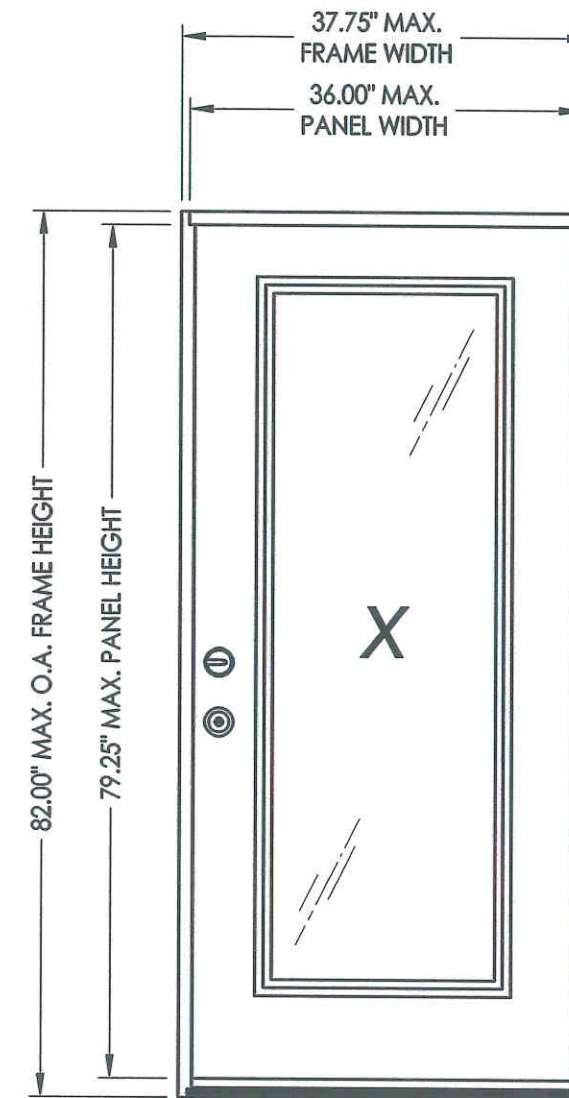

SWING	OVERALL FRAME DIMENSION	DESIGN PRESSURE (PSF)	
		POSITIVE	NEGATIVE
IN SWING	37.75" x 82.00"	+55.0	-55.0
OUT SWING	37.75" x 80.62"	+55.0	-55.0

Documents Prepared By:
RW BUILDING CONSULTANTS, INC.
 P.O. Box 230 Valrico FL 33595
 Phone No.: 813.659.9197
 Florida Board of Professional Engineers
 Certificate Of Authorization No. 9813
 1702 7.16.11
 Lyndon F. Schmidt, P.E. No. 43409

PRODUCT: THERMA TRU FIBERGLASS GLAZED DOOR
 PART OR ASSEMBLY: TYPICAL ELEVATION, DESIGN PRESSURES & GENERAL NOTES

NO.	DATE	BY	REVISIONS
1	3/9/11	JK	REVISE CLASSIC CRAFT DOOR

DATE: 6/25/08
 SCALE: N.T.S.
 DWG. BY: JK
 CHK. BY: LFS
 DRAWING NO.: FL-10975.1
 SHEET 1 OF 11

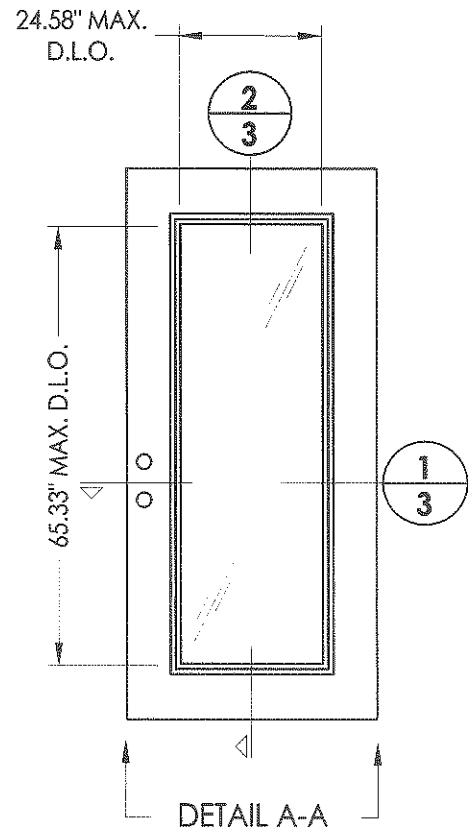

50 DOOR PANEL
Fiber classic

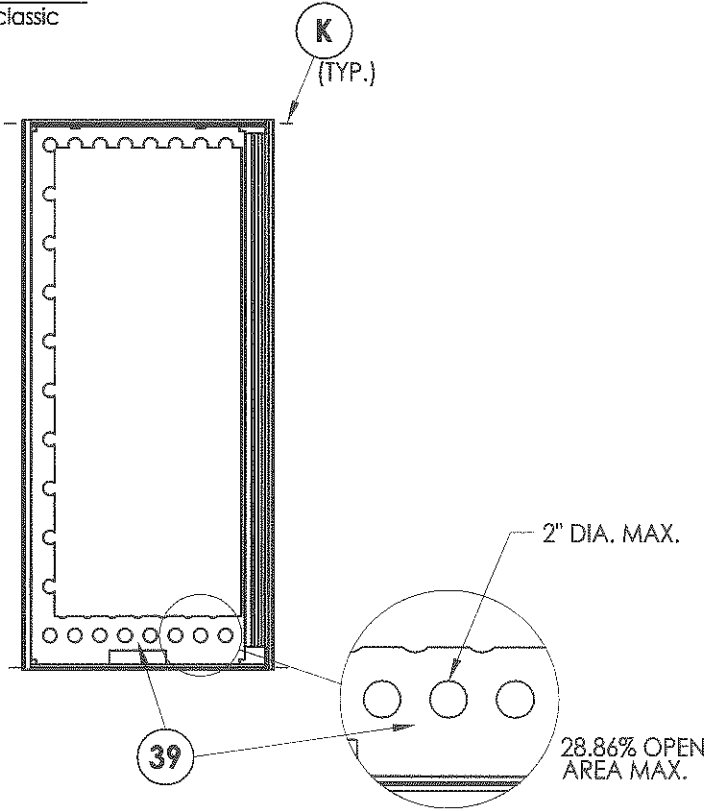

DETAIL A-A
Panel reinforcement

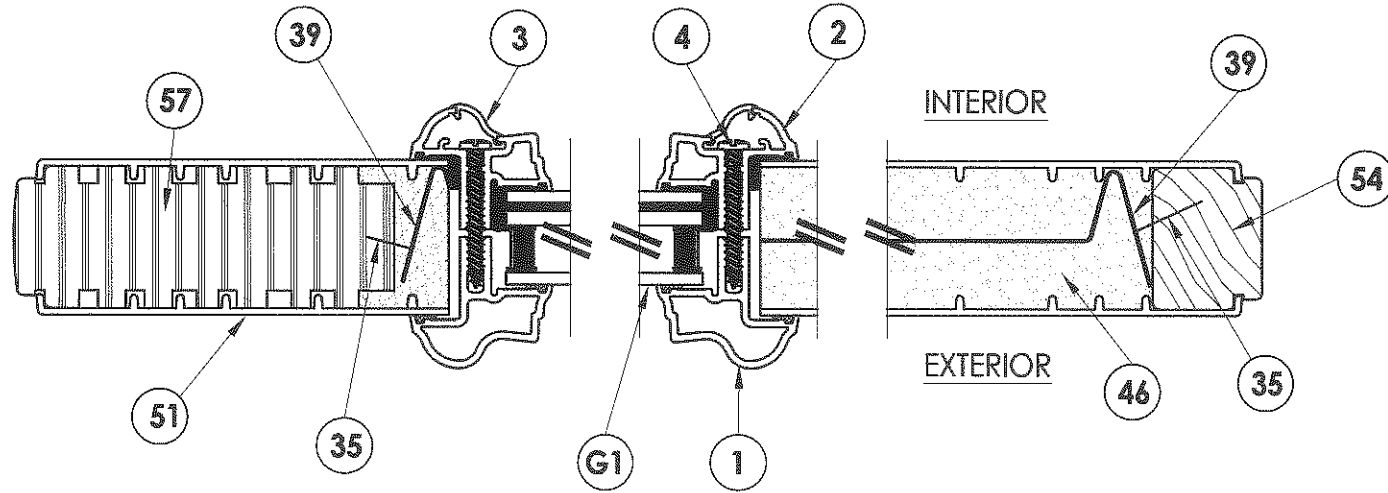

1
3 **HORIZONTAL CROSS SECTION**

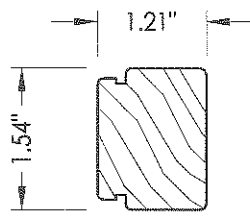

54 HINGE STILE

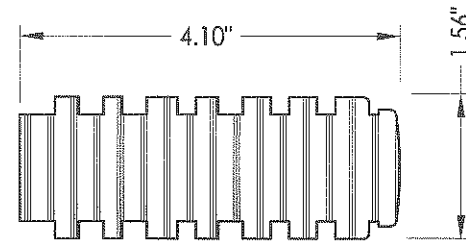

57 LOCK STILE

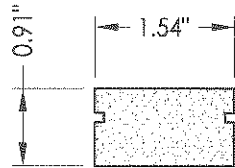

52 TOP RAIL

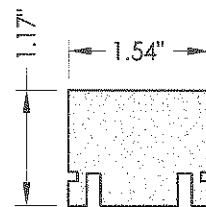

55 BOTTOM RAIL

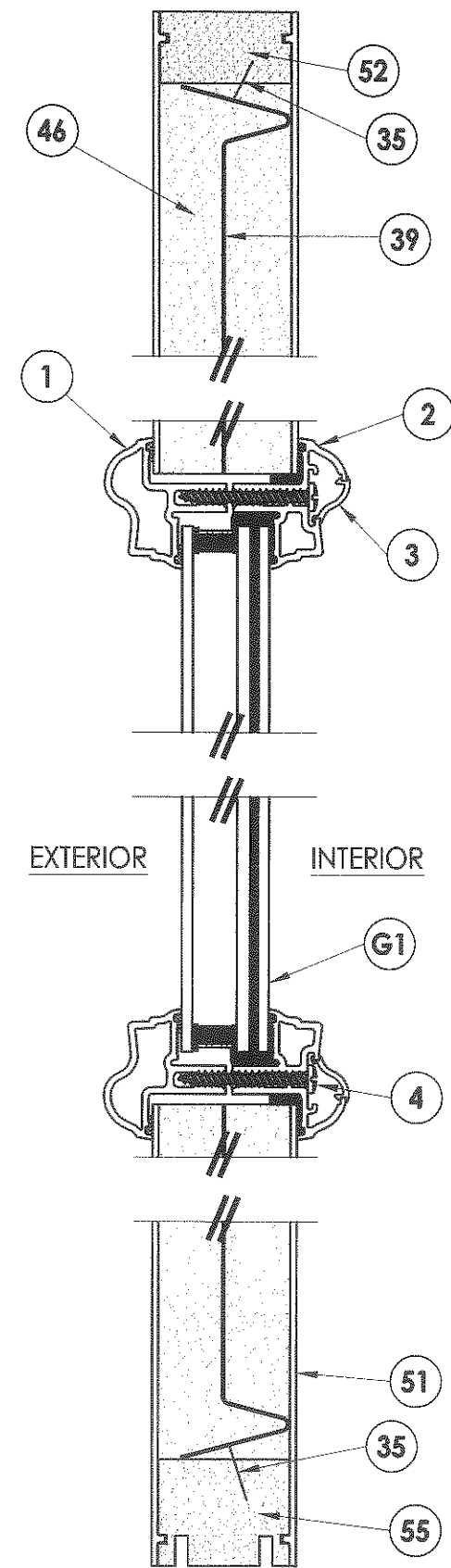

2
3 **VERTICAL CROSS SECTION**

Documents Prepared By:

RW BUILDING CONSULTANTS, INC.
P.O. Box 230 Valrico FL 33595
Phone No.: 813.659.9197
Florida Board of Professional Engineers
Certificate Of Authorization No. 9813
3-16-11
Lyndon F. Schmidt, P.E. No. 43409

PRODUCT: **THERMA-TRU**
FIBERGLASS GLAZED DOOR
PART OR ASSEMBLY:
DOOR PANEL DETAILS
(FIBER CLASSIC)

NO.	DATE	BY	REVISIONS
1	3/9/11	JK	REVISE CLASSIC CRAFT DOOR

DATE: 6/25/08
SCALE: N.T.S.
DWG. BY: JK
CHK. BY: LFS
DRAWING NO.: FL-10975.1
SHEET 3 OF 11

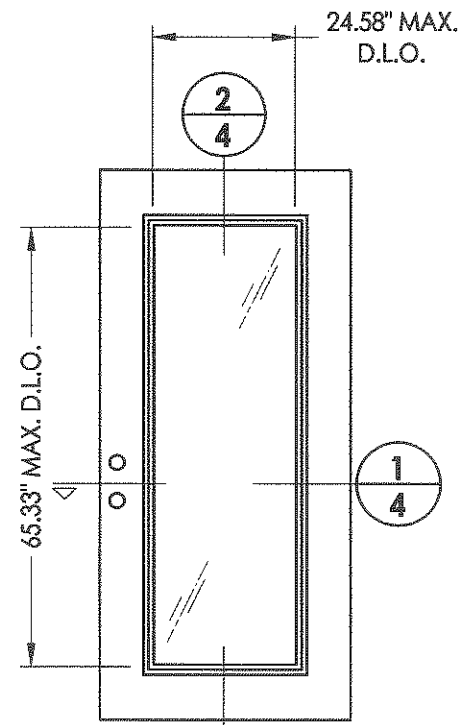

60 DOOR PANEL
Classic craft

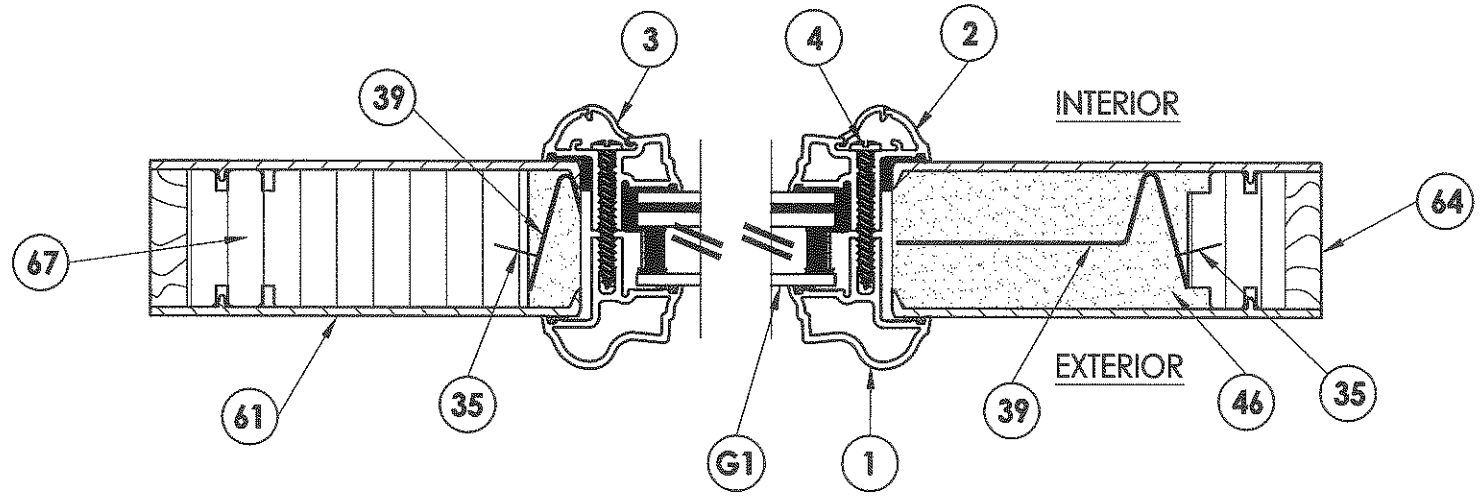

1/4 HORIZONTAL CROSS SECTION

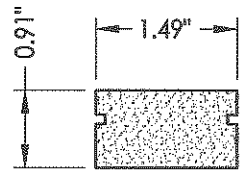

62 TOP RAIL

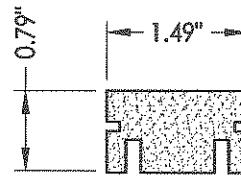

65 BOTTOM RAIL

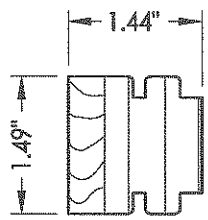

64 HINGE STILE

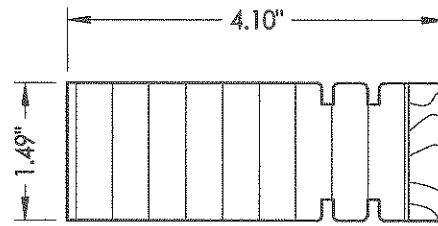

67 LOCK STILE

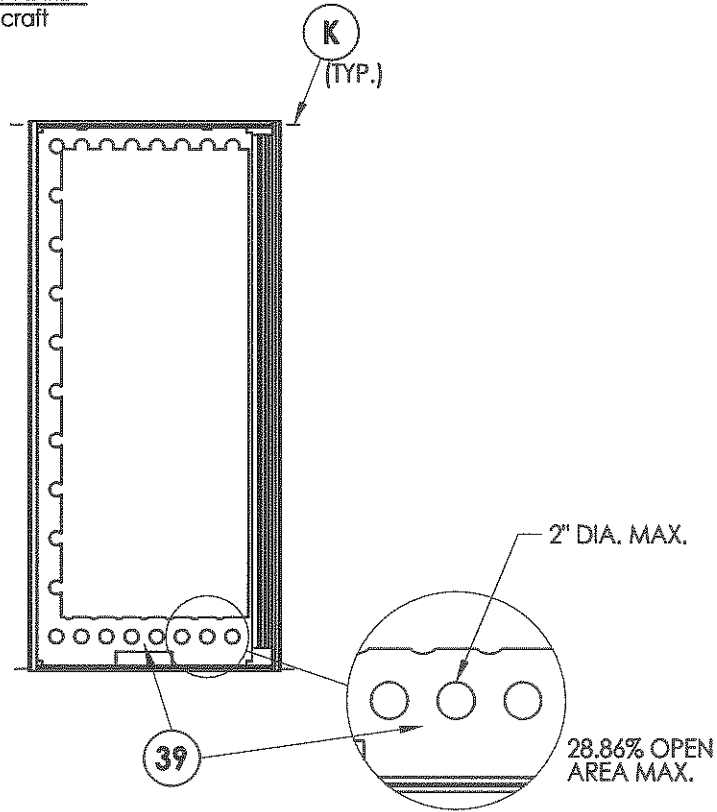

DETAIL A-A
Panel reinforcement

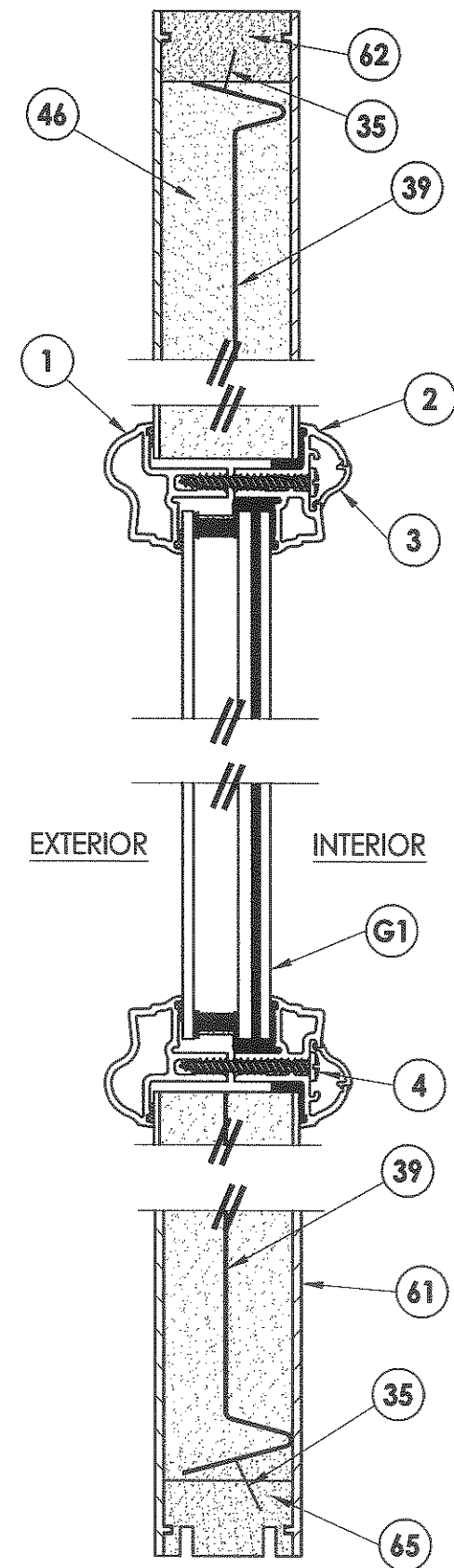

2/4 VERTICAL CROSS SECTION

Documents Prepared By:

RW BUILDING CONSULTANTS, INC.
P.O. Box 230 Valrico FL 33595
Phone No.: 813.659.9197
Florida Board of Professional Engineers
Certificate of Authorization No. 9813
L7R2316.1
Lyndon F. Schmidt, P.E. No. 43409

PRODUCT:
THERMA-TRU
FIBERGLASS GLAZED DOOR

PART OR ASSEMBLY:
DOOR PANEL DETAILS
(CLASSIC CRAFT)

NO.	DATE	REVISIONS	JK	BY
1	3/9/11	REVISE CLASSIC CRAFT DOOR	JK	BY

DATE: 6/25/08
SCALE: N.T.S.
DWG. BY: JK
CHK. BY: LFS
DRAWING NO.: FL-10975.1
SHEET 4 OF 11

R:\A - Projects\Project Folders\Proj 1301-1400\PE 1390\ID. RWBC Drawings\FL-10975.1-5.dwg, 5.1

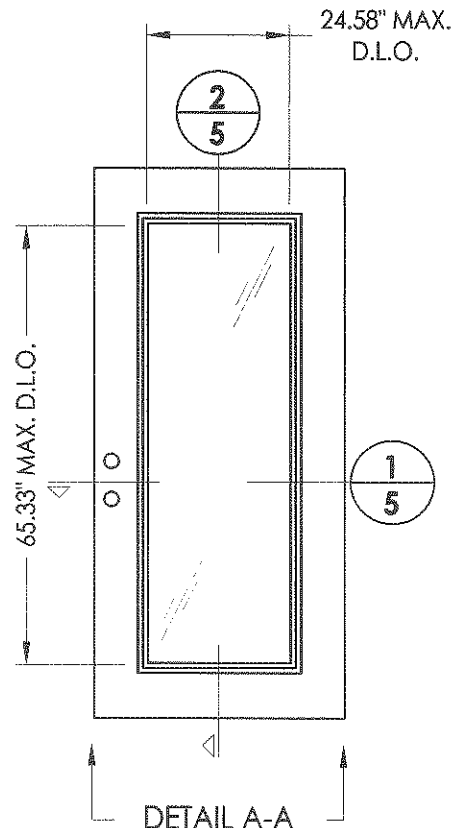

70 DOOR PANEL
Classic craft rustic

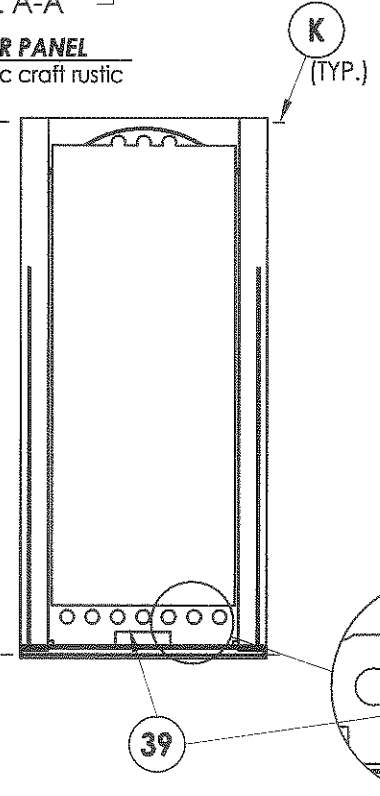

DETAIL A-A
Panel reinforcement

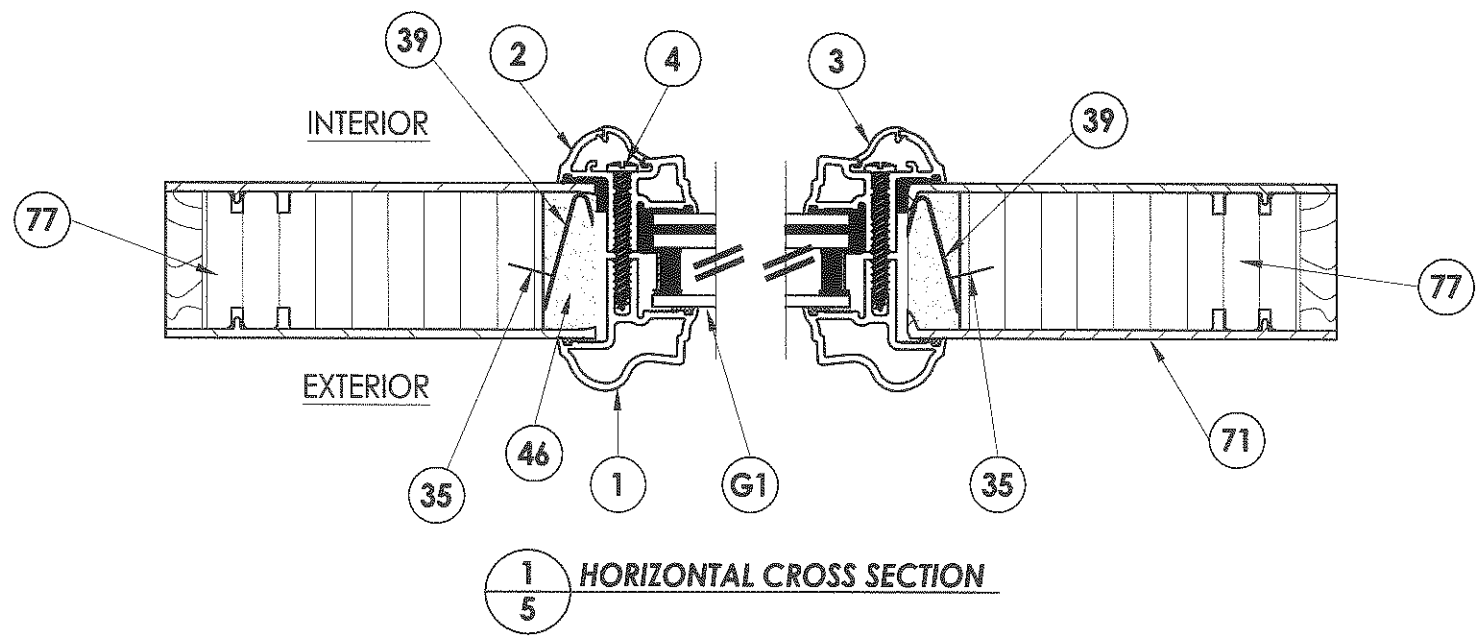

1 HORIZONTAL CROSS SECTION

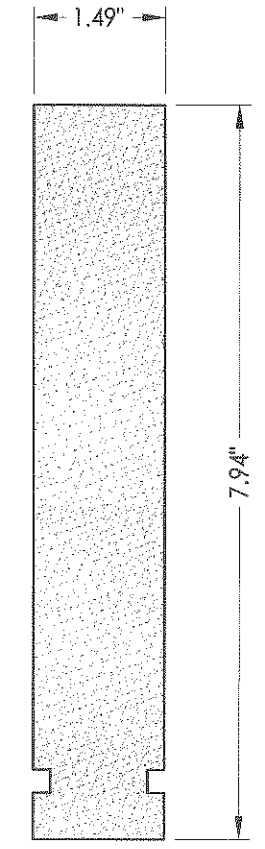

72 TOP RAIL

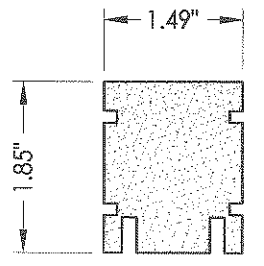

75 BOTTOM RAIL

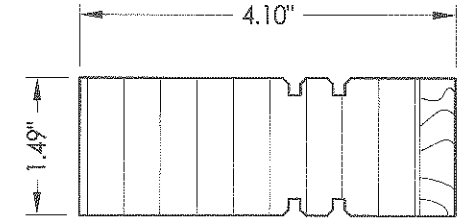

77 HINGE AND LOCK STILE

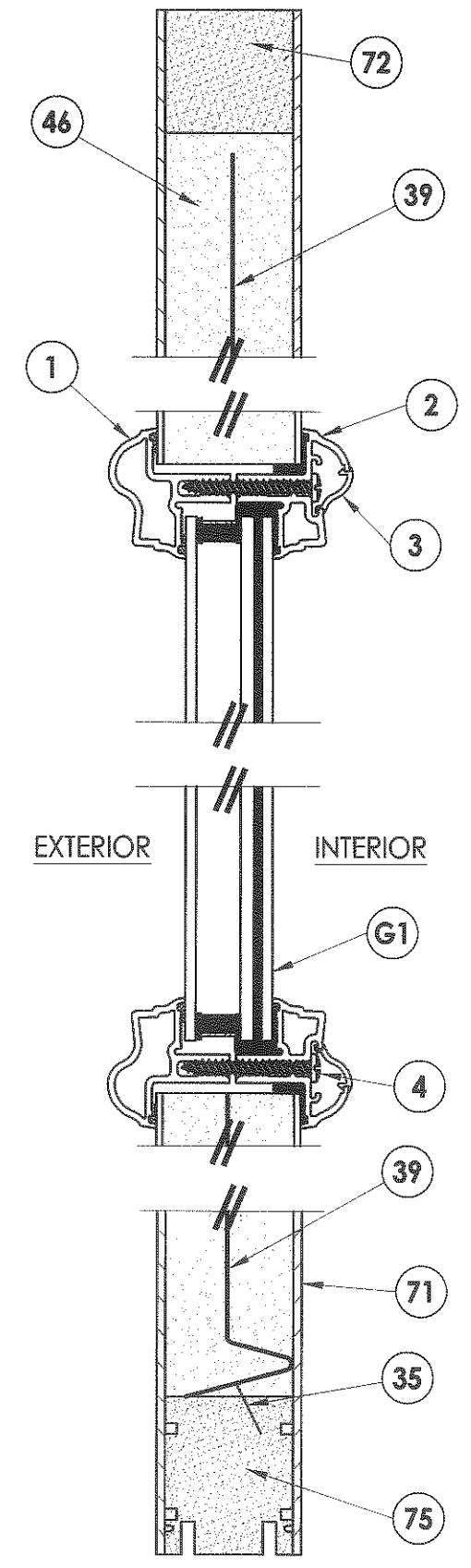

2 VERTICAL CROSS SECTION

Documents Prepared By:

RW BUILDING CONSULTANTS, INC.
P.O. Box 230 Valrico FL 33595
Phone No.: 813.659.9197
Florida Board of Professional Engineers
Certificate Of Authorization No. 9813
L7SL 3/16/11
Lyndon F. Schmidt, P.E. No. 43409

PRODUCT: THERMA-TRU
FIBERGLASS GLAZED DOOR
PART OR ASSEMBLY:
DOOR PANEL DETAILS
(CLASSIC CRAFT RUSTIC)

NO.	DATE	REVISIONS	JK	BY
1	3/9/11	REVISE CLASSIC CRAFT DOOR	JK	BY

DATE: 6/25/08
SCALE: N.T.S.
DWG. BY: JK
CHK. BY: LFS
DRAWING NO.: FL-10975.1
SHEET 5 OF 11

R:\A - Projects\Project Folders\Proj 1301-1400\PF 1390\D. RWBC Drawings\FL-10975.1-5.dwg, 6.1

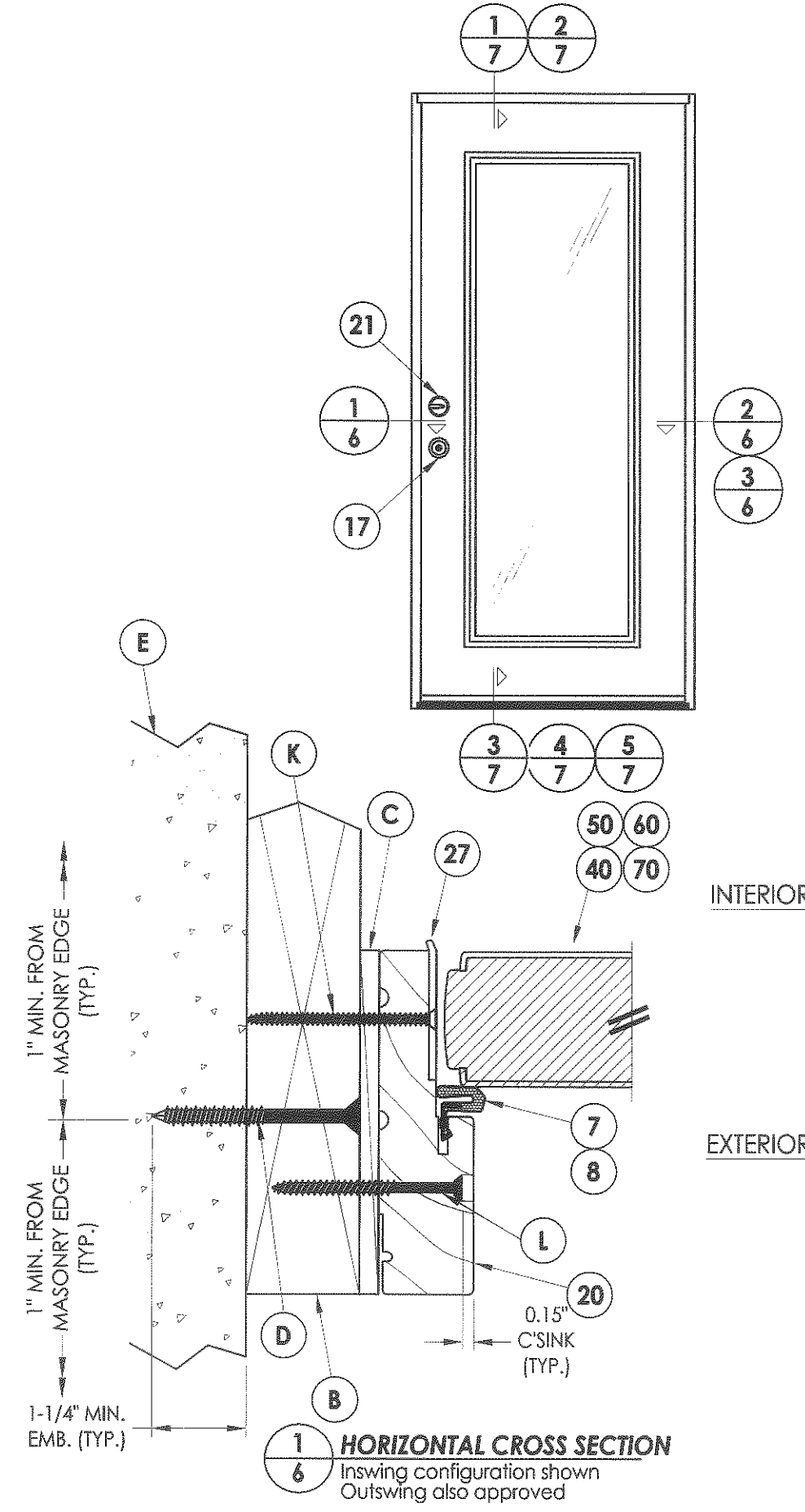

1
6 **HORIZONTAL CROSS SECTION**
Inswing configuration shown
Outswing also approved

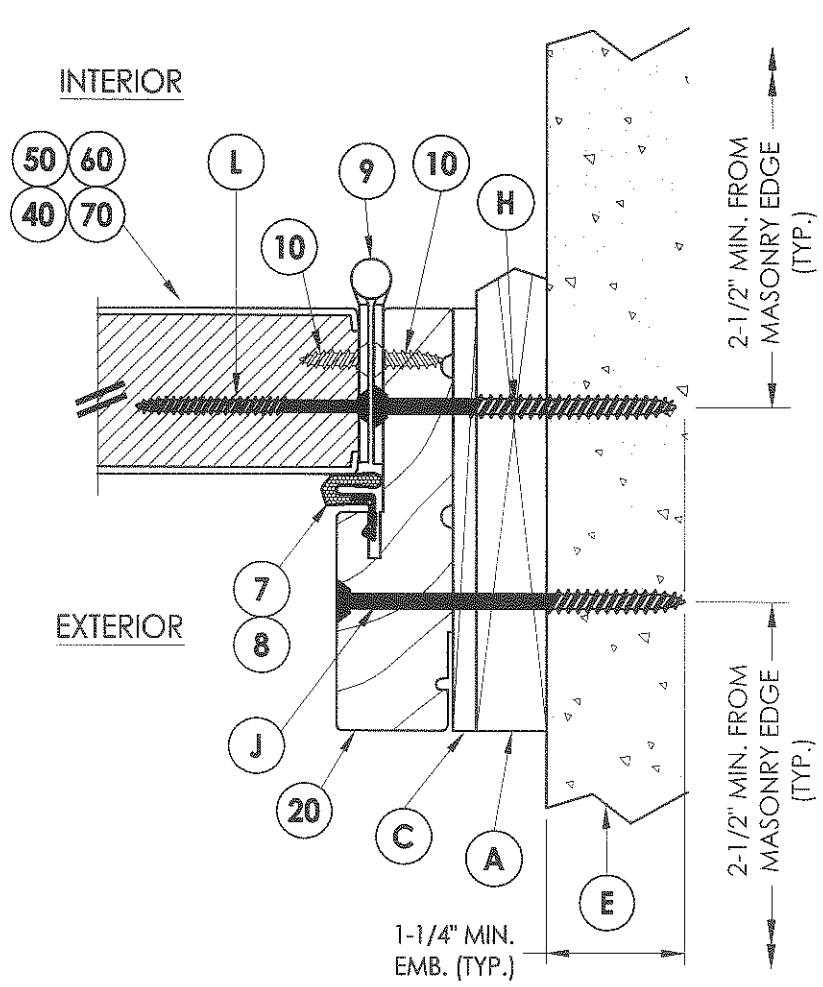

3
6 **HORIZONTAL CROSS SECTION**
Shown w/IX sub-buck substituting
concrete screws for wood screws per
Section 1714.5.4.2 of the FBC

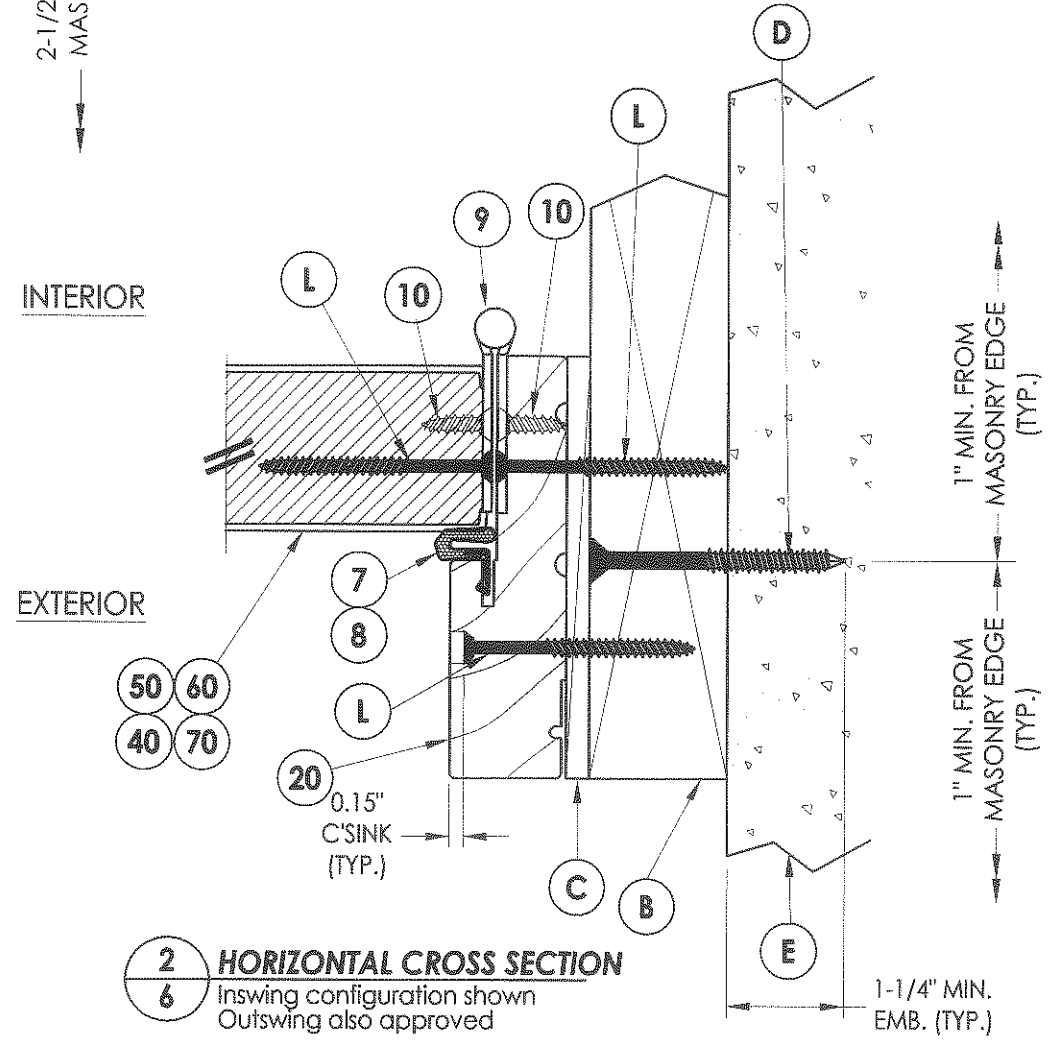

2
6 **HORIZONTAL CROSS SECTION**
Inswing configuration shown
Outswing also approved

Documents Prepared By:		BUILDING CONSULTANTS, INC. P.O. Box 230 Valrico FL 33595 Phone No.: 813.659.9197	
PRODUCT:		THERMA TRU FIBERGLASS GLAZED DOOR	
PART OR ASSEMBLY:		HORIZONTAL CROSS SECTIONS	
NO.	DATE	JK	BY
1	3/9/11	REVISE CLASSIC CRAFT DOOR	
REVISIONS			
DATE:		6/25/08	
SCALE:		N.T.S.	
DWG. BY:		JK	
CHK. BY:		LFS	
DRAWING NO.:		FL-10975.1	
SHEET		6 OF 11	

© 2009 R.W. BUILDING CONSULTANTS INC. Lyndon F. Schmidt, P.E. No. 43409

R:\A - Projects\Project Folders\Proj 1301-1400\PF 1390\D. RWBC Drawings\FL-10975.1-5.dwg, 7.1

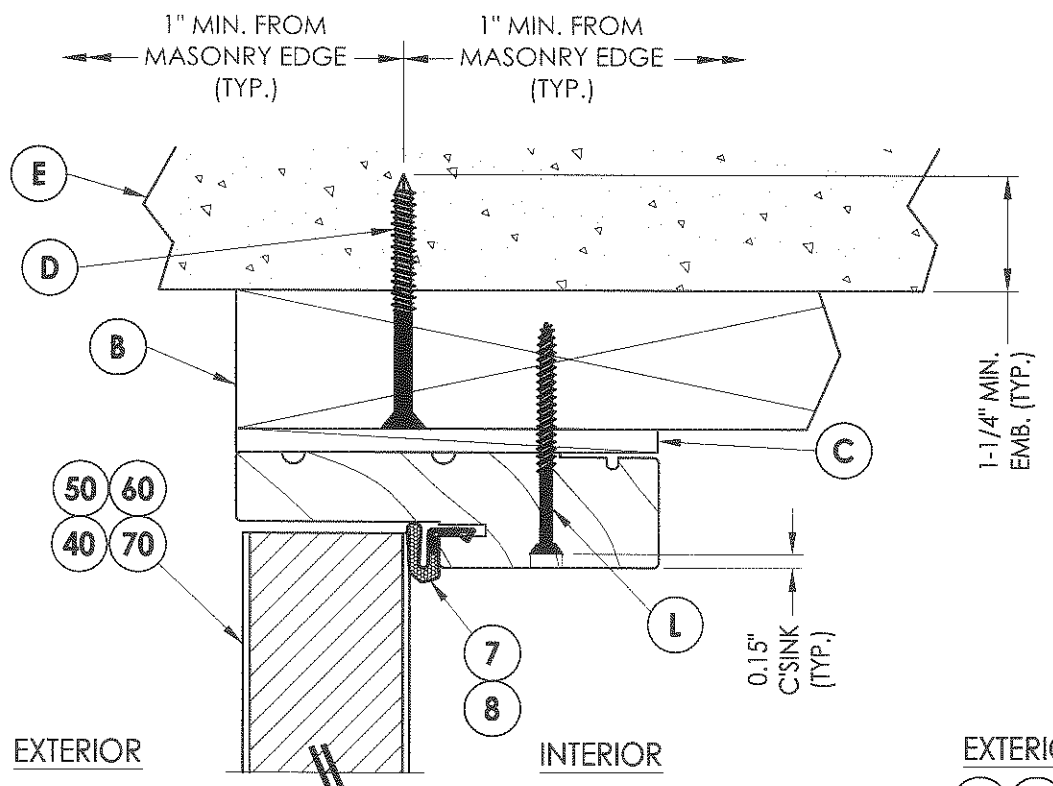

1 **VERTICAL CROSS SECTION**
7 Outswing configuration shown
 Inswing also approved

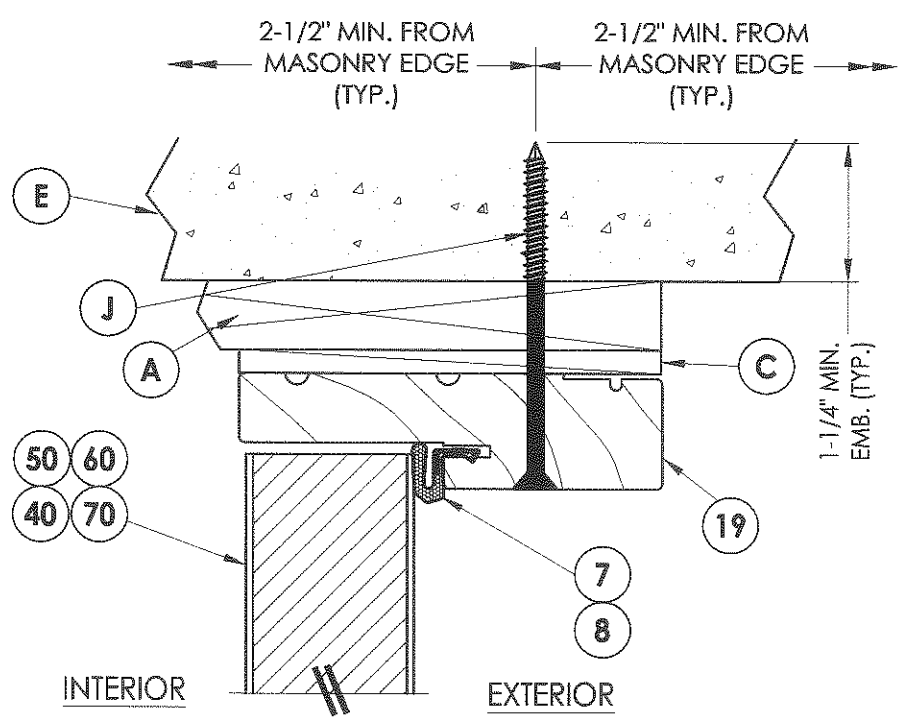

2 **VERTICAL CROSS SECTION**
7 Shown w/1X sub-buck substituting
 concrete screws for wood screws per
 Section 1714.5.4.2 of the FBC

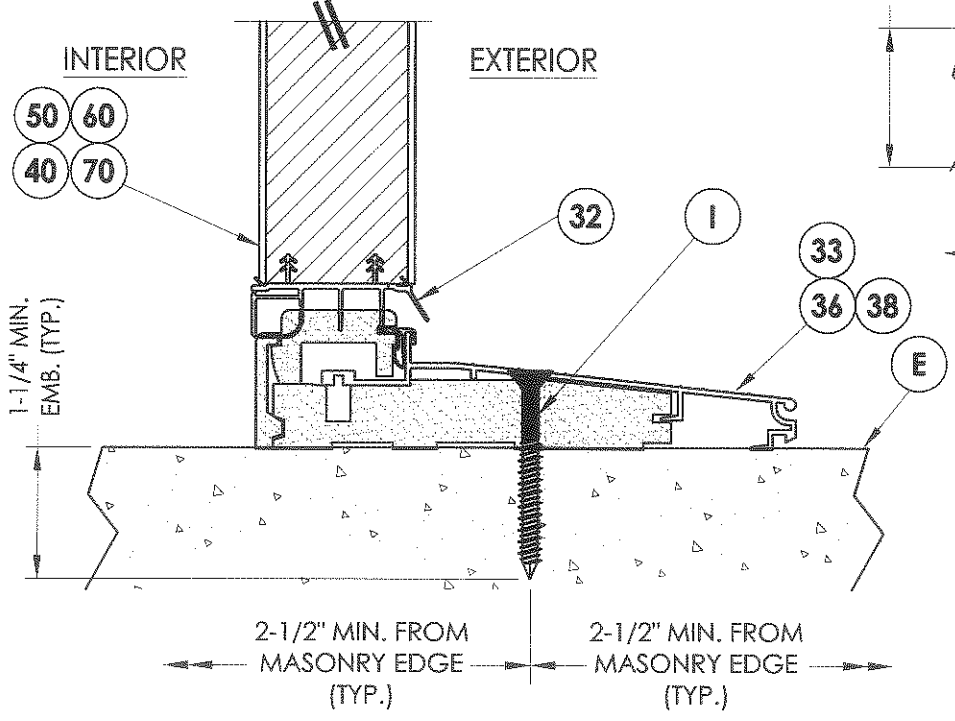

3 **VERTICAL CROSS SECTION**
7 Inswing configuration
 see general notes, sheet 1
 for "HVHZ" water infiltration
 requirements

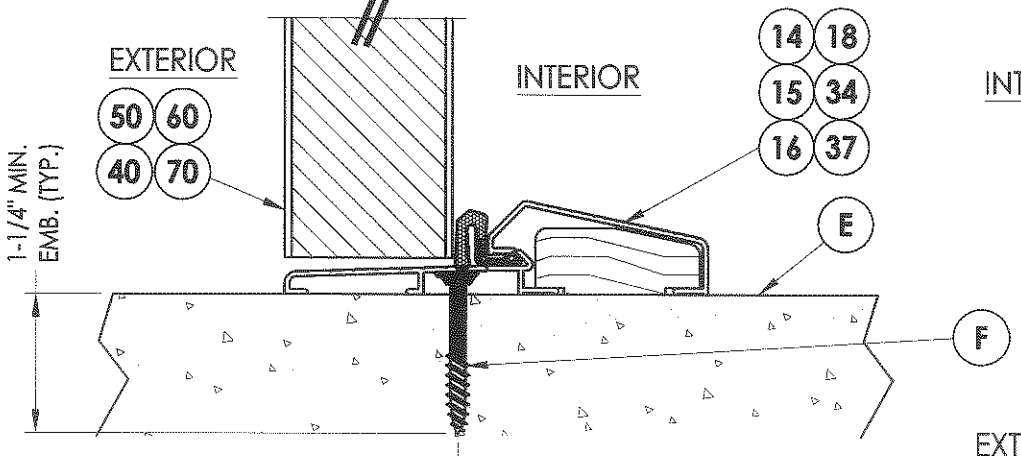

4 **VERTICAL CROSS SECTION**
7 Outswing configuration
 see general notes, sheet 1
 for "HVHZ" water infiltration
 requirements

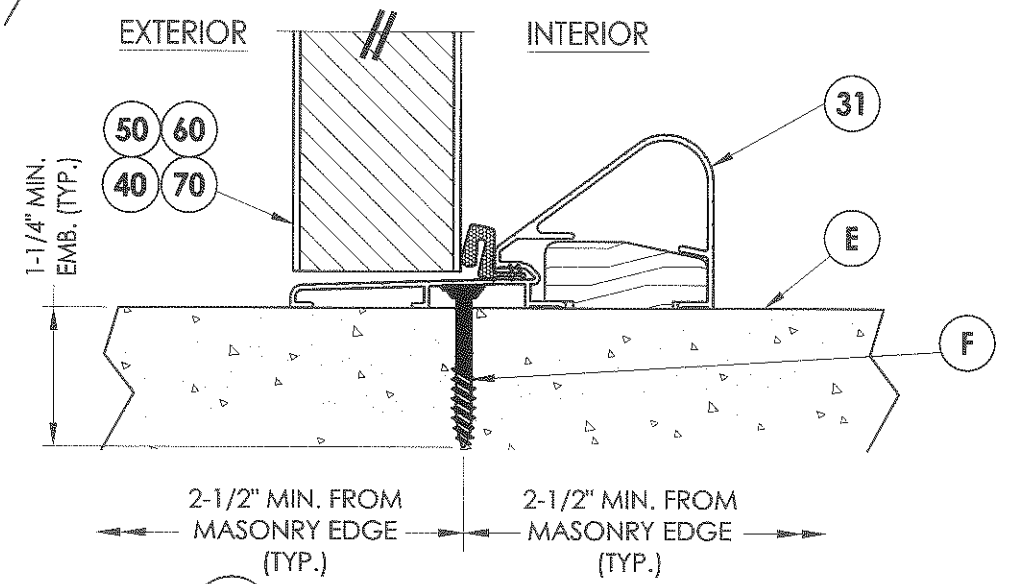

5 **VERTICAL CROSS SECTION**
7 Outswing configuration
 see general notes, sheet 1
 for "HVHZ" water infiltration
 requirements

Documents Prepared By:
RW BUILDING CONSULTANTS, INC.
 P.O. Box 230 Valrico FL 33595
 Phone No.: 813.659.9197
 Florida Board of Professional Engineers
 Certificate Of Authorization No. 9813
 3-16-11
 Lyndon F. Schmidt, P.E. No. 43409

PRODUCT:
 THERMA TRU
 FIBERGLASS GLAZED DOOR
 PART OR ASSEMBLY:
 VERTICAL
 CROSS SECTIONS

REVISIONS	
NO	DATE
1	3/9/11
	REVISE CLASSIC CRAFT DOOR
	JK BY

DATE: 6/25/08
 SCALE: N.T.S.
 DWG. BY: JK
 CHK. BY: LFS
 DRAWING NO.:
 FL-10975.1
 SHEET 7 OF 11

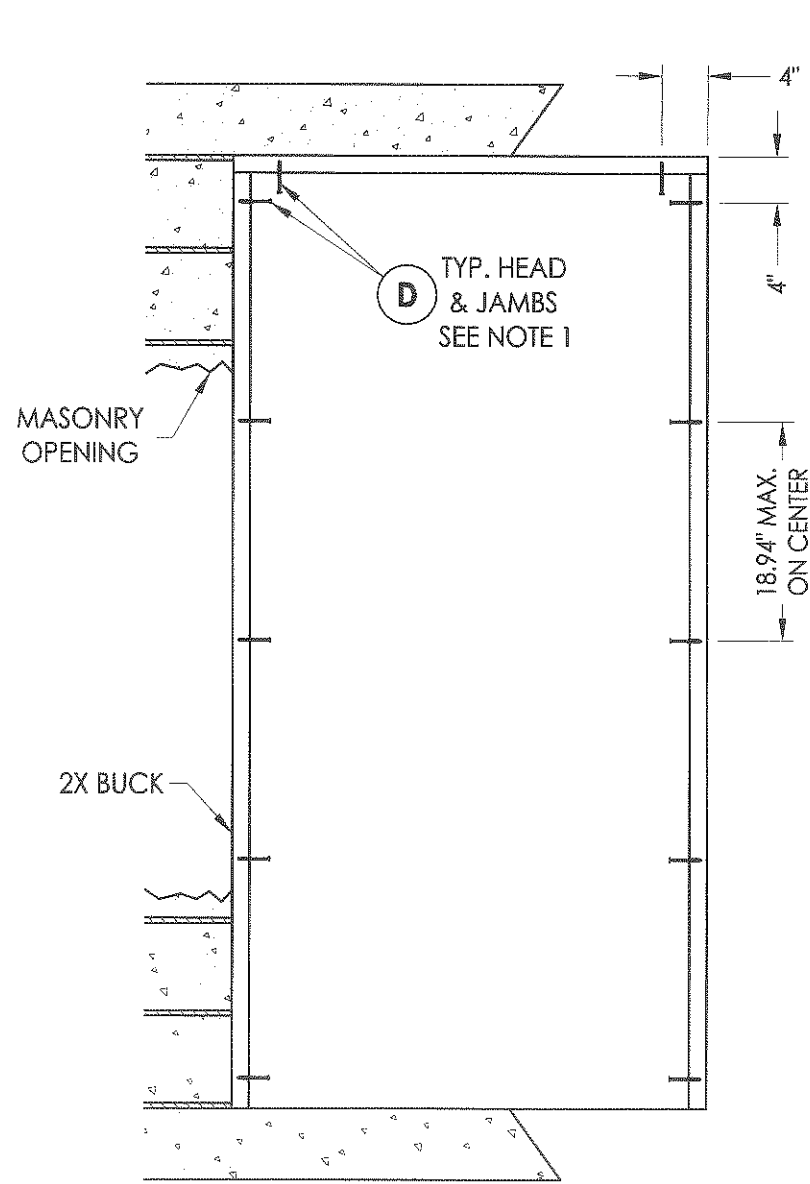

BUCK ANCHORING

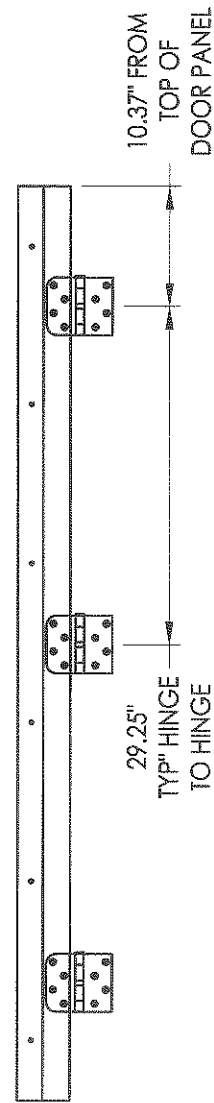

HINGE JAMB

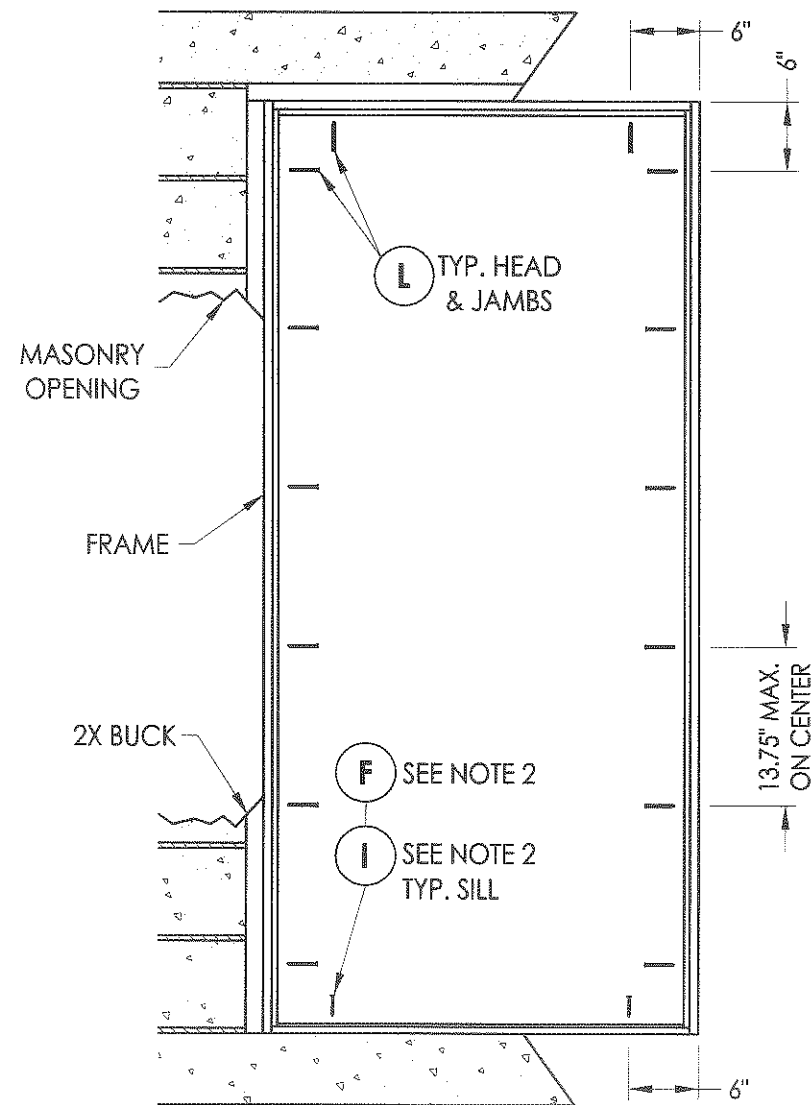

FRAME ANCHORING
Masonry 2X buck construction

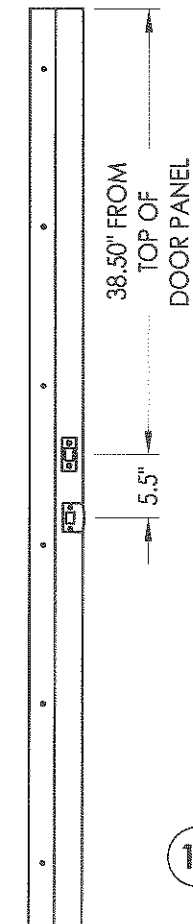

STRIKE JAMB

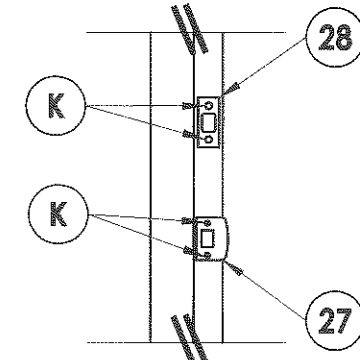

LATCH & DEADBOLT DETAIL

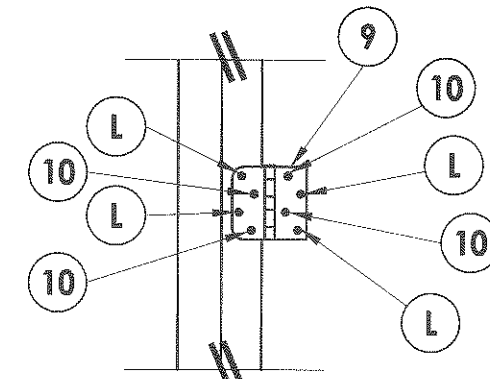

HINGE DETAIL
Inswing

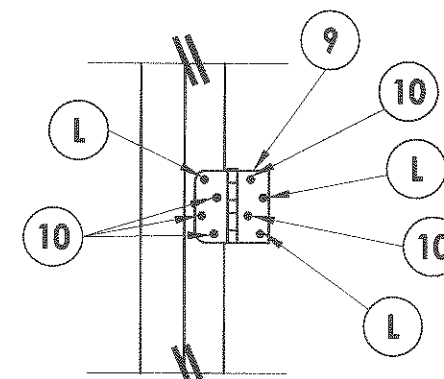

HINGE DETAIL
Outswing

NOTES:

- 1/4" Elco Concrete screws anchoring 2x buck require a minimum 1" clearance to masonry edges, a 1-1/4" minimum embedment and a minimum 4" clearance to adjacent concrete screws. Substitution of equal concrete screws from a different supplier may have different edge distance and center distance requirements. Concrete screw locations at the corners may be adjusted to maintain the minimum edge distance to mortar joints. If Concrete screw locations noted as "MAX. ON CENTER" must be adjusted to maintain the minimum edge distance to mortar joints, additional Concrete screws may be required to ensure the maximum on center dimension is not exceeded.
- 1/4" ITW concrete screws anchoring frame and/or sill require a minimum 2-1/2" clearance to masonry edges, a 1-1/4" minimum embedment and a minimum 3" clearance to adjacent concrete screws. Substitution of equal concrete screws from a different supplier may have different edge distance and center distance requirements. Concrete screw locations at the corners may be adjusted to maintain the minimum edge distance to mortar joints. If Concrete screw locations noted as "MAX. ON CENTER" must be adjusted to maintain the minimum edge distance to mortar joints, additional Concrete screws may be required to ensure the maximum on center dimension is not exceeded.

Documents Prepared By:
RW BUILDING CONSULTANTS, INC.
 P.O. Box 230 Vero Beach, FL 33585
 Phone No.: 813.659.9197
 Florida Board of Professional Engineers
 Certificate Of Authorization No. 9813
 1756 3-16-11
 Lyndon F. Schmidt, P.E. No. 43409

PRODUCT: THERMA TRU FIBERGLASS GLAZED DOOR
 PART OR ASSEMBLY: BUCK AND FRAME ANCHORING 2X BUCK MASONRY CONSTRUCTION

REVISIONS	
NO.	DATE
1	3/9/11
	REVISE CLASSIC CRAFT DOOR
	BY JK

DATE: 6/25/08
 SCALE: N.T.S.
 DWG. BY: JK
 CHK. BY: LFS
 DRAWING NO.: FL-10975.1
 SHEET 8 OF 11

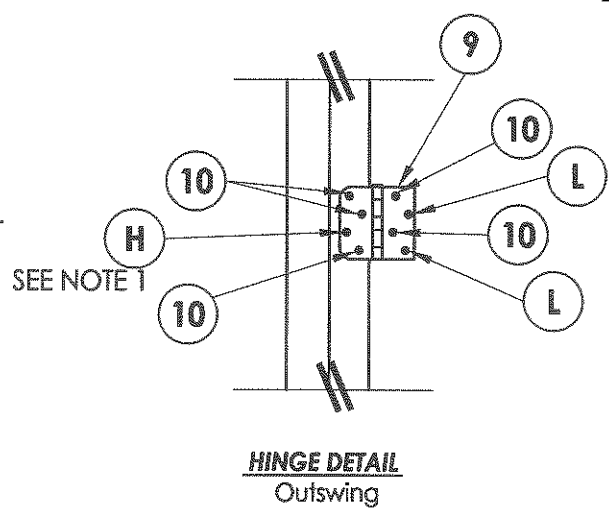
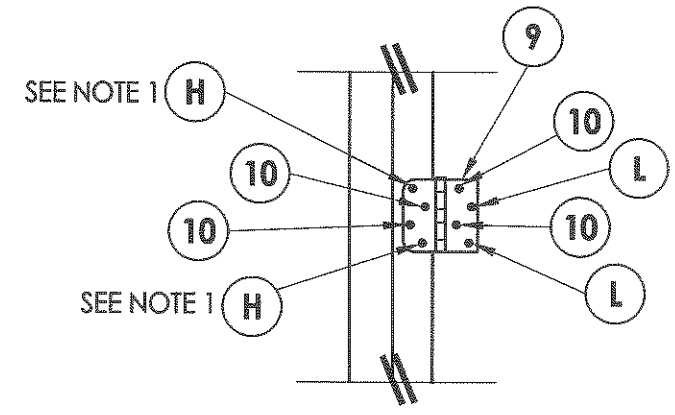
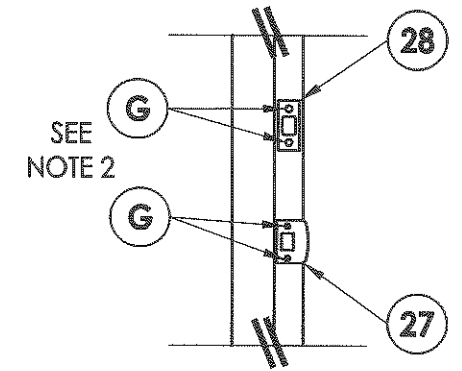
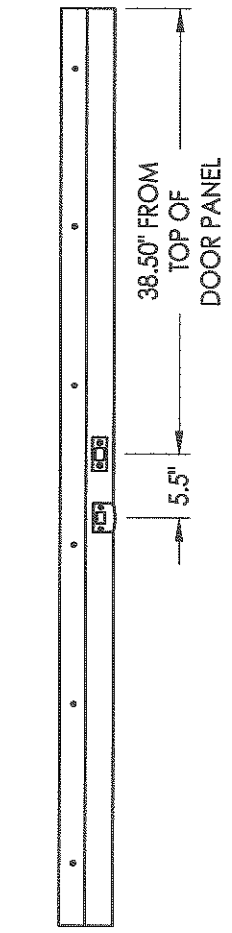
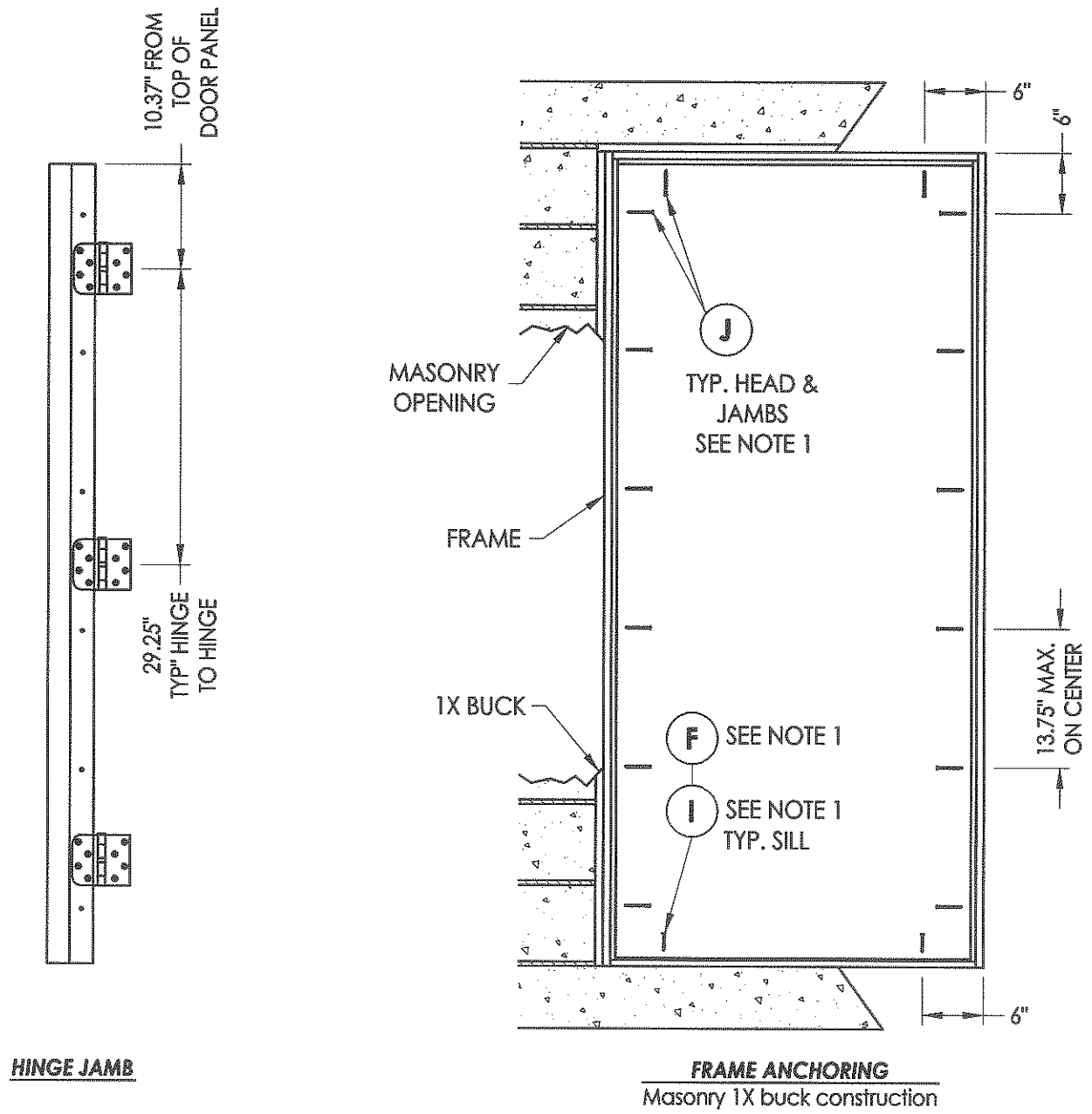

- NOTES:**
- 1/4" ITW concrete screws anchoring frame and/or sill require a minimum 2-1/2" clearance to masonry edges, a 1-1/4" minimum embedment and a minimum 3" clearance to adjacent concrete screws. Substitution of equal concrete screws from a different supplier may have different edge distance and center distance requirements. Concrete screw locations at the corners may be adjusted to maintain the minimum edge distance to mortar joints. If Concrete screw locations noted as "MAX. ON CENTER" must be adjusted to maintain the minimum edge distance to mortar joints, additional Concrete screws may be required to ensure the maximum on center dimension is not exceeded.
 - 3/16" ITW concrete screws anchoring frame and/or sill require a minimum 2-5/8" clearance to masonry edges, a 1-1/4" minimum embedment and a minimum 2-1/4" clearance to adjacent concrete screws unless otherwise noted by concrete screw manufacturer.

Documents Prepared By:		RW BUILDING CONSULTANTS, INC. P.O. Box 230 Valrico FL, 33595 Phone No.: 813.659.9197 Florida Board of Professional Engineers Certificate Of Authorization No. 9613 <i>LFS</i> 3-16-11 Lyndon F. Schmidt, P.E. No. 43409	
PRODUCT:	THERMA TRU FIBERGLASS GLAZED DOOR		
PART OR ASSEMBLY:	FRAME ANCHORING 1X BUCK MASONRY CONSTRUCTION		
		JK	BY
		1	3/9/11
		NO.	DATE
		REVISIONS	
		DATE: 6/25/08	
		SCALE: N.T.S.	
		DWG. BY: JK	
		CHK. BY: LFS	
		DRAWING NO.: FL-10975.1	
		SHEET 9 OF 11	

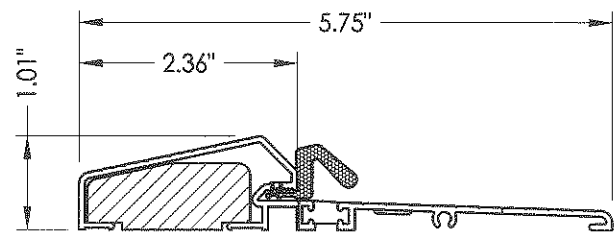

18 **OUTSWING THRESHOLD**
With thermal break sill

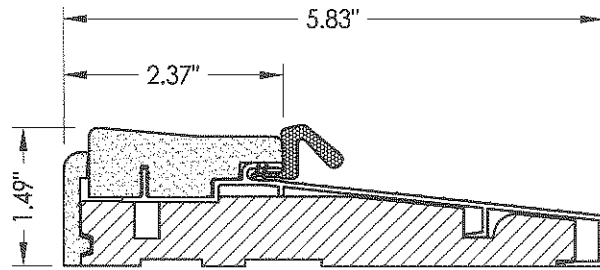

15 **OUTSWING THRESHOLD**
Composite sill
Full substrate

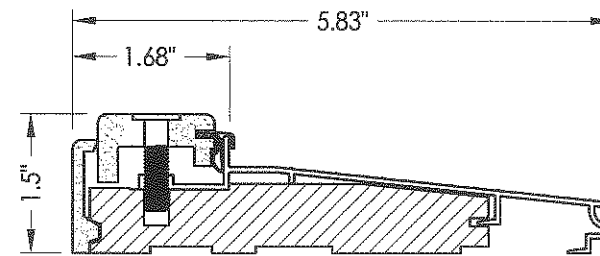

33 **INSWING THRESHOLD**
Adjustable with
Standard substrate

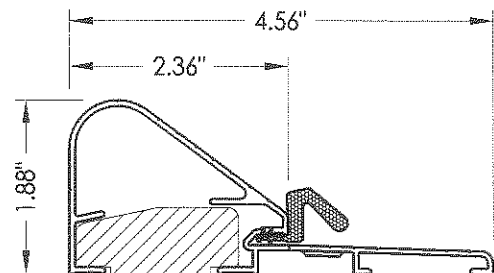

31 **OUTSWING THRESHOLD**
Coastal

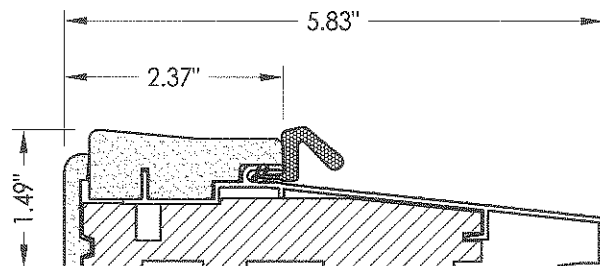

34 **OUTSWING THRESHOLD**
Hardwood sill
Standard substrate

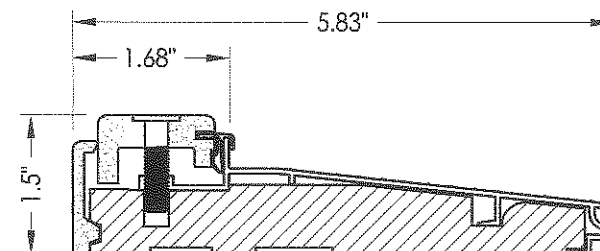

38 **INSWING THRESHOLD**
Adjustable with
Full substrate

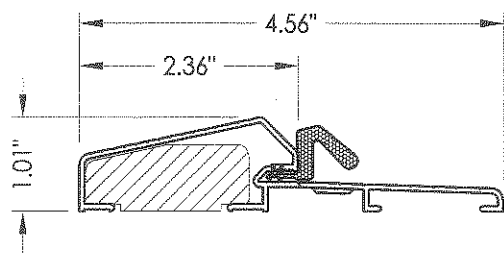

37 **OUTSWING THRESHOLD**

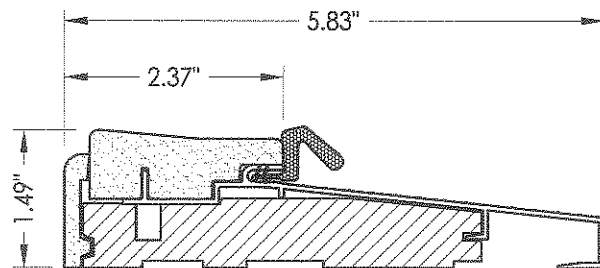

16 **OUTSWING THRESHOLD**
Composite sill
Standard substrate

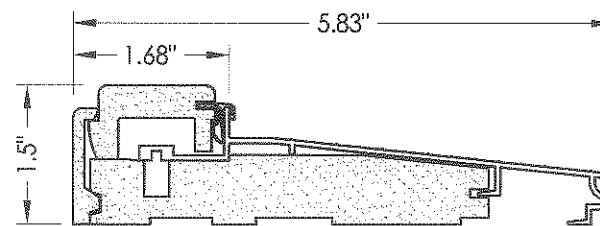

36 **INSWING THRESHOLD**
Fixed with
Standard substrate

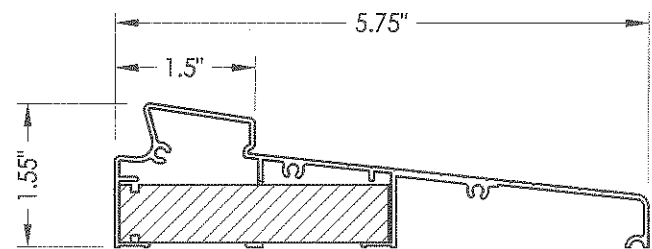

14 **OUTSWING THRESHOLD**
Self adjusting

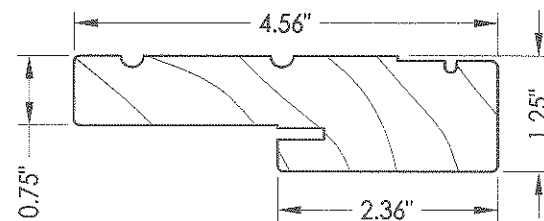

19 20 **HEAD & SIDE JAMB**

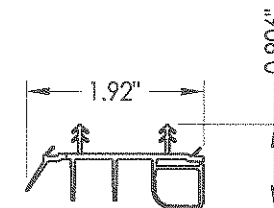

32 **SWEEP**

Documents Prepared By:
RW BUILDING CONSULTANTS, INC.
P.O. Box 230 Valrico FL 33595
Phone No.: 813.659.9197
Florida Board of Professional Engineers
Certificate of Authorization No. 9813
LF 3-16-11
Lyndon F. Schmidt, P.E. No. 43409

PRODUCT: THERMA TRU
FIBERGLASS GLAZED DOOR
PART OR ASSEMBLY:
COMPONENTS

NO.	DATE	REVISIONS
1	3/9/11	REVISE CLASSIC CRAFT DOOR
		JK
		BY

DATE: 6/25/08
SCALE: N.T.S.
DWG. BY: JK
CHK. BY: LFS
DRAWING NO.: FL-10975.1
SHEET 10 OF 11

